

USER MANUAL

Palace Jumping Castle (White or Pastel Pink)



LIFESPAN KIDS



Find the Digital
Manual Online

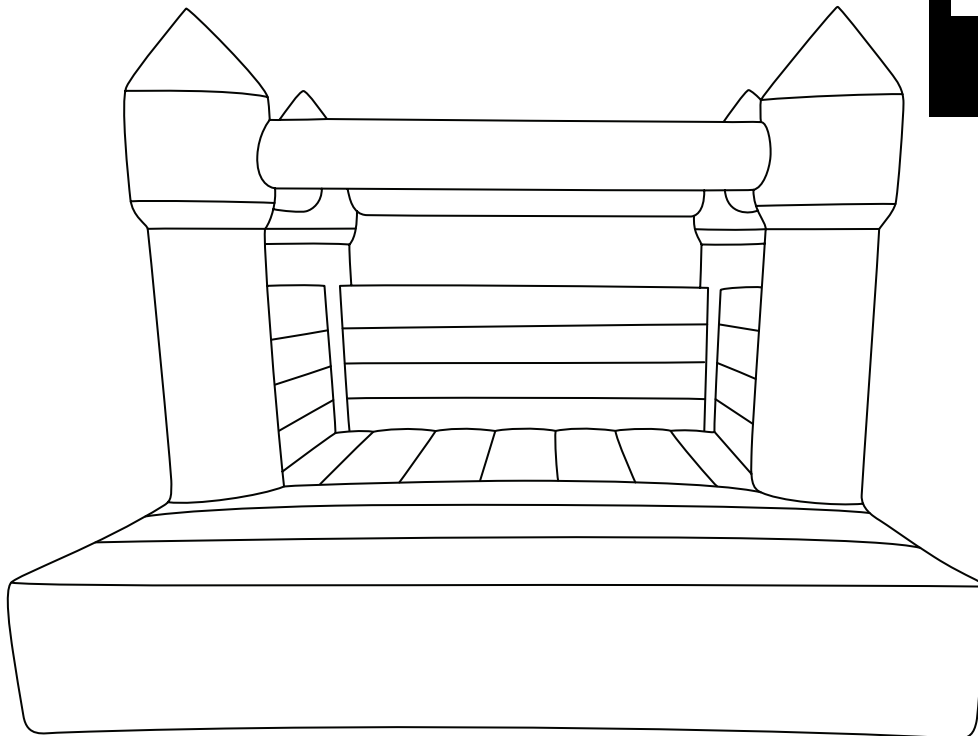

WARNING: Children have drowned in portable swimming pools. Ensure active adult supervision at all times. Do not leave children unsupervised in or around the pool – keep them within arm's reach. Empty and store safely after use.

IMPORTANT:

The owner's manual contains safety, assembly, use and maintenance instructions. This product must be assembled by an adult who has read and understood these instructions. Keep the packaging away from children and dispose of all packaging before use. Do not allow children to operate machine. Children to stay clear of air fan blower at all times. Please save these instruction for future use.

Recommended for ages between 3–10. For family domestic outdoor use only.

Only a competent adult must set up this product following the instruction provided. Do not allow children to operate the air fan blower at any time. Please save these instructions for future use.

NOTE:

This manual should not be used to guide your purchasing decision. Your product, and the contents inside its carton, may vary from what is listed in this manual. This manual may also be subject to updates or changes. Updated manuals are available through our website at www.lifespankids.com.au.

For the installer and your children's safety, it is important to fully read and understand the instructions and safety hazards before commencing the assembly of the product.

TABLE OF CONTENTS

I. GENERAL SAFETY INSTRUCTIONS	3
II. SET UP	6
III. MAINTENANCE INSTRUCTIONS	11
IV. REPAIR AND DISPOSAL INSTRUCTIONS	12
V. COMMON QUESTIONS	13
VI. WARRANTY	14

I. GENERAL SAFETY INSTRUCTIONS

Please read the following safety guidelines and warnings carefully.

Never leave your child unattended!
Please keep your children under adult supervision at all time!

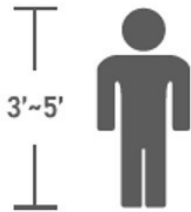

- For safety concern, the weight limit should be strictly observed; maximum weight of 45kg (99lbs) for individual.
- The height of player shall not exceed 5 feet (150cm)

USER RESTRICTIONS

- Suitable for children aged 3 to 8 years only.
- Not suitable for children under 3 years or for adult use.
- Adult supervision is required at all times.
- Check and follow all assembly, operation, and safety instructions.
- The product must be used only under adult supervision.
- Indoor and outdoor use is permitted based on product specifications and area size.
- Minor size deviations are normal.

SITE RESTRICTIONS FOR INSTALLATION AND USE

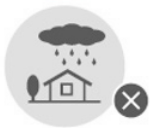

Do not use outdoors during rain or severe weather.



Do not use in wind speeds over 32 km/h (20 mph). Wind gusts can dislodge stakes and lift the inflatable.



Do not set up on slopes or uneven surfaces.



Do not install near pools, water sources, or puddles.



Do not place on hard surfaces (e.g. concrete or asphalt). Use an impact-absorbing pad or mat underneath for safety.

PRECAUTIONS FOR STAKES

- Stakes are for securing the inflatable on lawn surfaces.
- Use sufficient stakes and drive them vertically and firmly into the ground.
- Ensure the ground is firm and suitable for installation (check for soil, weather, and environment conditions).
- Clear debris and obstacles before inserting stakes.
- Use straps and stakes together for stability in case of wind or impact.
- Do not drive stakes at an angle. Push into dry and hard soil for best hold.
- Stakes should be flush with or beneath the ground to prevent tripping.

PRECAUTIONS FOR PLAY

- No head-first sliding. Always slide feet first to prevent injury.
- Strictly follow safety rules in all play zones (e.g. slides, climbing walls).
- Keep pets away from the inflatable and blower.
- Do not attach external items (e.g. jump ropes, pet leashes, cables) that can cause entanglement or suffocation.
- Ensure children remain within the designated play area under supervision.
- Keep entry and exit points clear at all times.
- Dress Code:
 - No headgear or loose clothing.
 - Remove all sharp or hard objects (e.g. jewellery, helmets, scarves).
 - No shoes.
- Separate children by age if there's a large gap to prevent injury.
- Do not climb or hang from support pillars or outer walls.
- Prohibited activities include pushing, wrestling, flips, roughhousing, etc.
- No food, drink, or chewing gum allowed while playing.

PRECAUTIONS FOR BLOWER USE

- **⚠ Electrocutation Hazard:** Do not use an extension cord. Plug directly into a suitable outlet.
- Blower use is not recommended for children under 12.
- Follow all blower safety guidelines and manuals carefully.
- Keep all electronics and cords away from the inflatable.
- Do not set up near or under power lines or electrical wires.
- Never immerse blower in water or wipe with wet cloth.
- Avoid running cords under rugs, carpets, or through tight spaces.
- Place cords away from foot traffic to avoid tripping.
- Keep away from fire and heat sources.
- Do not disconnect blower during use.
- Do not use in adverse weather.
- Inspect cords and plugs before every use. Do not use damaged parts.
- If defective, stop use immediately and contact a professional.
- Always unplug blower when not in use or during servicing.
- Use a solid-state speed control device only if required by specifications.

II. SET UP

PRODUCT INCLUDES:

⚠ **NOTE:** The product with water playing design comes with water pipe accessories, the products without water splashing function does not have.

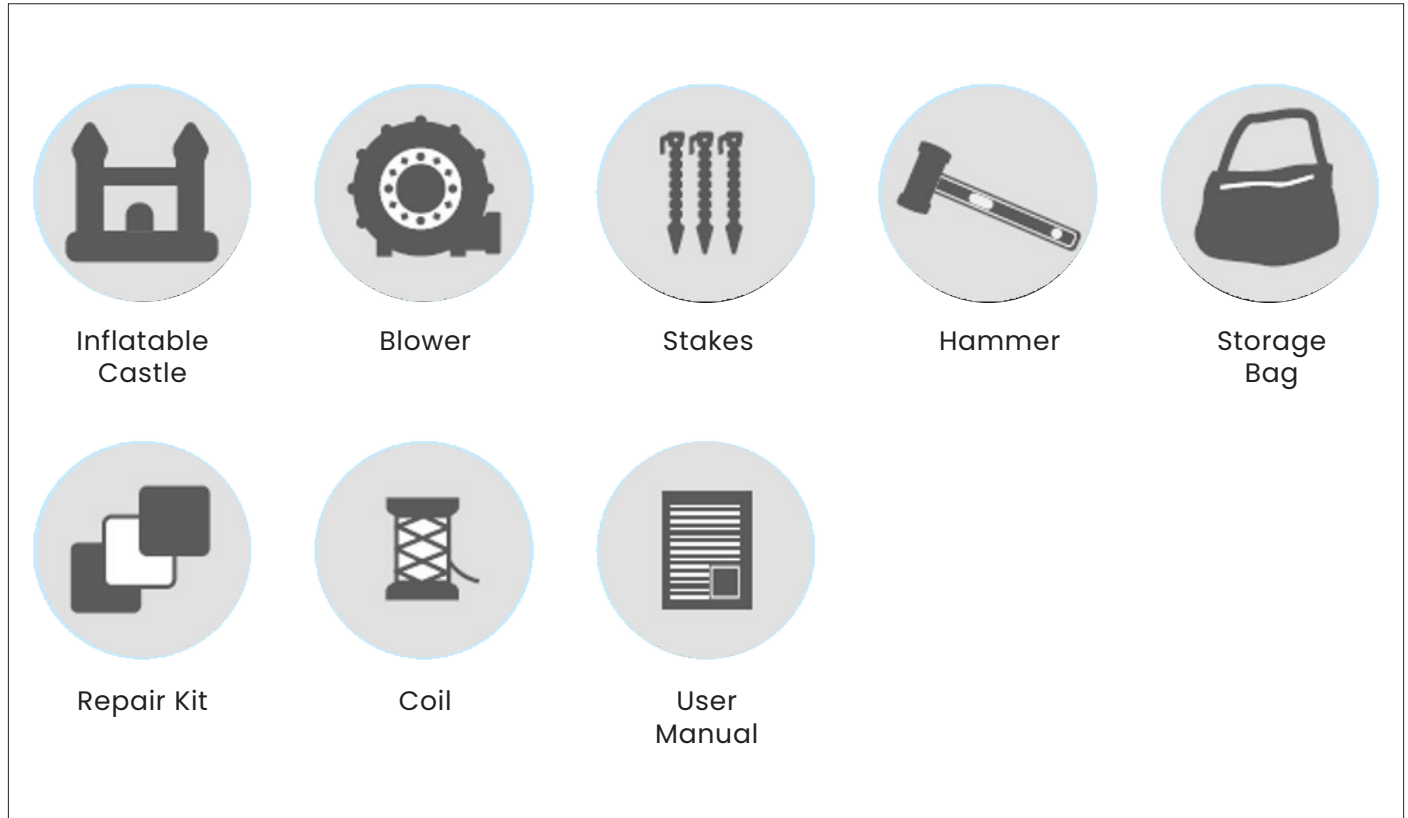

UNPACKING AND ADDITIONAL SETUP NOTES

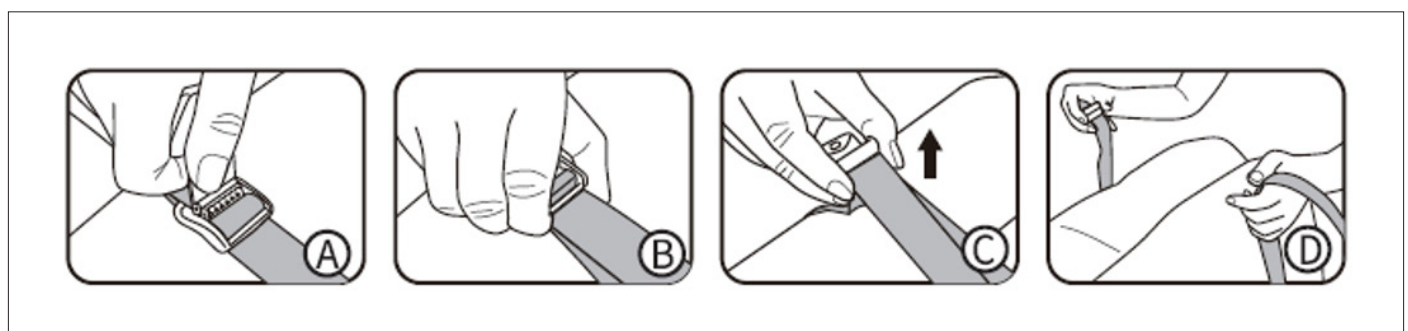

- Open the packaging and remove all components. Lay them flat on a smooth, level area of grass or dirt.
- Release any adjustable buckle straps as instructed (e.g. lift buckle tab, pull the strap, and remove).
- To protect the underside of the inflatable, place a tarp or protective mat beneath it.
- Position impact-absorbing cushions or EVA foam pads next to climbing areas and slide exits to reduce injury risk from falls.

- Ensure the site has at least 3 meters (10 feet) clearance from any nearby objects or structures, including:
 - Houses, garages, fences, clotheslines, trees, large rocks, electrical wires, or playground equipment.
- A 2-meter safety clearance must be maintained around the entire unit during use.

SETUP INSTRUCTIONS

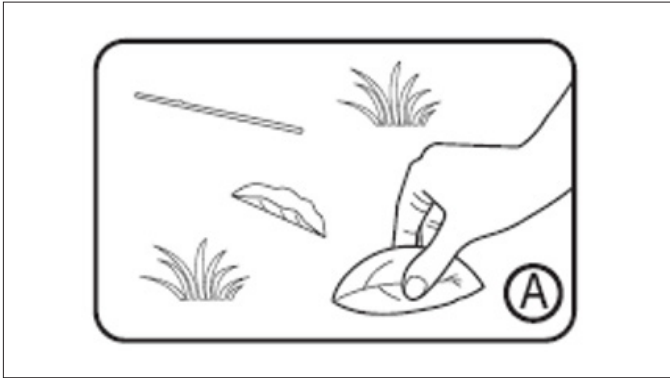

STEP A – GROUND PREPARATION

- Inspect and clear the ground area of rocks, sticks, glass, debris, or any sharp or hard objects.
- Choose a flat, soft surface (e.g. grass or level dirt).
- Maintain a clearance of at least 2 meters around the setup area.

Unfold the inflatable structure carefully in the cleared space.

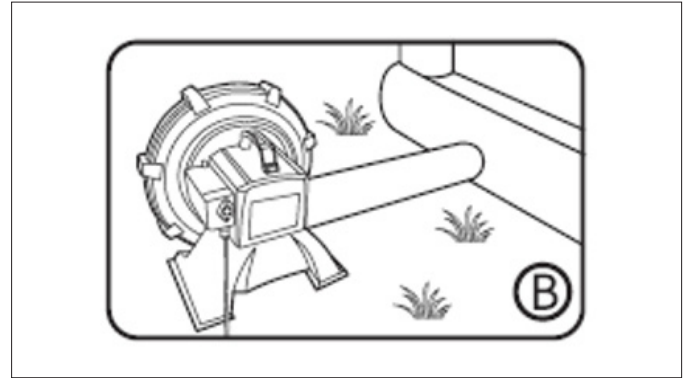

STEP B – BLOWER SETUP

- Place the electrical blower in a dry location, away from water sources.
- Stretch and attach the inflation tube securely to the blower nozzle. Ensure the tube is untwisted and smooth.
- Plug the blower into a power source matching the indicated voltage.
- Turn on the power switch – the inflatable will begin to inflate and expand quickly.
- The blower must remain on continuously while the inflatable is in use.

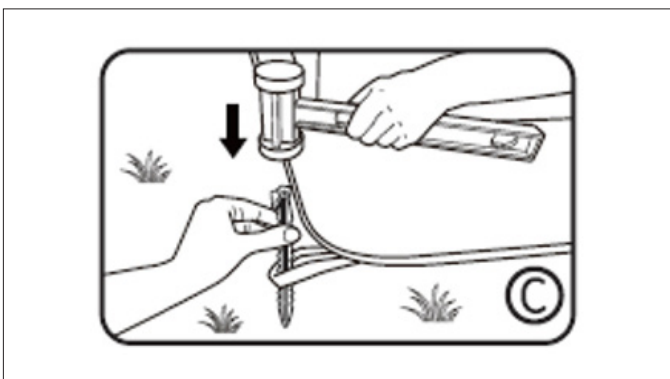

STEP C – STAKE INSTALLATION

- Use a rubber mallet to drive all provided ground stakes into the ground.
- Stakes must be driven perpendicularly and firmly to ensure the structure remains stable.
- This will minimize displacement and tripping hazards.
- Secure both the inflatable and blower using all stakes provided for your model.

DEFLATION INSTRUCTIONS

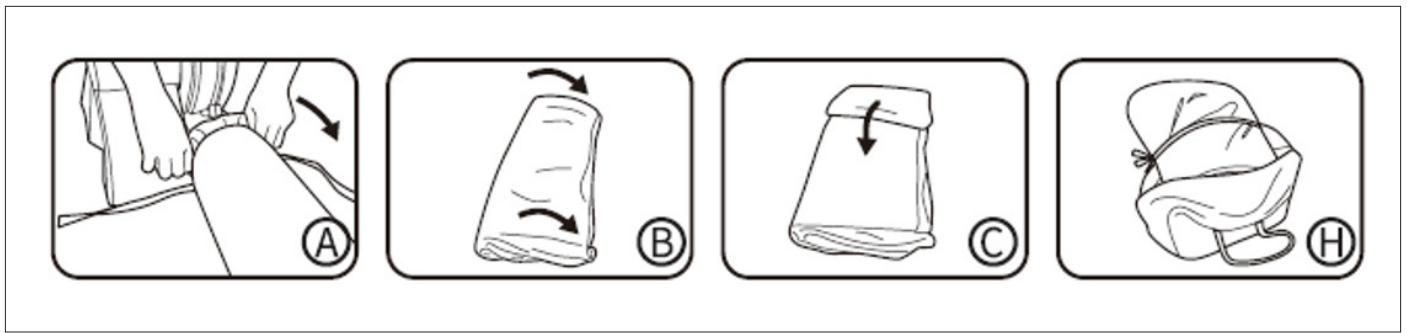

1. Ensure all children are out of the inflatable and the blower is turned off.
2. Turn off and unplug the blower. The inflatable will deflate rapidly.
3. Detach the inflation tube and lay it to the side (A).
4. Remove all ground stakes.

FOLDING AND STORAGE

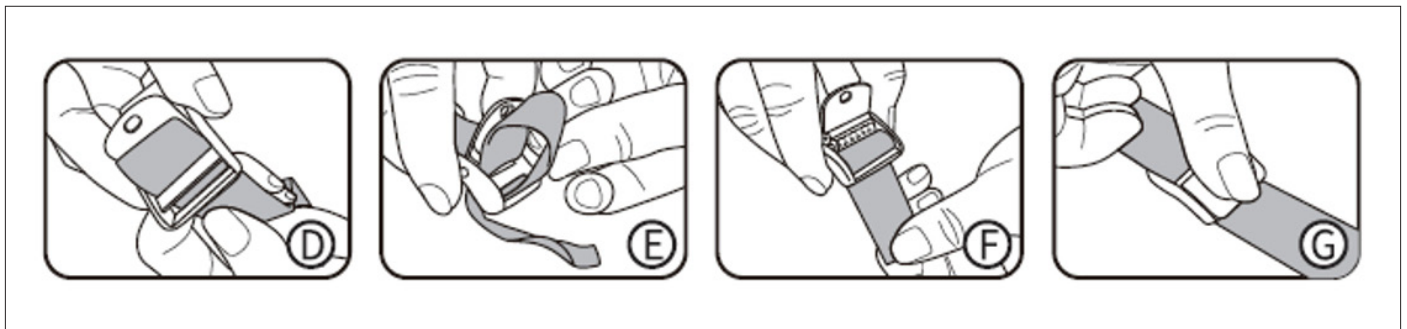

1. Fold the inflatable from the outer edges inward, pressing out as much air as possible to create a long rectangle (B).
2. Begin folding from the side opposite the inflation port, ensuring the surface is neatly folded (C).
3. Insert the adjustable buckle strap through the slot, pull tight, and secure the buckle (D-G).
4. Place the folded unit into the storage bag provided (H).

III. MAINTENANCE INSTRUCTIONS

- Perform regular inspections to avoid damage-related accidents.
- Ensure the inflatable is completely dry before storing to avoid mould or material degradation.
- Store in a dry indoor area.
- Check for holes, wear, and damage before and after each use. Do not use damaged inflatables.
- Inspect ground stakes regularly to ensure safe anchoring.
- Clean with a soft cloth and non-toxic, neutral cleaners. Avoid bleach, chlorine, and abrasive products.
- No food or drinks allowed on the inflatable or near the blower.

BLOWER MAINTENANCE

- Unplug the blower immediately after use.
- Inspect regularly for damage. Do not use if cords, plugs, or parts are compromised.
- Blower is equipped with overheat protection. If motor is overheated, the protector will trip to protect your safety. Turn off the blower and let it cool down.
- Blower does not require oil or internal maintenance.
- Do not operate outdoors in wet conditions.
- Do not immerse or wipe with a wet cloth. Clean only with a dry or wrung-out cloth.
- No chemical cleaners on the blower.
- Store blower indoors, away from children.
- Loosely coil the cord for storage.

IV. REPAIR AND DISPOSAL INSTRUCTIONS

⚠ ATTENTION: It is not recommended to repair the same damaged area more than twice.

METHOD 1: STITCHING

- For loosened stitches, sew carefully with a needle and thread. Use only on outer fabric – avoid piercing bottom or structural layers.
- Use your own sewing needle (3# sewing needle is suggested).• Loosely coil the cord for storage.

METHOD 2: PATCH REPAIR

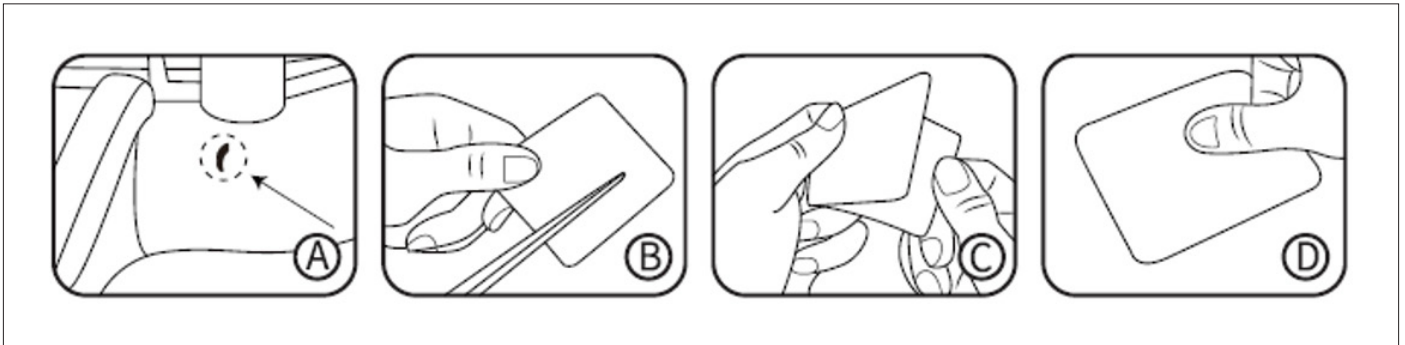

For small holes:

1. Clean and dry the damaged area (A).
2. Cut a patch to size (B).
3. Remove the adhesive backing and apply (C).
4. Press firmly and smooth out air bubbles (D).
5. Let cure for at least 30 minutes before reinflating.

NOTE: Repairs should only be attempted by adults. Do not repair the same spot more than twice.

DISPOSAL

- Dispose of in accordance with local electronic and inflatable disposal laws.
- Blower and batteries must be taken to specialized disposal centres.

V. COMMON QUESTIONS

What if there's air leakage at the seams?

- Minor leakage at pinholes or seams is normal to maintain air pressure and avoid over-inflation.

Are pinholes a defect?

- Pinholes (<6mm) may occur during manufacturing (for positioning the stitches) and do not affect function.

Should I turn off the blower after inflation?

- No – the blower must remain on during use, or the inflatable will collapse.

How do I store a water-play inflatable?

- Drain and dry completely at an angle to release trapped water.
- Store in a dry and ventilated space.

Why are there bubbles when water is used?

- Bubbles from the bottom or seams are normal due to pinholes from stitching. Products are tested and safe to use.

VI. WARRANTY

AUSTRALIAN CONSUMER LAW

Many of our products come with a guarantee or warranty from the manufacturer. In addition, they come with guarantees that cannot be excluded under the Australian Consumer Law. You are entitled to a replacement or refund for a major failure and compensation for any other reasonably foreseeable loss or damage.

You are entitled to have the goods repaired or replaced if the goods fail to be of acceptable quality and the failure does not amount to a major failure. Full details of your consumer rights may be found at www.consumerlaw.gov.au.

Please visit our website to view our full warranty terms and conditions:

www.lifespankids.com.au/Warranty-Policy-Kids

WARRANTY AND SUPPORT

Please email us at support@lifespankids.com.au for all warranty or support issues.

For all warranty or support related enquiries, please lodge a support ticket first by sending us an email. support@lifespankids.com.au.



www.lifespankids.com.au