



# Slippery Slide Instructions

Item PE03



## **WARNING**

The product must be assembled by an adult .  
Children must not use the product until properly installed.

## **WARNING!**

Not suitable for children  
under 3 years.  
Small parts.Choking hazard.

# Read Me

Please read these instructions carefully. The instructions are an integral component of the product. Therefore, please store them and the packaging carefully in case questions arise in the future. Please always include these instructions when handing on the product to a third party. This product must be assembled by an adult. This product is not designed for industrial use. The use of the product requires certain capabilities and skills. Always adjust according to the age of the user and use for the purpose it has been designed for.

## Warnings

- Observing the following statements and warnings reduce the likelihood of serious or fatal injury
- Always follow the safety warnings and use common sense when using the product.
- To prevent serious injury, do not allow children to play on the product until it is completely assembled and installed.
- Instruct children not to use the equipment in any manner other than intended.
- Instruct children to dress appropriately. Loose fitting clothing is potentially hazardous when using the product.
- Never slide head first down the slide.
- Changes to the original product must only be carried out according to manufacturer specifications.
- Equipment may be slippery when wet. Do not allow children to use the equipment when wet.
- Ensure a safe distance from other structures or obstructions of at least 2 meters and for a level, shock-absorbing underground (e.g. grass) free from sharp or pointed objects, obstacles (e.g. clotheslines etc.), gradients, steps, stairs or hard surfaces (e.g. concrete etc.).

- Adult supervision of children is required at all times when on or around this product. Never leave children unattended. Parents should regularly check openings and surfaces that may be hazardous.
- This product is designed for normal residential use only. This product is not designed for use in day care, nurseries or other public places. This product is to be assembled by adults only in the manner described within this owner's manual. This product must be anchored. Anchors are included with the product.

## Assembly

Follow the steps shown in the pictures. The product should initially only be screwed finger-tight to ensure that it does not warp and to facilitate the assembly. Only when all parts are assembled, should they be firmly tightened and checked.

Please take note of sharp-edged holes and chips that under circumstances may occur by the manufacture of this game device and if necessary have these removed. These products should be assembled by adults.

1. Do not install home playground equipment over concrete, asphalt, packed earth, grass, carpet, or any other hard surface. A fall on to a hard surface can result in serious injury to the user.
2. Do not place your product underneath electrical lines. If you must ensure that there is a minimum overhead clearance of 2m.

# Hardware And Parts

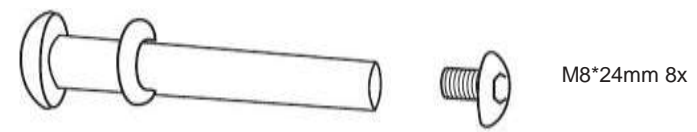
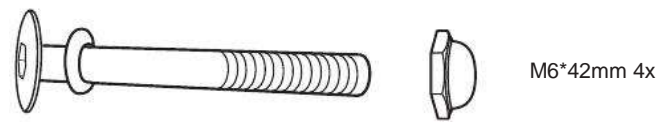
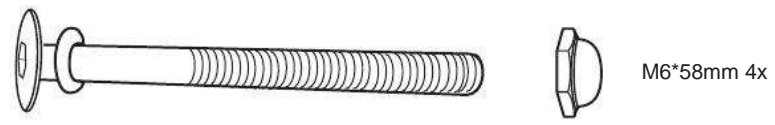

Support tube for leg 2x

Support cross bar for leg 1x

Support cross bar for leg 2x

Anchor 4x

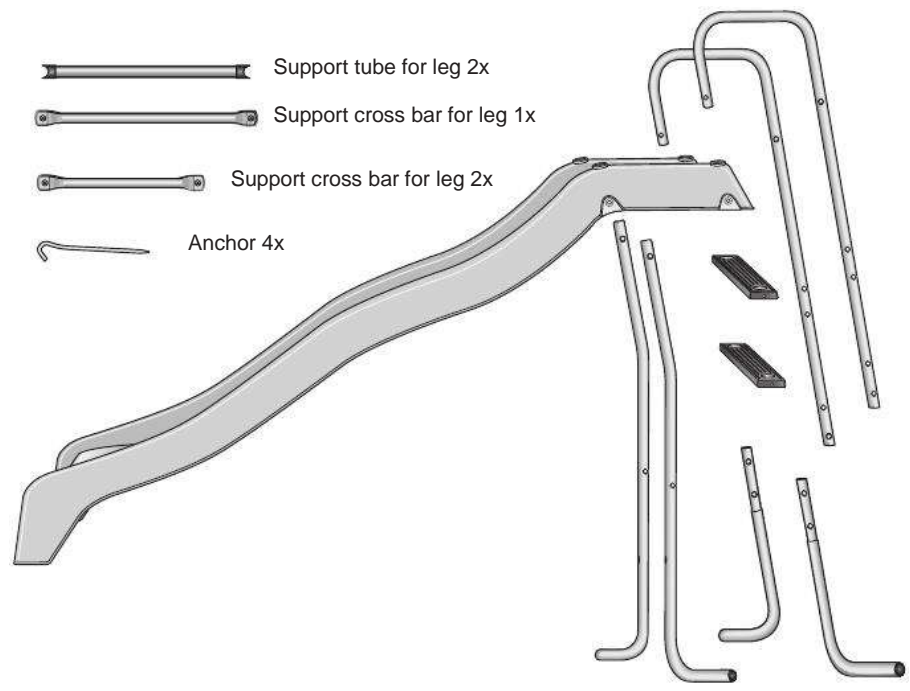

# Assembly

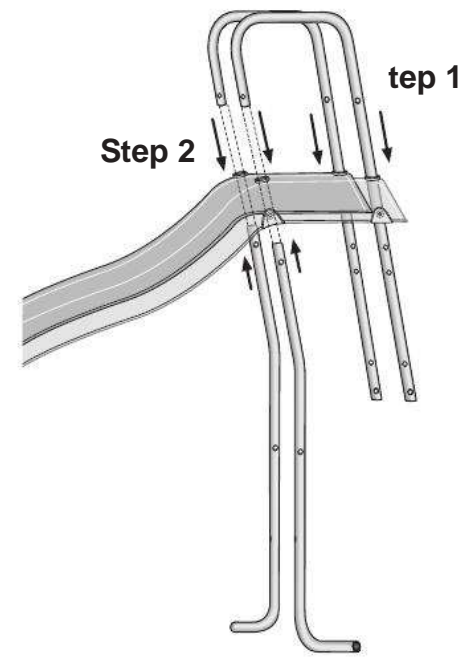

## Step 3

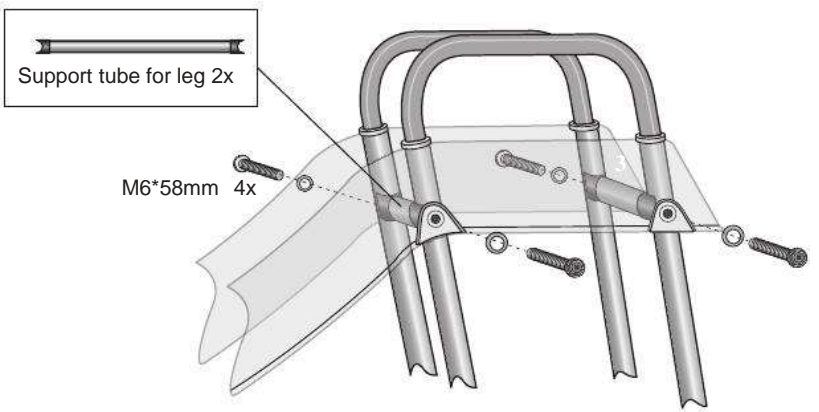

# Assembly

## Step 4

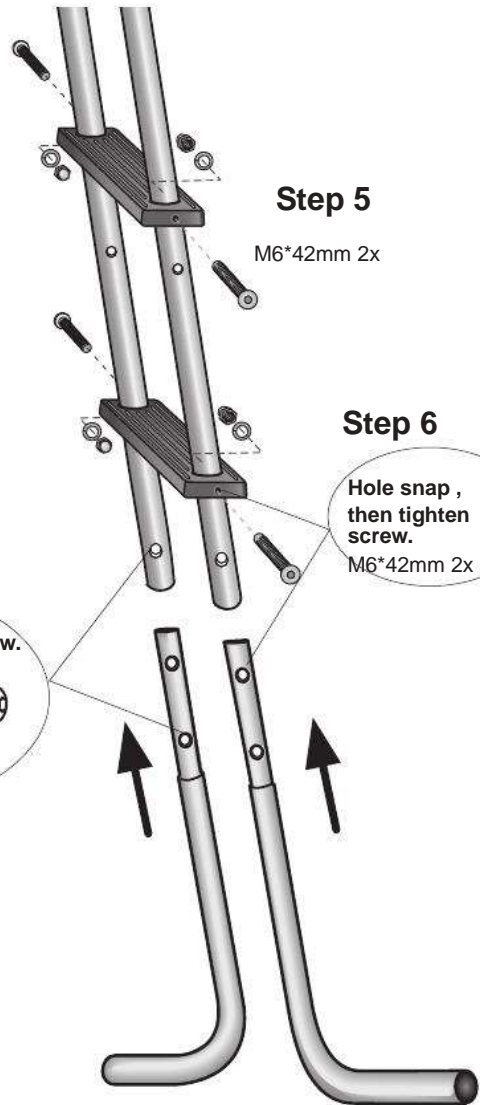

### Step 5

M6\*42mm 2x

### Step 6

Hole snap ,  
then tighten  
screw.

M6\*42mm 2x

### Step 7

Hole snap ,  
then tighten  
screw.



M8\*24mm 2x

## Step 8

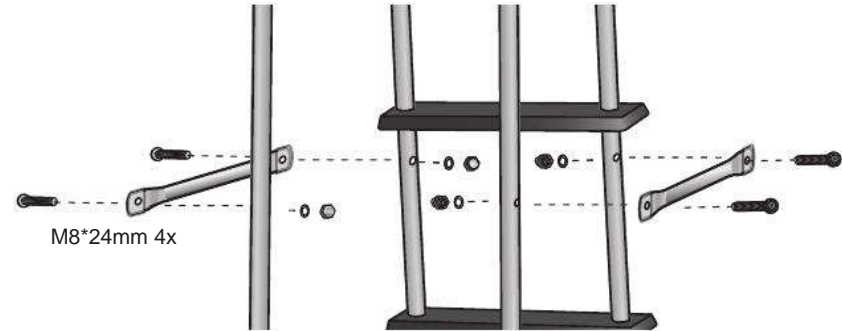

M8\*24mm 4x

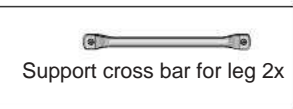

## Step 9

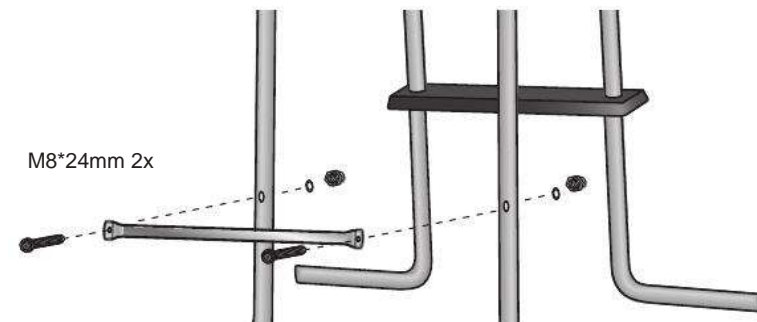

M8\*24mm 2x



# Assembly

## Step 10

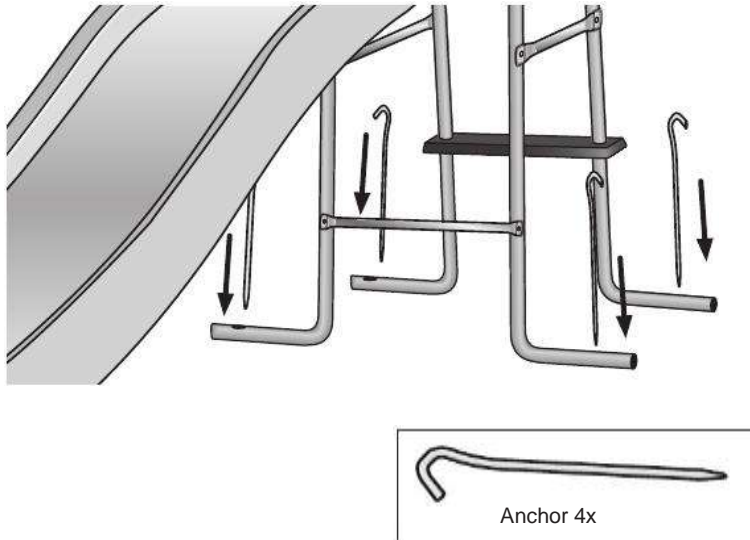

# Care and Maintenance

1. Tighten all hardware.
2. Lubricate all metallic moving part
3. Check all protective coverings on bolts, pipes, edges and corners. Replace if they are loose, cracked or missing.
4. Check metal parts for rust. If found, sand and repaint using a non lead-based paint.
5. Rake and check depth of all loose fill protective surfacing material to prevent compaction and to maintain appropriate depth. Replace as necessary.

# Warranty

## AUSTRALIAN CONSUMER LAW

Many of our products come with a guarantee or warranty from the manufacturer. In addition, they come with guarantees that cannot be excluded under the Australian Consumer Law. You are entitled to a replacement or refund for a major failure and compensation for any other reasonably foreseeable loss or damage.

You are entitled to have the goods repaired or replaced if the goods fail to be of acceptable quality and the failure does not amount to a major failure. Full details of your consumer rights may be found at [www.consumerlaw.gov.au](http://www.consumerlaw.gov.au)

Please visit our website to view our full warranty terms and conditions:

<http://www.lifespanonline.com.au/Warranty-Policy>

# Contact Us

Please visit our website at: [www.lifespanonline.com.au](http://www.lifespanonline.com.au)

Email us at: [info@lifespanfitness.com.au](mailto:info@lifespanfitness.com.au)