

# TUCSON PLAYCENTRE

## BOOKLET INCLUDES:

- Owner's Manual
- Frequently Asked Questions
- Assembly Instructions
- Warranty Information

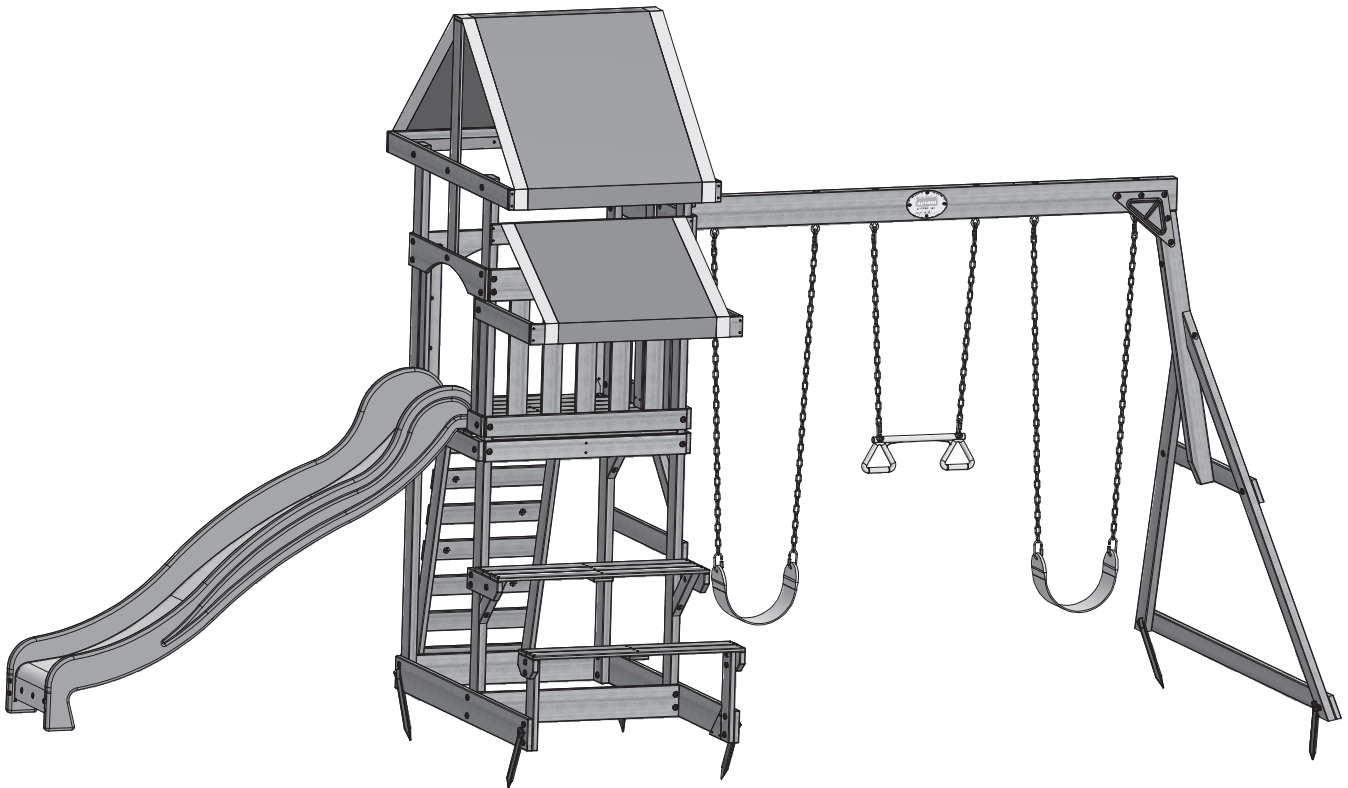

Save this assembly manual for future reference in the event that you need to order replacement parts.



Free BILT Intelligent Instructions®  
Download on <https://biltapp.com/>  
Available on Apple and Google Play

# GENERAL SAFETY INSTRUCTIONS

## PURPOSE

This product is intended for outdoor, domestic use only. It is not suitable for commercial or medical use.

## DANGER FOR CHILDREN

- **WARNING! No eating while using the product**
- This product may only be used with adult supervision at all times.
- The packaging material is not suitable for children due to choking and suffocation hazards.

## RISK OF INJURIES

- Do not use the product if it is damaged or defective. If it is damaged or defective, please contact a qualified technician.
- Check the product before each use. Defective parts must be changed immediately as they can impair the function and the safety of the product.
- No more than one person per swing or per attachment.
- Use the product only on even and non-slipping surfaces. Never use it near water and keep sufficient space around for safety.

## PRODUCT DAMAGE

- Do not make alterations to the product. Only use original spare parts. Qualified technicians should only carry out repairs – improper repairs can lead to danger for the user. Use this product only as described in this manual.
- Protect the product against splashes, humidity, high temperature and direct sunlight.

## ASSEMBLY ADVICE

- The assembly of the product must be done carefully and by an able-bodied adult. If in any doubt, ask a technically qualified person.
- Before you start with the assembly, read the instructions carefully.
- Remove all packaging materials and lay down all parts on an open space. This gives you an overview and simplifies the assembly procedure.
- Check with the parts list that all parts are available. Dispose of the packaging material when the assembly is completed.
- Beware that when using tools or doing technical work, there is always a risk of injuries. Assemble the product with care.
- Create a danger free environment; for example, do not let tools lay around the workspace. Store the packaging material in a way that cannot cause any danger.
- After installing the product according to the instruction manual, ensure all screws, bolts and nuts are correctly installed and tightened and that all joints are secure.
- Reasonable space must be kept between the product and possible sources of danger, such as other equipment swimming pools and fences.
- The product must be assembled correctly before use.
- Place the product on a level surface at least 2 m from any structure or obstruction such as a fence, garage or house.
- No modifications are to be made to the original product.
- The product must always be used in a well-lit area.
- Do not place anything under the product.
- Use gloves during assembly and disassembly.
- Outdoor products should be equipped with a device that in strong wind conditions avoid displacement due to wind (e.g. steel bars in the ground or loads like sand bag or water bags).

- In certain areas during winter, snow buildup and the low temperatures can damage the product. It is recommended to remove snow buildup and to store the product indoor.
- We strongly recommend visual inspections every 3 months to insure the integrity of the entire product. Replace any parts as necessary.

## **SAFETY INSTRUCTIONS**

- The safety instructions of the product should always be considered and obeyed.
- Using the product may result in permanent injury such as paralysis, or even death. Falling off the product may lead to injuries, particularly to the back, neck or head.
- No clothes with hooks or lose parts should be worn or carried during product usage in order to avoid hooks getting caught and causing injury.
- Moving the product whilst assembled may affect the integrity of the frame. Should it be necessary to move the product, please consider the following:
  - 1.) Force to be evenly spaced around the frame to lift the product off the ground
  - 2.) The product must be carried horizontally
  - 3.) Use caution whilst moving as it could bend the product frame.
- Users should be familiar with the assembly manual. This manual contains assembly guidance; selected precautionary measures as well as recommendations for servicing and maintenance of the product, in order to ensure safe and fun usage.
- It is the responsibility of the owner or the supervisor to guarantee that all users of the product are informed sufficiently of all warning references and safety instructions.

### For the supervisor:

The supervisor's role is to make sure users are aware of all safety precautions and that these precautions are enforced. When a supervisor is not available, the product may be disassembled or covered to limit access.

- The product can be only used if it is in good condition, worn or damaged parts should be replaced.
- Objects, which could be dangerous to the user, should be away from the product
- Avoid unauthorized and unsupervised use of the product.
- Do not use the product under influence of alcohol or drugs (incl. medicines).
- Do not use the product or its attachments as a jumping platform.

## Consumer Information Sheet for Playground Surfacing Materials

The US Consumer Product Safety Commission (CPSC) estimates that about 100 000 playground equipment-related injuries resulting from falls to the ground surface are treated annually in US hospital emergency rooms. Injuries involving this hazard pattern tend to be among the most serious of all playground injuries, and have the potential to be fatal, particularly when the injury is to the head. The surface under and around playground equipment can be a major factor in determining the injury-causing potential of a fall. It is self-evident that a fall on to a shock-absorbing surface is less likely to cause a serious injury than a fall onto a hard surface. Playground equipment should never be placed on hard surfaces, such as concrete or asphalt, and while grass may appear to be acceptable, it may quickly turn to hard-packed earth in areas of high traffic. Shredded bark mulch, wood chips, fine sand or the gravel are considered to be acceptable shock absorbing surfaces when installed and maintained at a sufficient depth under and around playground equipment.

Table B.1 lists the maximum height from which a child would not be expected to sustain a life-threatening head injury in a fall on to four different loose-fill surfacing materials if they are installed and maintained at depths of 150 mm, 225 mm and 300 mm.

**Table B.1: Fall height in millimetres from which a life-threatening head injury would not be expected**

Type of Material	Depth of surfacing material		
	150mm	225mm	300mm
Double Shredded Bark Mulch	1800	3000	3300
Wood Chips	1800	2100	3600
Fine Sand	1500	1500	2700
Fine Gravel	1800	2100	3000

However, it should be recognised that all injuries due to falls cannot be prevented, no matter what surfacing material is used.

It is recommended that a shock absorbing material extend a minimum of 1 800 mm in all directions from the perimeter of stationary equipment such as climbing frames and slides. However, because children may deliberately jump from a moving swing, the shock absorbing material should extend in the front and rear of a swing a minimum distance of twice the height of the pivot point measured from a point directly beneath the pivot on the supporting structure.

This information is intended to assist in comparing the relative shock-absorbing properties of various materials. No particular material is recommended over another. However, each material is only effective when properly maintained. Materials should be checked periodically and replenished to maintain correct depth as determined necessary for the equipment in question. The choice of a material depends on the type and height of the playground equipment, the availability of the material in a particular area, and its cost.



# WOOD ADVICE

Our products are manufactured from premium timber. Great care is taken in selecting, machining and treating the timber before it is sold to you.

1. Inspect wood parts monthly. The grain of the wood sometimes will lift in dry periods causing splinters to appear. Light sanding may be necessary to maintain a safe environment. Treating your Product with protection (sealant) after sanding will help prevent severe checking/splitting and other weather damage.
2. We have applied a waterborne translucent stain to your unit. This is done for colour only. Once or twice a year, depending on your climate conditions, you must apply some type of protection (sealant) to the wood of your unit. Prior to the application of sealant, lightly sand any "rough" spots on your set. Please note this is a requirement of your warranty.

Bear in mind that timber is a natural product and may experience changes throughout the course of its life.

It may:

- Develop openings/checks (gaps, slits, apertures, cracks) along the line of the grain.
- Fade as the timber reacts with sunlight.

All woods are hygroscopic, that is, it will absorb or discharge moisture to attain equilibrium with the surrounding atmosphere. Timber openings/checks occur due to the moisture content between internal and outer surfaces of the timber. No two pieces of wood are exactly alike. Each piece has its own characteristics and personality and reacts differently to climate changes. When any wood products are exposed to the elements, it develops 'wood checks'. A check is the radial separation of the wood fibres running with the grain of the wood. These are caused by the varying temperature and moisture conditions. A check does not affect the strength or durability of the wood or structural integrity of the play set.

## When should wood cracks be a concern?

Most of the wood splits will never become large enough to affect the reliability and strength of our products, however, there can be rare cases where splits can occur. This happens when a crack develops past the halfway point from the timber, splitting it into two separate pieces.

Feel free to contact us with detailed pictures of your product so we can assess and ensure that your playground remains safe.

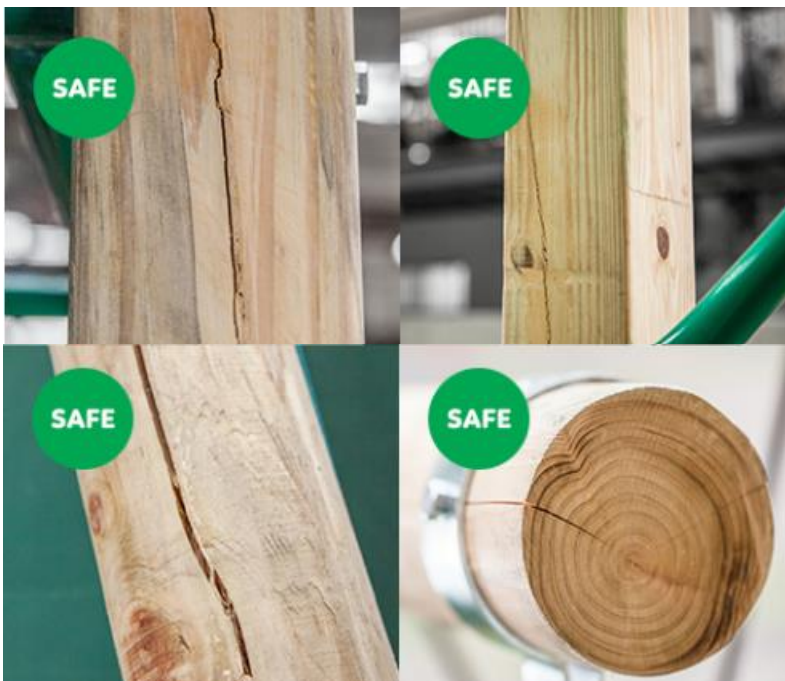

Dimensional timbers contain very little heart wood so less splits can be seen.

Round pole swing sets are very thick so that cracks (shown left) will not affect the strength and durability of our swing sets.

## RECOMMENDATIONS:

- The swing frame must be securely attached.
- For safety reasons, the cement cubes must be poured 5cm below ground level, at the frame's outer angles.

- The swing frame must not be installed directly on cement, asphalt, or any other hard surface.
- Your swing frame must be attached on a flat horizontal surface with a minimum of 2m between it and any structure or obstacle such as a fence, garage house, tree branches, cloths lines, or electric cables.

*For more information: <http://www.lifespankids.com.au/natural-timber>*

## **Play Set Assembly Manual FAQs:**

1. Does the area for the playset need to be level?

Yes. We recommend the playset be positioned on a flat level area for maximum safety and durability. The stakes provided should be used to secure it firmly to the ground.

2. What age range is appropriate for the playsets?

The playsets are recommended for children ages 3 – 10 years.

3. Is the wood treated with chemicals?

We use 100% Chinese Cedar wood which is naturally bug resistant, decay and rot resistant. To help ensure your child's safety, our wood is completely chemical free and we do not use pressure-treated wood. The stain we use is a top coat using a water-based product that is for appearance only.

4. How often should the playset be stained?

We recommend the playset be stained once each year. A water or oil based stain can be used at the customer's discretion.

5. Why does it seem that my swing set is developing cracks?

Wood is a natural material; no two pieces are exactly alike. Each piece has its own characteristics and personality and reacts differently to climate changes. When any wood product is exposed to the elements, it develops "wood checks". A check is the radial separation of the wood fibers running with the grain of the wood. These are caused by the varying temperature and moisture conditions. A check is not a crack – it does not affect the strength or durability of the wood or structural integrity of the play set.

6. Do the playsets come with a warranty?

Yes. All Lifespan Kids products carry replacement warranty on all parts for manufacturer's defect. Please see warranty details for more information.

7. What is the best way to get started assembling the playset?

We recommend taking all the parts out of the boxes and arranging them by part number before you begin any assembly. This will not only allow faster assembly, but will also identify any parts that may be missing or damaged so they can be replaced before assembly.

8. The playset seems to rock or sway too much. What's wrong?

Rocking is caused by uneven ground or obstructions such as rocks, roots, etc. under the ground rails. These should be removed and the ground underneath re-leveled to prevent rocking. Also ensure the playset is securely staked to the ground using the anchors provided.

9. The 2"x4" boards do not measure 2"x 4". Why not?

In it is common practice to describe lumber dimensions using the rough cut sizes from the sawmill and not the finished dimensions. Retailers, home stores, etc. all use this accepted practice for describing lumber dimensions. However, the playset is designed and constructed using the actual dimensions so everything fits properly and remains so during the life of the playset.

10. The end beam is not straight up and down. Why not?

This is normal. Backyard Discovery designs playsets this way to ensure the strongest structure possible. The slight angle adds strength and reduces rocking and twisting.

11. The S-hooks for the swings won't close. What is wrong?

We recommend placing them on a hard surface such as concrete (don't do this on anything that will dent such as metal or finished wood or glass which will break!). It will take quite a few strokes, but the hooks will close.

# *Tools Required for Installation:*

*(These are the tools that are generally required for assembly of our outdoor products.*

*These tools are not included with the outdoor product purchase.)*

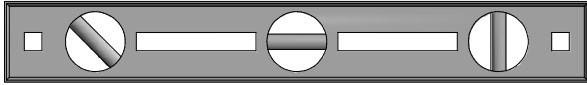

***(Level 24")***

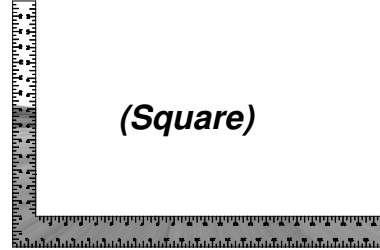

***(Square)***

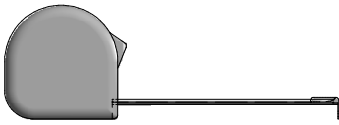

***(Tape Measure)***



***(Rubber Mallet - Optional)***



***(Claw Hammer)***

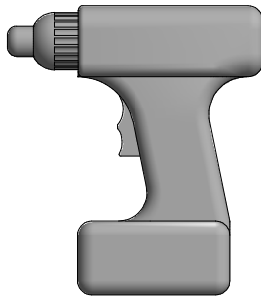

***(Cordless Drill or Electric Drill)***

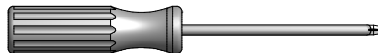
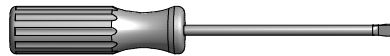

***(Phillips & Straight Blade Screw Drivers)***



***(Ladder)***



***(An Adult w/ an Adult Helper)***



***(Drill Attachments: Phillips Head & Socket Driver)***

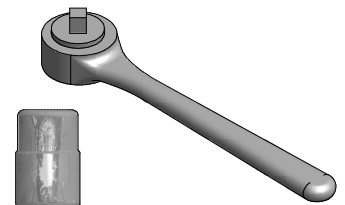

***(3/8" Drive Ratchet, 1/2" STD Sockets 1/2" Deep Sockets)***

# Basic Setup Dimensions

Place the set on level ground, not less than 6 ft [2 m] from any structure or obstruction such as a fence, garage, house, overhanging branches, laundry lines, or electrical wires.

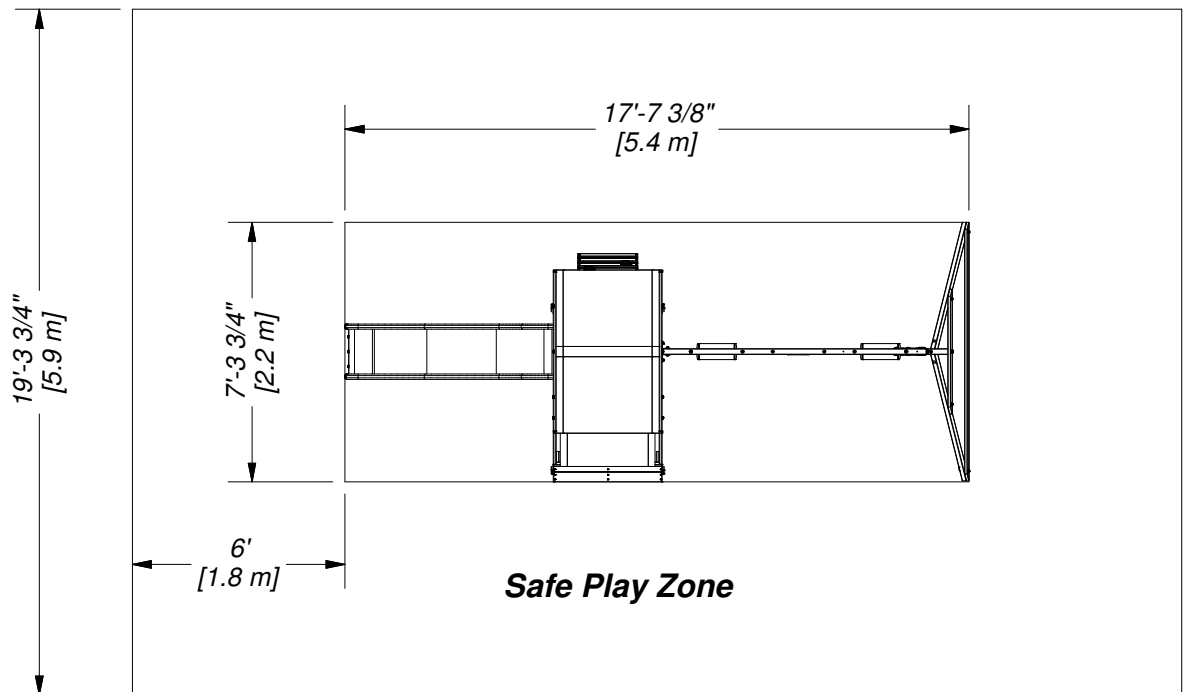

## **General Information:**

Your set has been designed and engineered for children only and for residential use only.

A maximum of 150 lbs. per child is recommended for play activities designed for individual use.

A maximum of 120 lbs. per child is recommended for play activities designed for multiple child use.

A maximum of 7 children is recommended for this swing set.

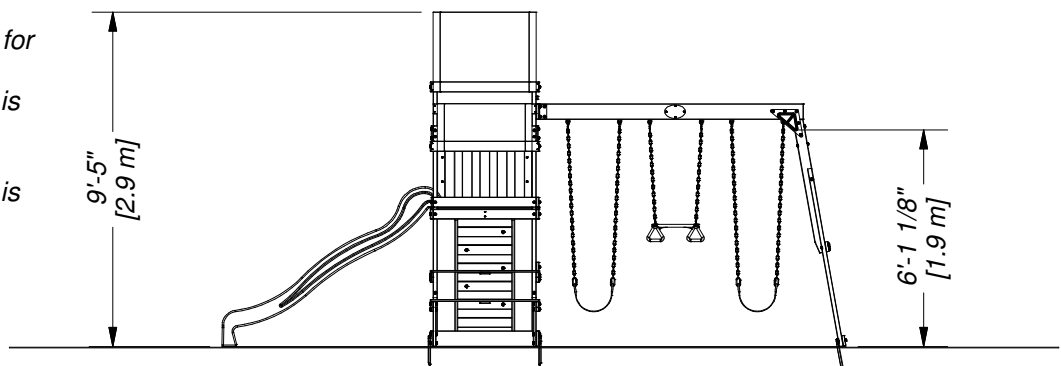

## **Important Assembly Notes:**

Safe play height: 15'-5" [4.7 m]  
Maximum fall height: 6'-4 1/2" [1.9 m]

- 1) While assembling unit, take time before and after each phase to make sure fort is level. If fort is not level, assembly will be difficult and improper assembly may result. Extra care must be taken to insure the fort is square.
- 2) Tighten bolts securely, tighten nuts on bolts flush to the tube or member, and place caps over exposed bolts snug to the nut.
- 3) Pay close attention to the **ITEMS NEEDED FOR EACH PHASE**. They can be a valuable aid when sorting your wood and hardware. Assembly will be made easier if items are sorted by phase.
- 4) Pay close attention to make sure you are using the correct hardware in the correct phases. Using incorrect hardware may result in improper assembly.
- 5) Whenever a T-nut is used, follow these directions. Place T-nut in pre-drilled hole. Tap in with hammer. Place bolt with washers in the opposite side. Hand tighten to make sure the bolt is in the T-nut. **DO NOT** over tighten.
- 6) Read the steps of each phase thoroughly. The written steps may include important information not shown in the illustrations.

# Parts Identification

## Wood Components

(NOT TO SCALE)



- (2) **E1 - FORT UPRIGHT - W101519**  
1 3/8"x3 3/8"x89 1/2" (36x86x2273)



- (2) **E2 - FORT UPRIGHT - W101520**  
1 3/8"x3 3/8"x89 1/2" (36x86x2273)



- (2) **E77 - ANGLE BRACE - W100991**  
1 3/8"x3 3/8"x74 3/8" (36x86x1890)



- (2) **F1 - ANGLE BRACE - W101630**  
1 3/8"x2 3/8"x18 1/8" (36x60x460)



- (2) **F2 - ANGLE BRACE - W101629**  
1 3/8"x2 3/8"x12 1/4" (36x60x310)

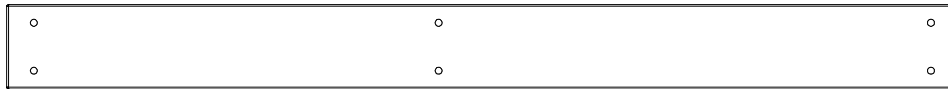

- (2) **G1 - GROUND BOARD - W101529**  
1"x5 1/4"x59 1/2" (24x134x1511)

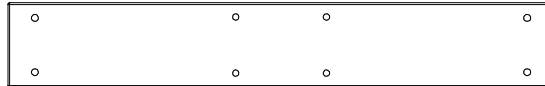

- (1) **G2 - SWING BEAM SUPPORT - W101623**  
1"x5 1/4"x34 1/8" (24x134x868)



- (2) **G3 - PICNIC SUPPORT - W101627**  
1"x5 1/4"x5 1/4" (24x134x134)

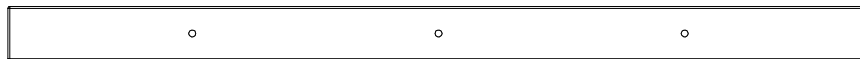

- (2) **H1 - ROOF CROSS BRACE - W101538**  
1"x3 3/8"x53 7/8" (24x86x1368)



- (4) **H2 - FLOOR JOIST - W101521**  
1"x3 3/8"x34 1/8" (24x86x868)



- (1) **H4 - FLOOR BRACE - W101631**  
1"x3 3/8"x34 1/8" (24x86x868)

# Parts Identification

## Wood Components

(NOT TO SCALE)



- (2) **H5 - PICNIC TARP SUPPORT - W101542**  
1"x3 3/8"x24 1/2" (24x86x622)



- (2) **H6 - WALL SLAT - W101535**  
1"x3 3/8"x25 1/2" (24x86x648)



- (2) **H7 - PICNIC SUPPORT - W101625**  
1"x3 3/8"x15 1/4" (24x86x387)

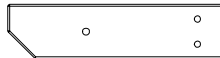

- (2) **H8 - PICNIC SUPPORT - W101628**  
1"x3 3/8"x13 1/2" (24x86x344)



- (2) **H9 - PICNIC SUPPORT - W101626**  
1"x3 3/8"x6 3/4" (24x86x172)



- (4) **H10 - FLOOR BRACE - W101534**  
1"x3 3/8"x3 3/8" (24x86x86)



- (2) **H73 - ROCK WALL RAIL - W100024**  
1"x3 3/8"x48 3/4" (24x86x1238)



- (1) **H79 - END SUPPORT - W100992**  
1"x3 1/2"x42" (24x86x1072)



- (1) **H80 - GROUND BOARD - W100990**  
1"x3 3/8"x87 3/8" (24x86x2218)



- (2) **J1 - WALL SLAT - W101622**  
1"x2 3/8"x25 1/2" (24x60x648)



- (3) **K1 - WALL RAIL - W101528**  
5/8"x5 1/4"x34 7/8" (16x134x887)

# Parts Identification

## Wood Components

(NOT TO SCALE)



(1) **K2 - ARCHED WALL RAIL - W101531**  
5/8"x5 1/4"x34 7/8" (16x134x887)

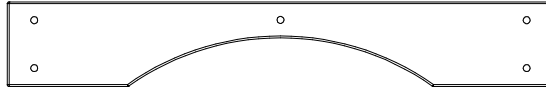

(1) **K3 - ARCHED WALL RAIL - W101530**  
5/8"x5 1/4"x34 1/8" (16x134x868)

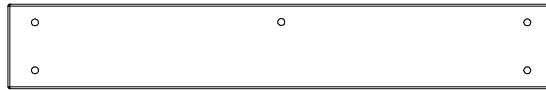

(1) **K4 - WALL RAIL - W101533**  
5/8"x5 1/4"x34 1/8" (16x134x868)



(2) **M1 - TARP SUPPORT - W101540**  
5/8"x3 3/8"x40" (16x86x1016)



(13) **M2 - FLOOR BOARD - W101525**  
5/8"x3 3/8"x36 3/4" (16x86x935)



(3) **M3 - TARP SUPPORT - W101539**  
5/8"x3 3/8"x36 3/4" (16x86x935)



(2) **M4 - FLOOR/TARP SUPPORT - W101541**  
5/8"x3 3/8"x34 7/8" (16x86x887)

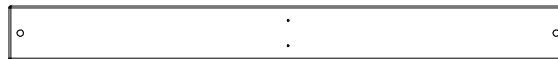

(1) **M5 - WALL RAIL - W101522**  
5/8"x3 3/8"x34 7/8" (16x86x887)



(1) **M6 - WALL RAIL - W101523**  
5/8"x3 3/8"x34 7/8" (16x86x887)



(2) **M7 - FLOOR BOARD - W101524**  
5/8"x3 3/8"x32 1/8" (16x86x815)



(1) **M8 - PICNIC CLEAT - W101632**  
5/8"x3 3/8"x10 1/8" (16x86x258)



# Parts Identification

## Wood Components

(NOT TO SCALE)



- (1) **M9 - PICNIC CLEAT - W101633**  
5/8"x3 3/8"x6 3/4" (16x86x172)

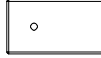

- (2) **M10 - WALL RAIL - W101621**  
5/8"x3 3/8"x6 1/4" (16x86x160)



- (2) **M11 - WALL RAIL - W101527**  
5/8"x3 3/8"x4 3/4" (16x86x122)

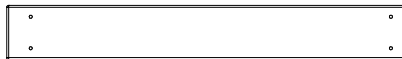

- (9) **M12 - WALL SLAT - W101536**  
5/8"x3 3/8"x25 1/4" (16x86x640)



- (1) **M13 - WALL RAIL - W4L05295**  
5/8"x3 3/8"x34 7/8" (16x86x887)



- (6) **M71 - ROCK BOARD - W100022**  
5/8"x3 3/8"x20 1/4" (16x86x514)



- (2) **M72 - ROCK WALL SLAT - W100023**  
5/8"x3 3/8"x20 1/4" (16x86x514)

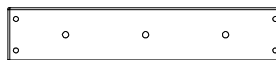

- (1) **M77 - SLIDE BRACE - W100544**  
5/8"x3 3/8"x17 1/4" (16x86x438)



- (2) **M78 - CENTER SLIDE BRACE - W100545**  
5/8"x3 3/8"x17 1/4" (16x86x438)



- (1) **N1 - WALL RAIL - W101624**  
5/8"x1 1/8"x34 1/8" (16x30x868)



- (1) **SB74 - SWING BEAM - W102304**  
2"x5 1/4"x89 1/2" (50x134x2274)



- (1) **W71 - SWING BEAM SUPPORT - W102305**  
2"x3 3/8"x46 1/8" (50x86x1170)

# Parts Identification

## Hardware

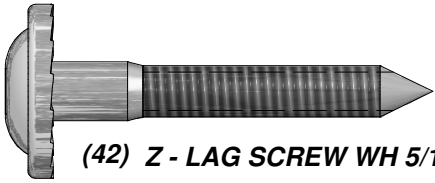

(42) Z - LAG SCREW WH 5/16x2 - H100027



(2) AA - LAG SCREW WH 5/16x2 1/2 - H100028

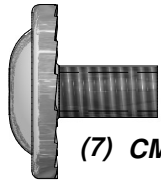

(7) CM - BOLT WH 5/16x1/2 - H100115

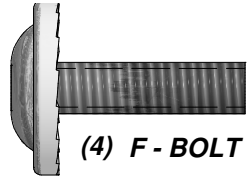

(4) F - BOLT WH 5/16x1 - H100008

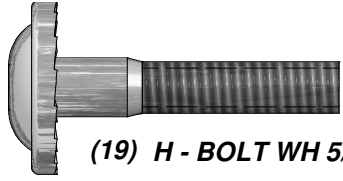

(19) H - BOLT WH 5/16x1 1/2 - H100010

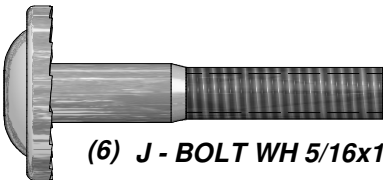

(6) J - BOLT WH 5/16x1 3/4 - H100011

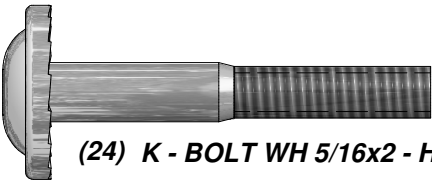

(24) K - BOLT WH 5/16x2 - H100012

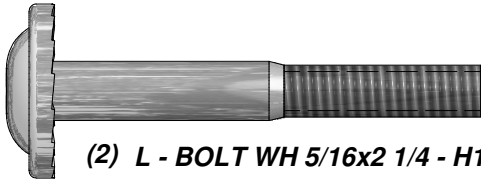

(2) L - BOLT WH 5/16x2 1/4 - H100013

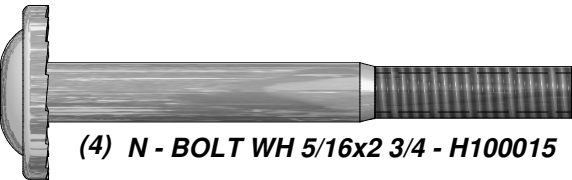

(4) N - BOLT WH 5/16x2 3/4 - H100015

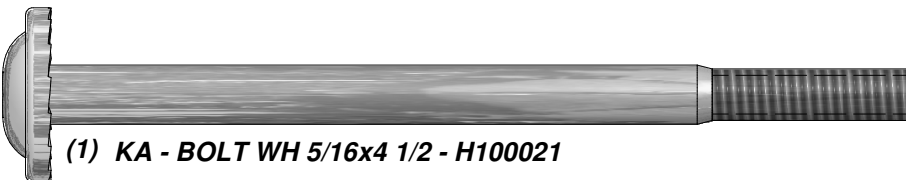

(1) KA - BOLT WH 5/16x4 1/2 - H100021

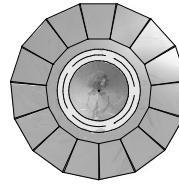

(56) D - NUT BARREL WH 5/16x7/8 - H100005

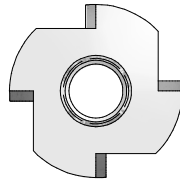
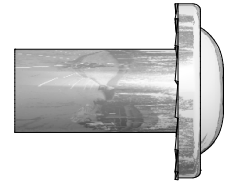

(13) BG - T-NUT 5/16 - H100074

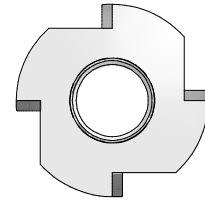

(7) BF - T-NUT 3/8 - H100073

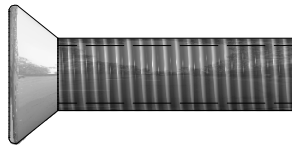
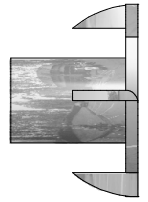

(7) A - BOLT FA 3/8x1 1/2 - H100001

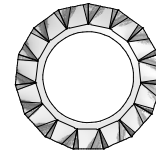

(60) AD - WASHER LOCK EXT 12x19 - H100031



(19) CY - SCREW PWH 8x5/8 - H100128

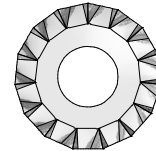

(99) AC - WASHER LOCK EXT 8x19 - H100030

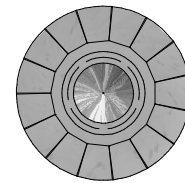

(2) B - NUT BARREL WH 5/16x5/8 - H100004

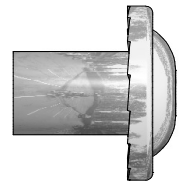

(2) AN - BOLT HEX 5/16x2-3/4 - H100047

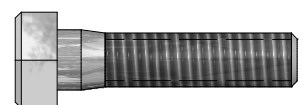

(4) AJ - BOLT HEX 5/16x1 1/4 - H100042

# Parts Identification

## Hardware



(9) **BL - SCREW TAPPING 14x3/4 - H100083**

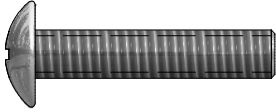

(4) **AZ - BOLT PTH 1/4x1 1/4 - H100062**



(48) **BR - SCREW PFH 8x1 1/8 - H100088**



(48) **BQ - SCREW PFH 8x1 1/4 - H100087**



(44) **BP - SCREW PFH 8x1 1/2 - H100086**



(9) **BS - SCREW PFH 8x1 3/4 - H100089**



(82) **CK - SCREW PFH 8x2 - H100111**



(4) **BT - SCREW PFH 8x2 1/2 - H100090**



(26) **BW - SCREW PFH 8x3 - H100092**

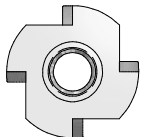

(4) **BE - T-NUT 1/4 - H100072**

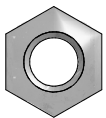

(9) **CJ - NUT LOCK 5/16 - H100110**

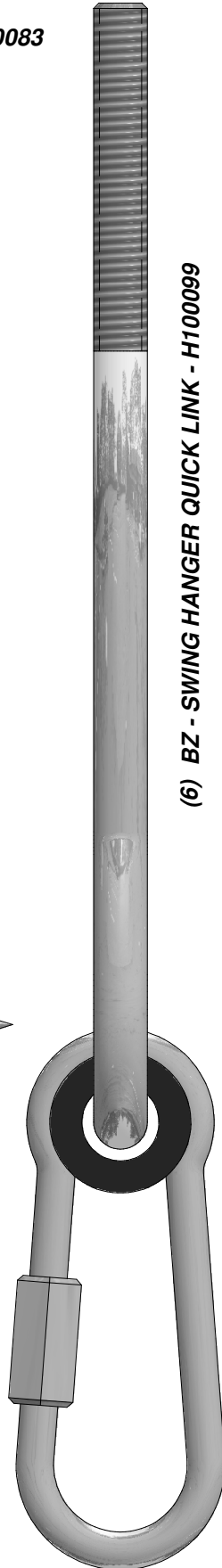
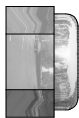

(6) **BZ - SWING HANGER QUICK LINK - H100099**

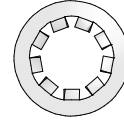

(4) **CG - WASHER LOCK INT 8x15 - H100108**

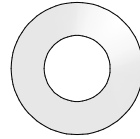

(4) **CE - WASHER FLAT 9x18 - H100106**

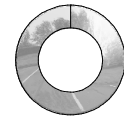

(4) **BX - WASHER SPLIT 5/16 - H100095**

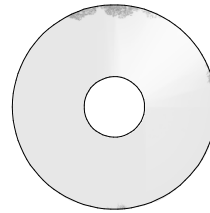

(15) **CD - WASHER FLAT 8x27 - H100105**

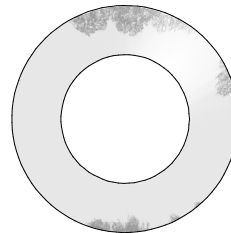

(7) **CB - WASHER SAFETY 17x30 - H100103**

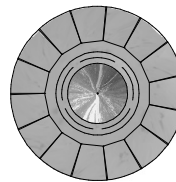

(2) **C - NUT BARREL WH 5/16x1 1/2 - H100006**

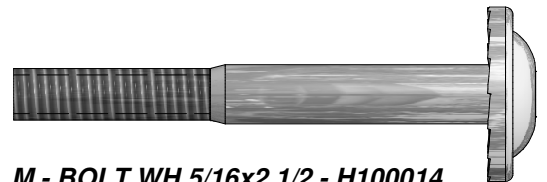
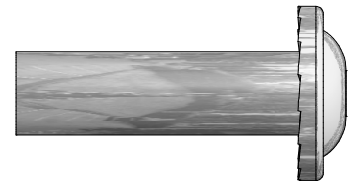

(2) **M - BOLT WH 5/16x2 1/2 - H100014**

# Parts Identification

## Accessories

(NOT TO SCALE)



(1) EK - SLIDE RAIL 8' GREEN RIGHT - A100054

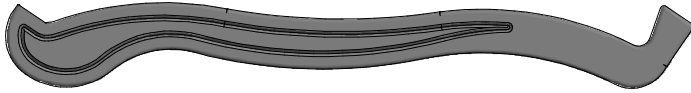

(1) EL - SLIDE RAIL 8' GREEN LEFT - A100055



(1) EM - SLIDE BED 8' YELLOW - A100056

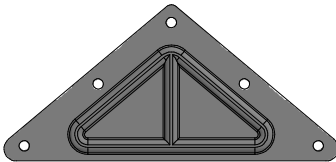

(2) QZ - TRIANGLE PLATE 100° 5 HOLE - A100294

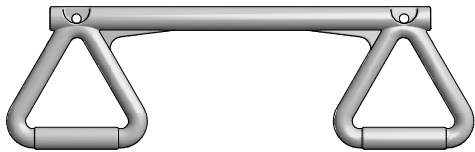

(1) - TRAPEZE - A6P00034

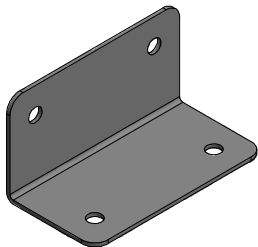

(2) GD - L BRACKET 66x66x127 - A100140

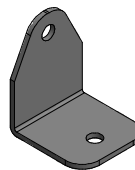

(4) EJ - L BRACKET 54x67 - A100053



(2) EA - HAND GRIP YELLOW PLASTIC - A100043



(1) HC - BYD ID TAG (LARGE) 2011 WITH AGES - A100164

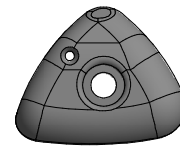

(6) ER - CLIMBING ROCK GREEN SMALL - A100060

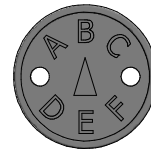

(1) SR - "B" REVISION TAG - A100315

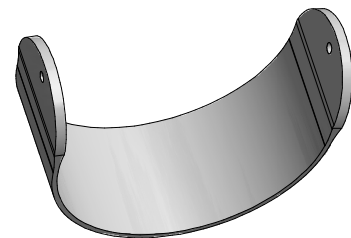

(2) FB - SWING SEAT YELLOW - A100070



(6) FA - QUICK LINK - A100069



(2) KN - CHAIN GREEN 31" - A100177



(4) EZ - CHAIN GREEN 51.25" - A100068

# Parts Identification

## Accessories

(NOT TO SCALE)

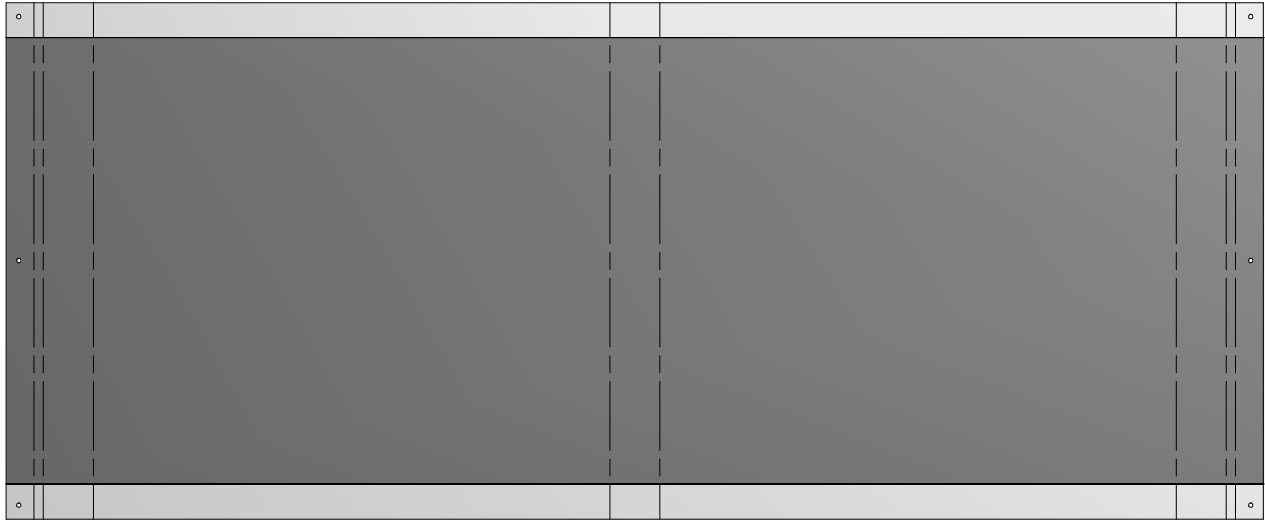

(1) KC - ROOF TARP - A100196

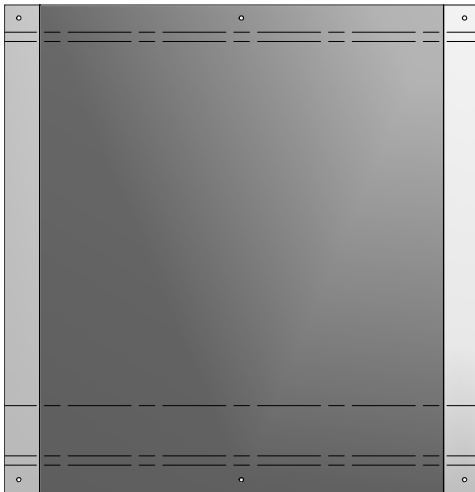

(1) KB - PICNIC TABLE TARP - A100195



2 - T-40 TORX WRENCH - A100041

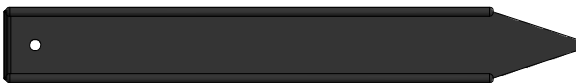

(6) KD - PLASTIC GROUND STAKE BROWN - A100179

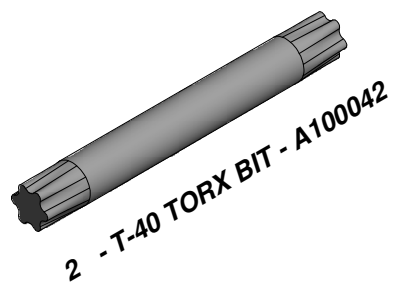

2 - T-40 TORX BIT - A100042

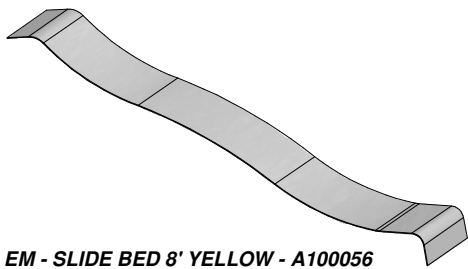

(1) EM - SLIDE BED 8' YELLOW - A100056

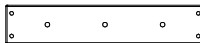

(1) M77 - SLIDE BRACE - W100544  
5/8"x3 3/8"x17 1/4" (16x86x438)

## SLIDE ASSEMBLY STEP 1

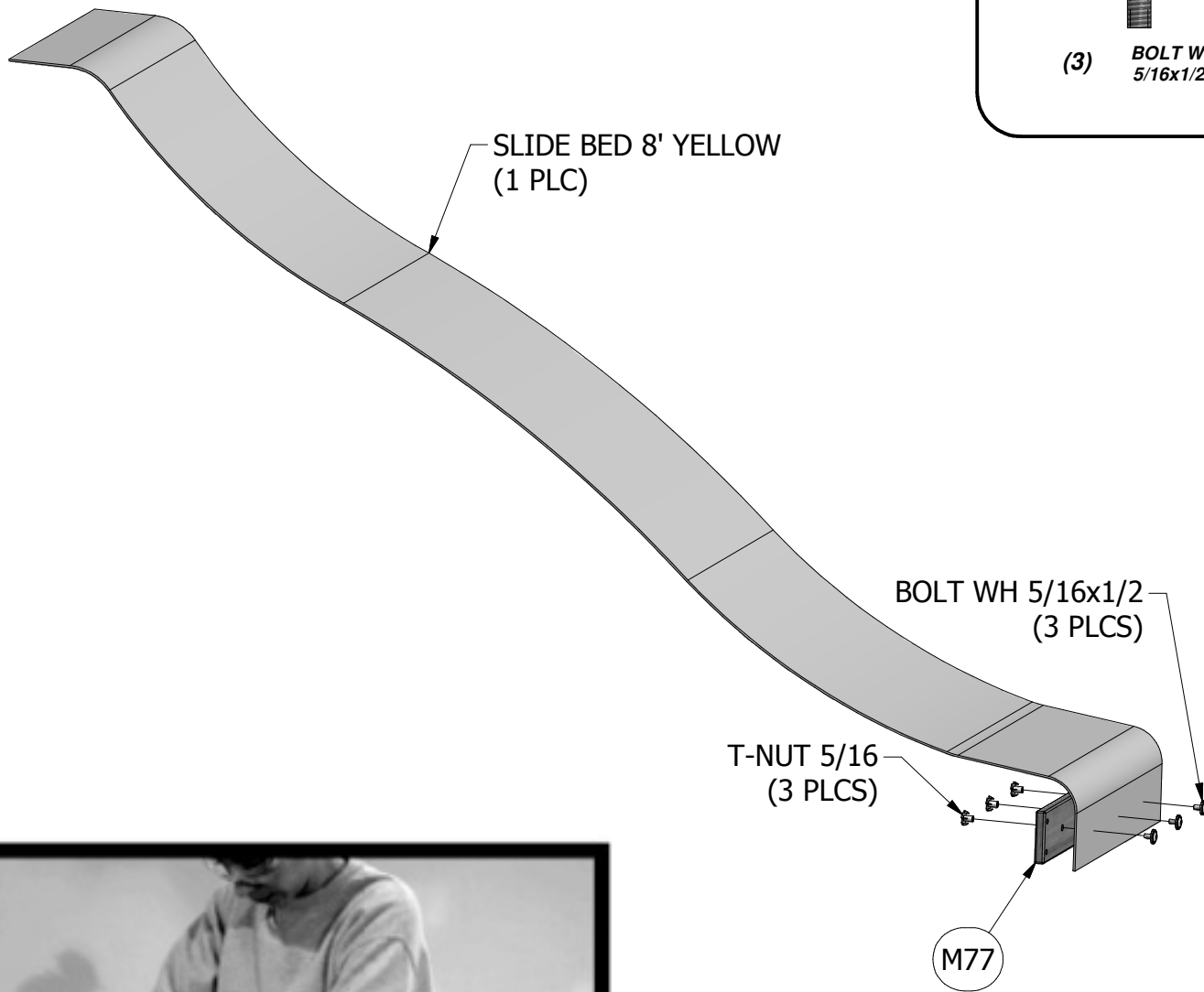
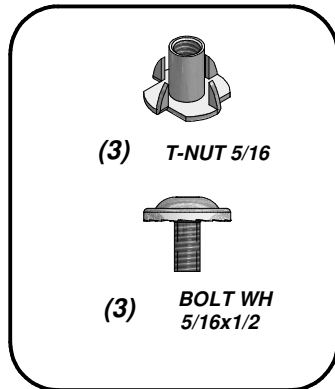

**USE 'M77' SLIDE BRACE AS A TEMPLATE FOR DRILLING BOTTOM HOLE PATTERN IN SLIDE BED. BE SURE TO PLACE SLIDE BRACE UP 1/4" FROM BOTTOM EDGE OF SLIDE BED BEFORE MARKING HOLE PATTERN.**

**TIP: PREBENDING THE ENDS WILL EASE ASSEMBLY.**

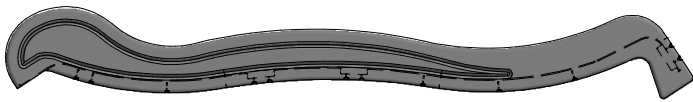

(1) EK - SLIDE RAIL 8' GREEN RIGHT - A100054



(1) EL - SLIDE RAIL 8' GREEN LEFT - A100055



(2) M78 - CENTER SLIDE BRACE - W100545  
5/8"x3 3/8"x17 1/4" (16x86x438)

## SLIDE ASSEMBLY STEP 2

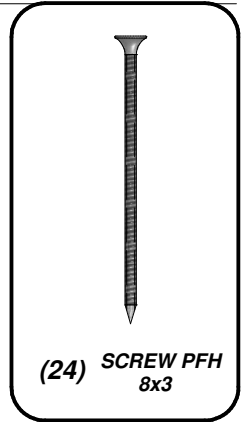
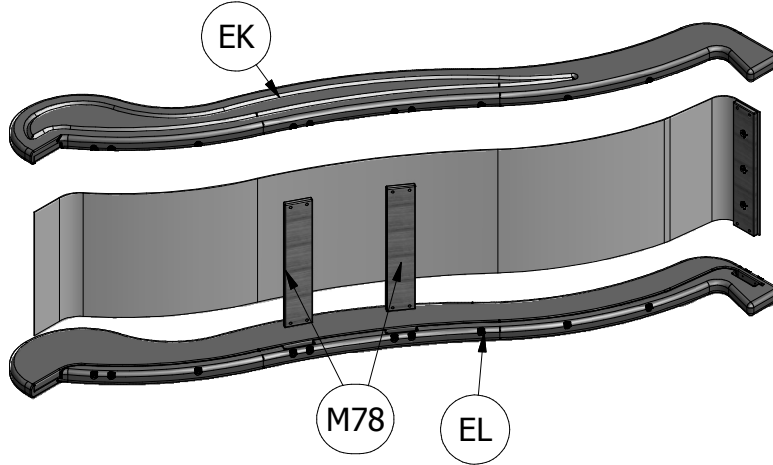

### NOTE:

**MAKE CERTAIN  
SUPPORTS AND SLIDE  
BED ARE FULLY  
ENGAGED WITHIN  
CHANNEL OF SLIDE  
RAILS.**

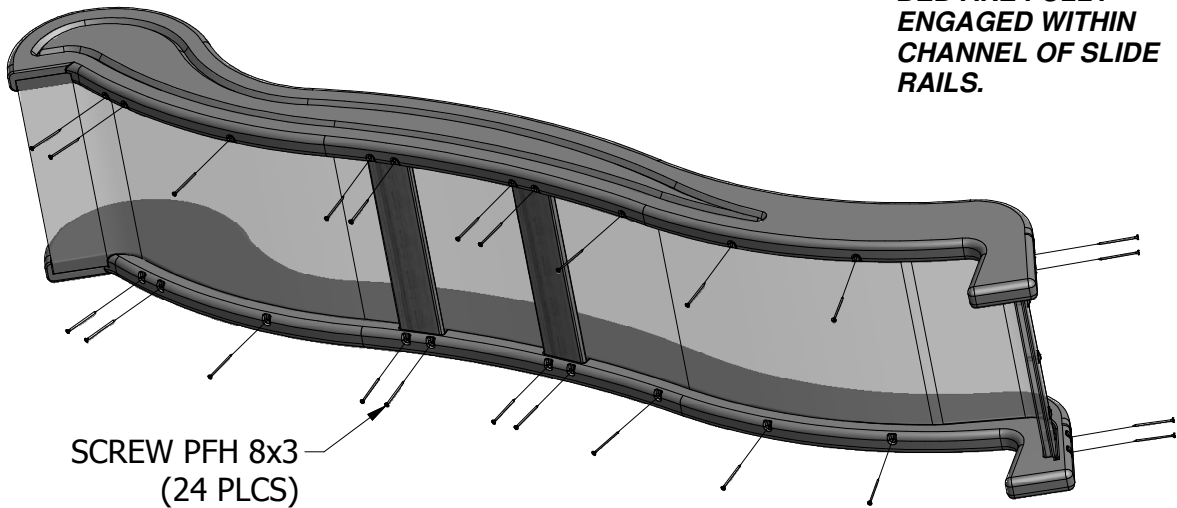

**TIP: A HELPER IS REQUIRED FOR THIS STEP.**

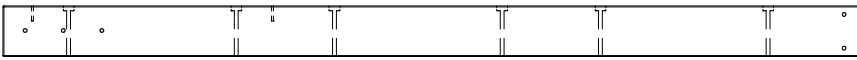

(1) **SB74 - SWING BEAM - W102304**  
2"x5 1/4"x89 1/2" (50x134x2274)

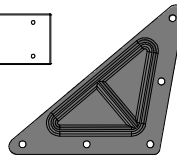

(2) **QZ - TRIANGLE PLATE 100° 5 HOLE - A100294**

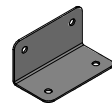

(2) **GD - L BRACKET 66x66x127 - A100140**

# SWING BEAM ASSEMBLY

## STEP 1

**ATTACH (2) QZ TRIANGLE PLATES TO SB74 SWING BEAM USING 1-3/4" BOLTS, LOCK WASHERS AND 7/8" BARREL NUTS.**

**ATTACH (2) GD L BRACKETS TO SB74 SWING BEAM USING 2-3/4" HEX BOLTS, FLAT WASHERS AND 5/16" LOCK NUTS.**

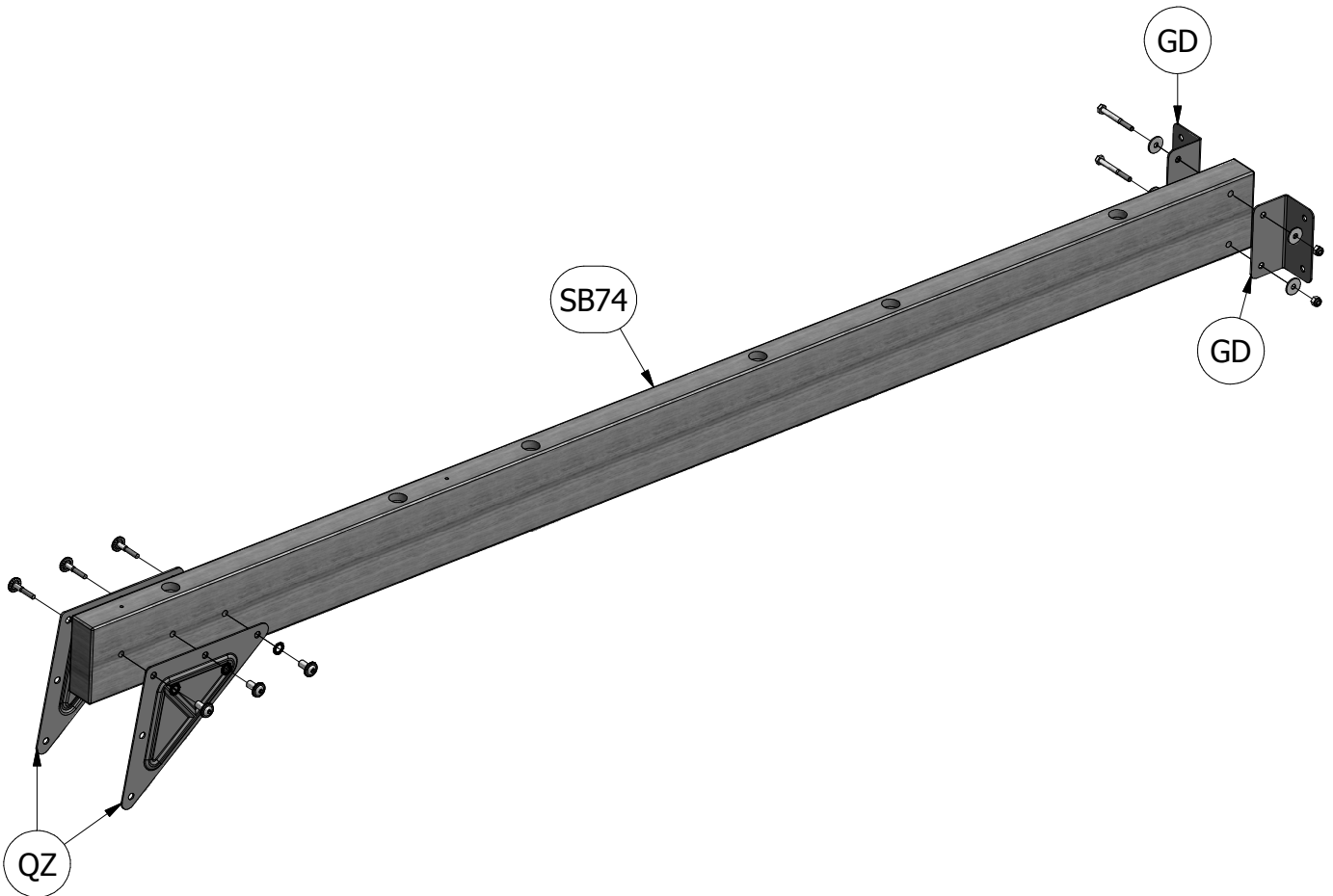
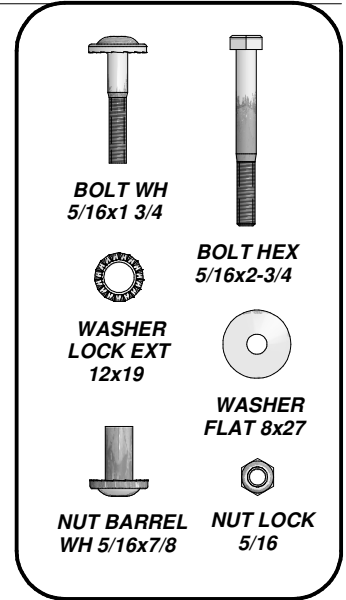



(1) **W71 - SWING BEAM SUPPORT - W102305**  
 2"x3 3/8"x46 1/8" (50x86x1170)

(1) **H79 - END SUPPORT - W100992**  
 1"x3 1/2"x42" (24x86x1072)

(2) **E77 - ANGLE BRACE - W100991**  
 1 3/8"x3 3/8"x74 3/8" (36x86x1890)

(1) **H80 - GROUND BOARD - W100990**  
 1"x3 3/8"x87 3/8" (24x86x2218)

# SWING BEAM ASSEMBLY

## STEP 2

**INSERT (2) 2-1/2" BOLTS, LOCK WASHERS AND 1-1/2" BARREL NUTS INTO TOP EDGE OF W71 SWING BEAM SUPPORT, AS SHOWN.**

**ATTACH E77 ANGLE BRACES TO W71 SWING BEAM SUPPORT USING 4- 1/2" BOLTS, LOCK WASHERS AND 7/8" BARREL NUTS.**

**ATTACH H79 END SUPPORT TO E77 ANGLE BRACES USING 2" BOLTS, LOCK WASHERS AND 7/8" BARREL NUTS. NOW ATTACH H79 END SUPPORT TO W71 SWING BEAM SUPPORT USING 2" LAG SCREWS AND LOCK WASHERS.**

**ATTACH H80 GROUND BOARD TO E77 ANGLE BRACES USING 2" BOLTS, LOCK WASHERS AND 7/8" BARREL NUTS.**

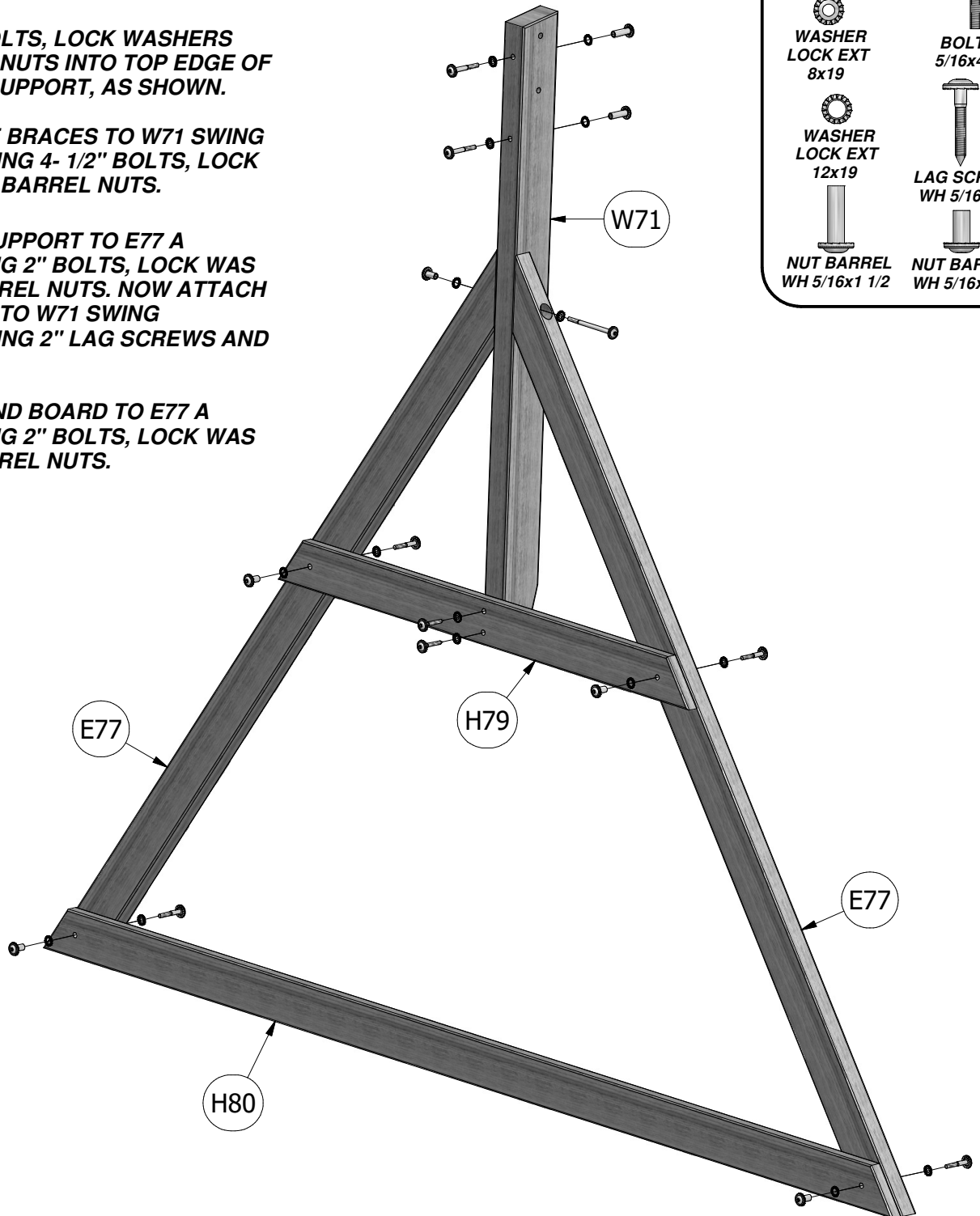
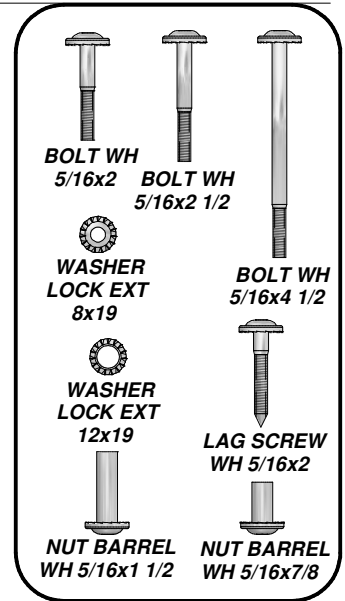

# SWING BEAM ASSEMBLY

## STEP 3

ATTACH (2) QZ TRIANGLE PLATES TO W71 SWING BEAM SUPPORT USING 1-3/4" BOLTS, LOCK WASHER AND 7/8" BARREL NUT.

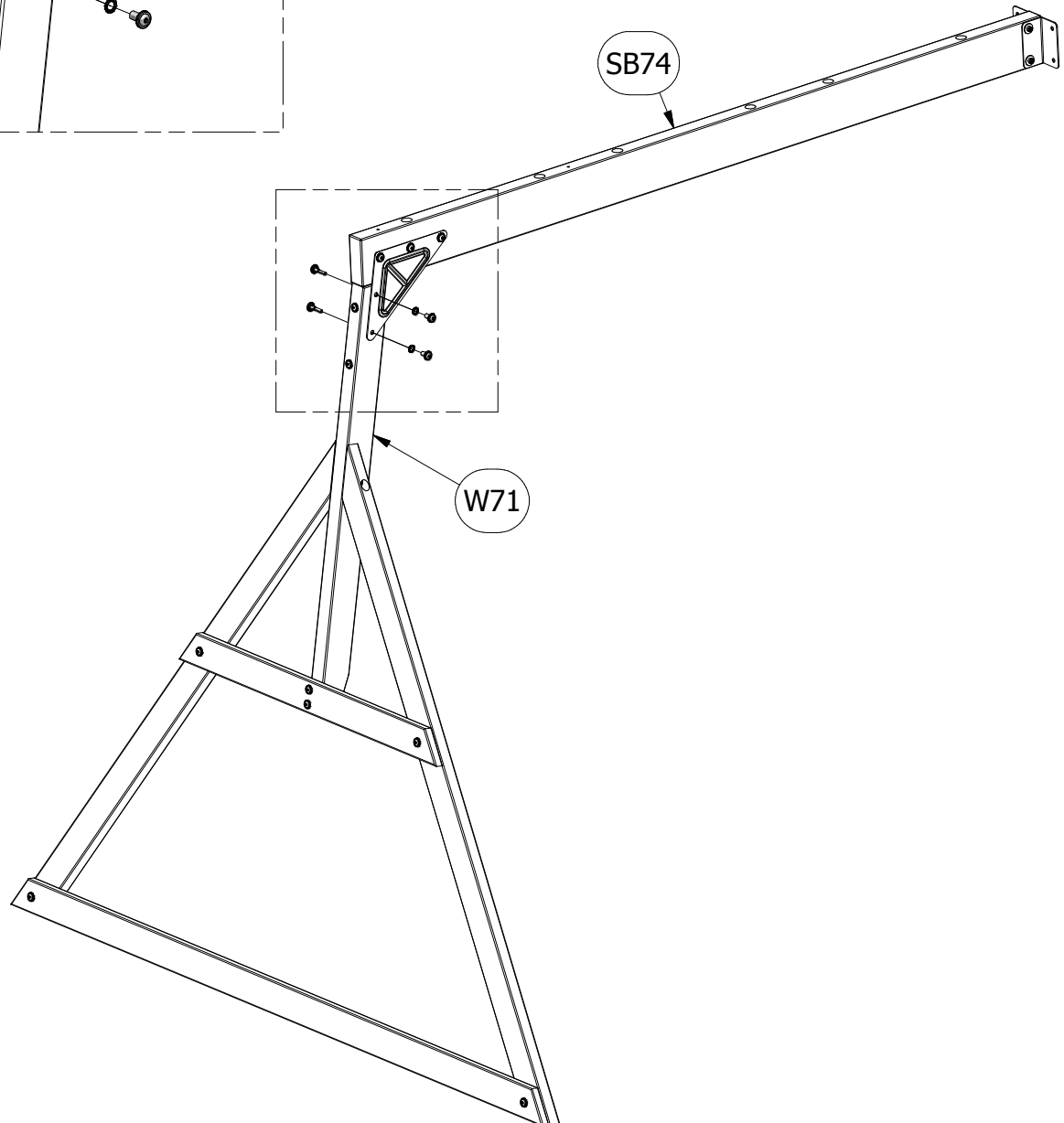
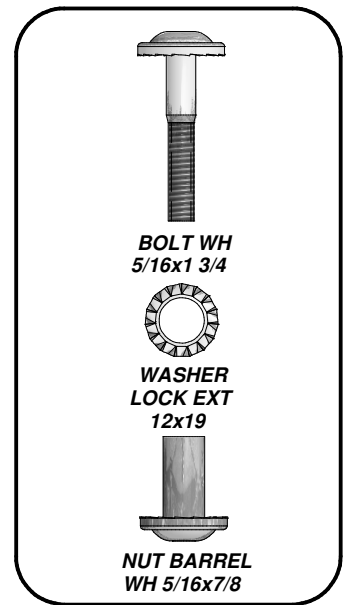
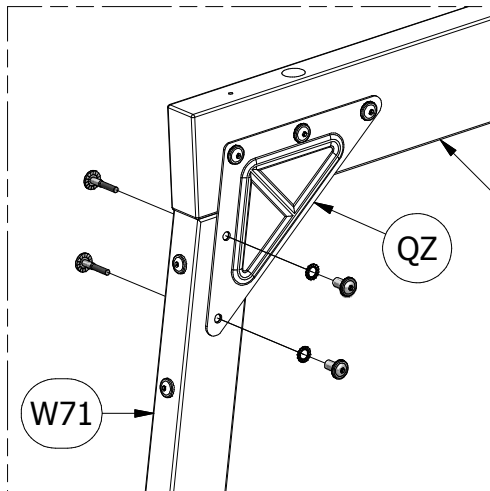

# SWING BEAM ASSEMBLY

## STEP 4

INSERT SWING HANGER QUICK LINK AND SAFETY WASHER INTO HOLES IN THE EDGE OF SB74 SWING BEAM. SECURE SWING HANGER TO W71 SWING BEAM USING FLAT WASHERS AND 5/16" LOCK NUTS.

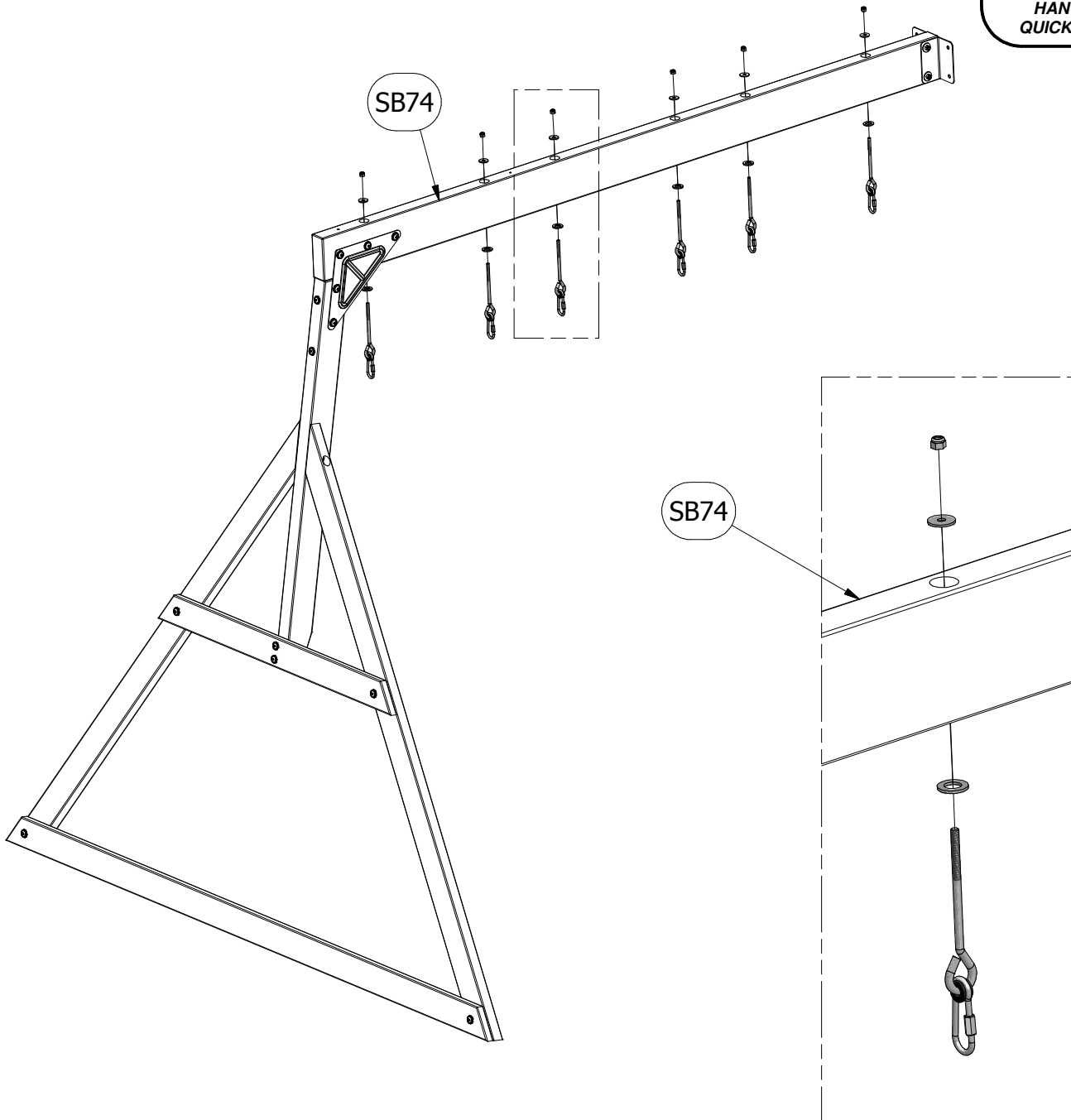
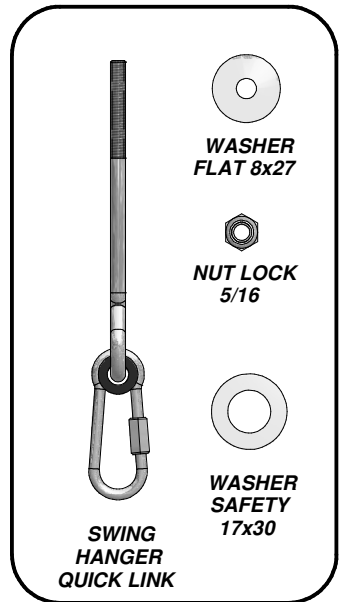

# 4' Rock Ladder Phase 1

## Phase Notes

- Assemble slats to rails as shown.
- Note orientation of slats, be sure to arrange as shown.
- See drawing below for slat spacing on rails.
- Using slats as a guide, pre-drill top edges of rails with a 1/8" drill bit. Failure to pre-drill may result in board splitting.

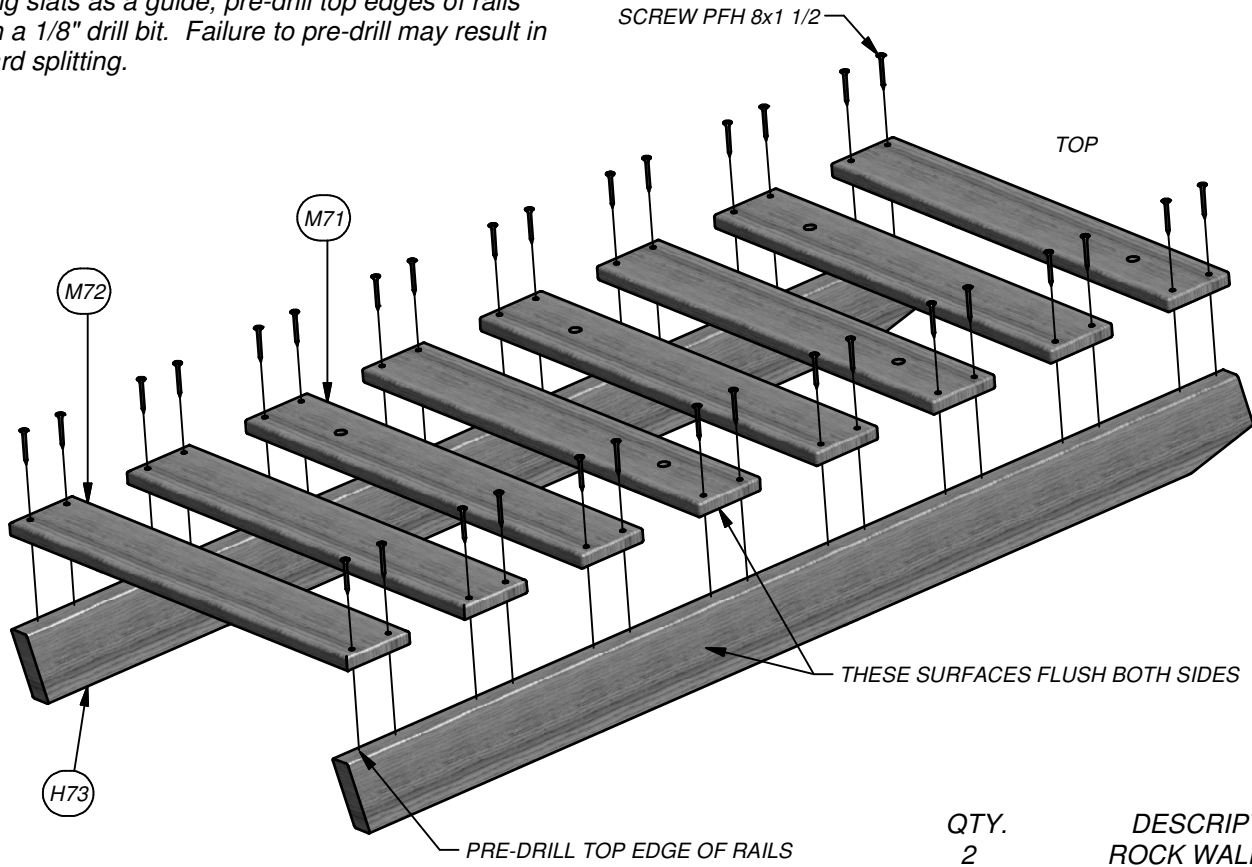

QTY.	DESCRIPTION
2	ROCK WALL RAIL
6	ROCK BOARD
2	ROCK WALL SLAT
32	SCREW PFH 8x2

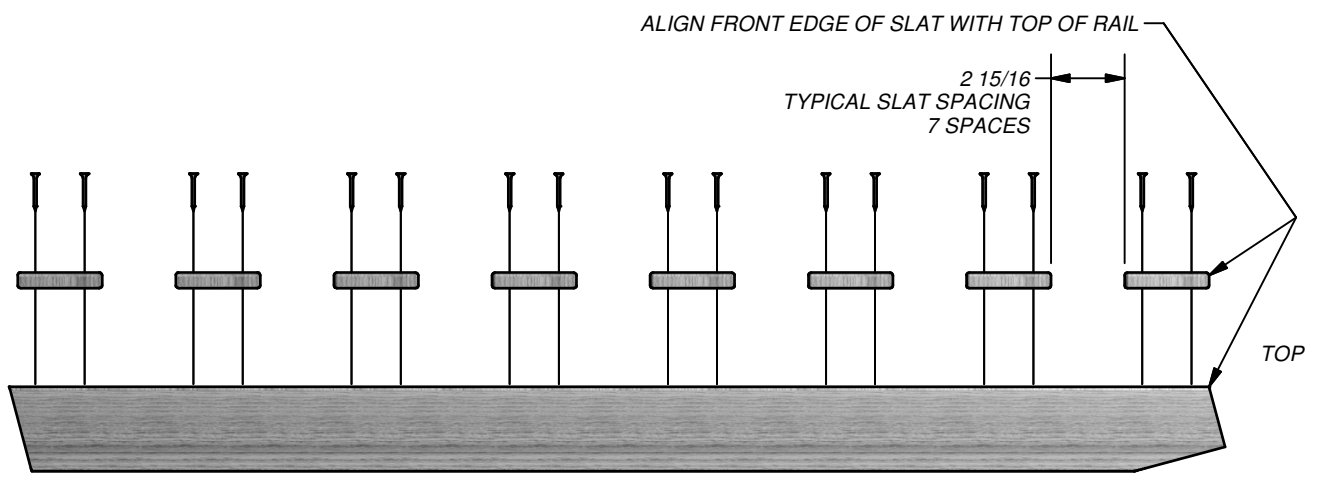

# 4' Rock Ladder

## Phase 2 & 3

### Phase Notes

- Orieint top edge of rocks with top edge of slats.
- Fasten rocks as shown.

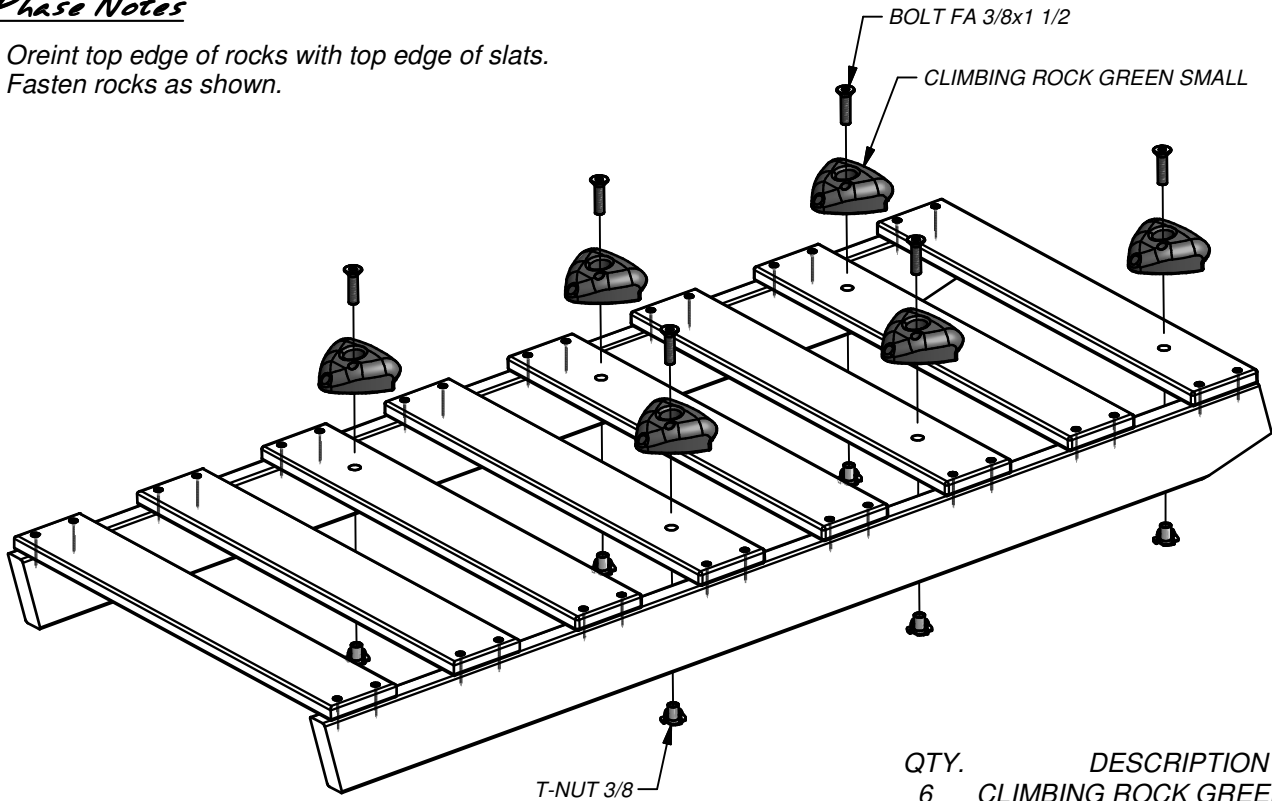

QTY.	DESCRIPTION
6	CLIMBING ROCK GREEN SMALL
6	BOLT FA 3/8x1-1/2
6	T-NUT 3/8

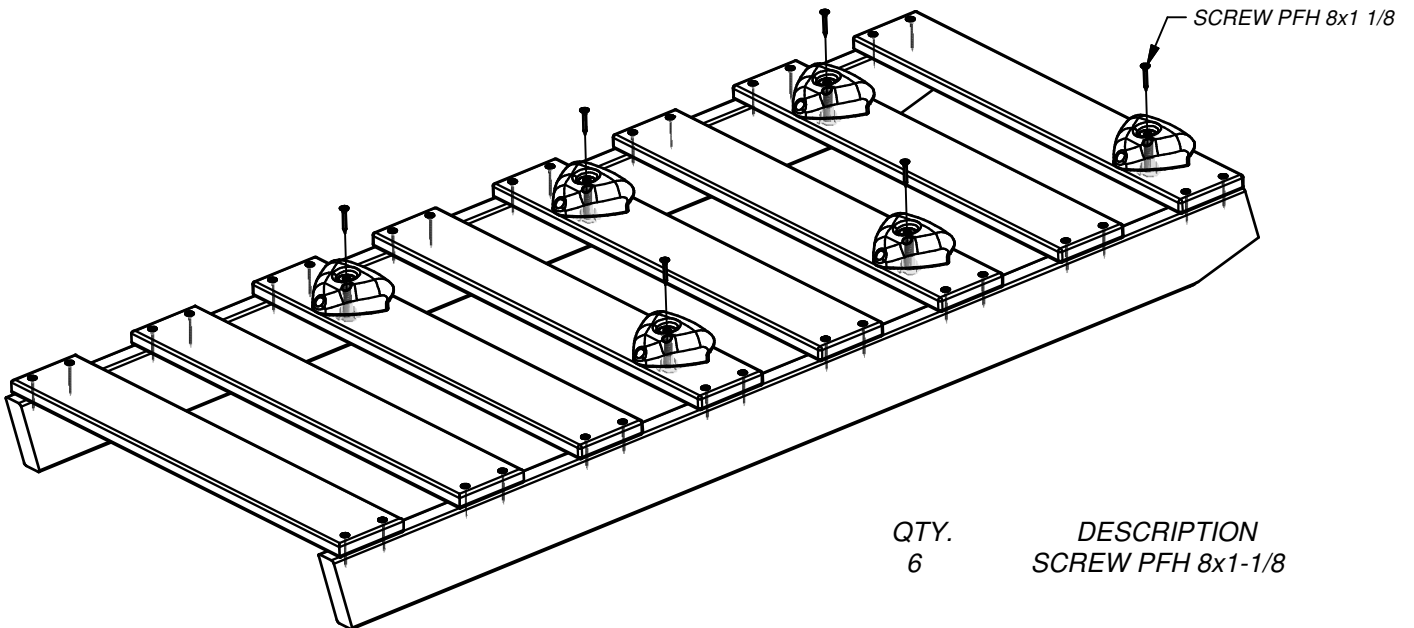

QTY.	DESCRIPTION
6	SCREW PFH 8x1-1/8

# Fort Assembly

## Phase 1

### Parts needed:

- (1) H1 - ROOF CROSS BRACE - W101538
- (2) E2 - FORT UPRIGHT - W101520
- (1) N1 - WALL RAIL - W101624
- (1) G2 - SWING BEAM SUPPORT - W101623
- (1) K4 - WALL RAIL - W101533
- (1) H2 - WALL RAIL - W101521
- (1) G1 - GROUND BOARD - W101529

### Hardware needed:

- (14) D - NUT BARREL WH 5/16x7/8 - H100005
- (14) AD - WASHER LOCK EXT 12x19 - H100031
- (16) AC - WASHER LOCK EXT 8x19 - H100030
- (10) K - BOLT WH 5/16x2 - H100012
- (4) H - BOLT WH 5/16x1-1/2 - H100010
- (2) BS - SCREW PFH 8x1-3/4 - H100089
- (2) Z - LAG SCREW WH 5/16x2 - H100027

### Phase Notes

- Assemble with hardware as shown.
- For ease during assembly, assemble uprights flat on the ground.

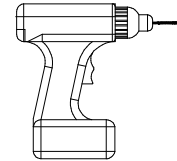

To prevent board splitting, you must pre-drill each board with a 1/8" drill bit, before attaching.

**Step 1:** Attach 'H1' Floor Brace to 'E2' Fort Uprights using hardware 'K', 'AC', 'AD' and 'D', as shown.

**Step 3:** Attach 'G2' Swing Beam Support to 'E2' Fort Uprights using hardware 'K', 'AC', 'AD' and 'D', as shown.

**Step 5:** Attach 'H2' Wall Rail to 'E2' Fort Uprights using Lag Screw 'Z' & Washer 'AC', as shown.

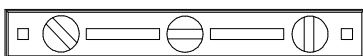

**Note:** It is vital that the fort be level before and after each phase of assembly.

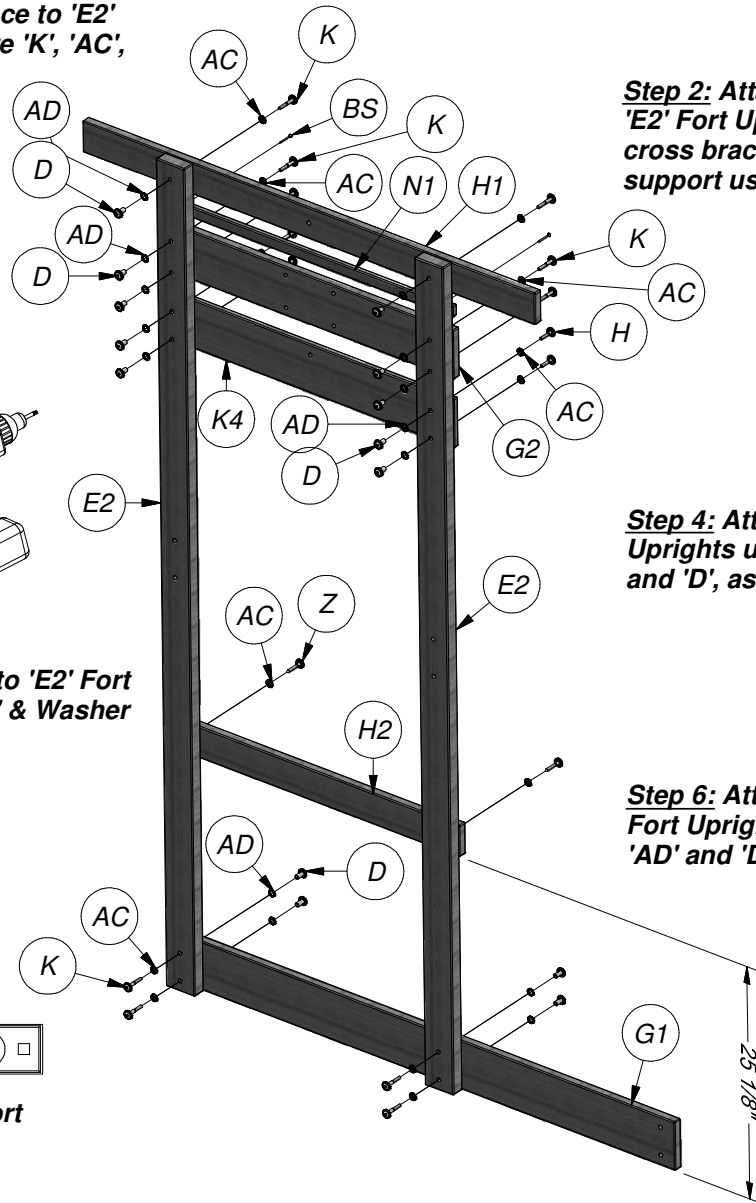

**Step 2:** Attach & center 'N1' Wall Rail to 'E2' Fort Uprights between 'H1' roof cross brace and 'G2' swing beam support using Screws 'BS', as shown.

**Step 4:** Attach 'K4' Wall Rail to 'E2' Fort Uprights using hardware 'H', 'AC', 'AD' and 'D', as shown.

**Step 6:** Attach 'G1' Ground Board to 'E2' Fort Uprights using hardware 'K', 'AC', 'AD' and 'D', as shown.

# Fort Assembly

## Phase 2

### Parts needed:

- (1) H1 - ROOF CROSS BRACE - W101538
- (2) E1 - FORT UPRIGHT - W101519
- (1) K3 - ARCHED WALL RAIL - W101530
- (1) G1 - GROUND BOARD - W101529

### Hardware needed:

- (10) D - NUT BARREL WH 5/16x7/8 - H100005
- (10) AD - WASHER LOCK EXT 12x19 - H100031
- (10) AC - WASHER LOCK EXT 8x19 - H100030
- (6) K - BOLT WH 5/16x2 - H100012
- (4) H - BOLT WH 5/16x1-1/2 - H100010

### Phase Notes

- Assemble with hardware as shown.

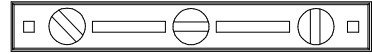

**Note:** It is vital that the fort be level before and after each phase of assembly.

**Step 1:** Attach 'H1' Roof Cross Brace to 'E1' Fort Uprights using hardware 'K', 'AC', 'AD', & 'D' as shown.

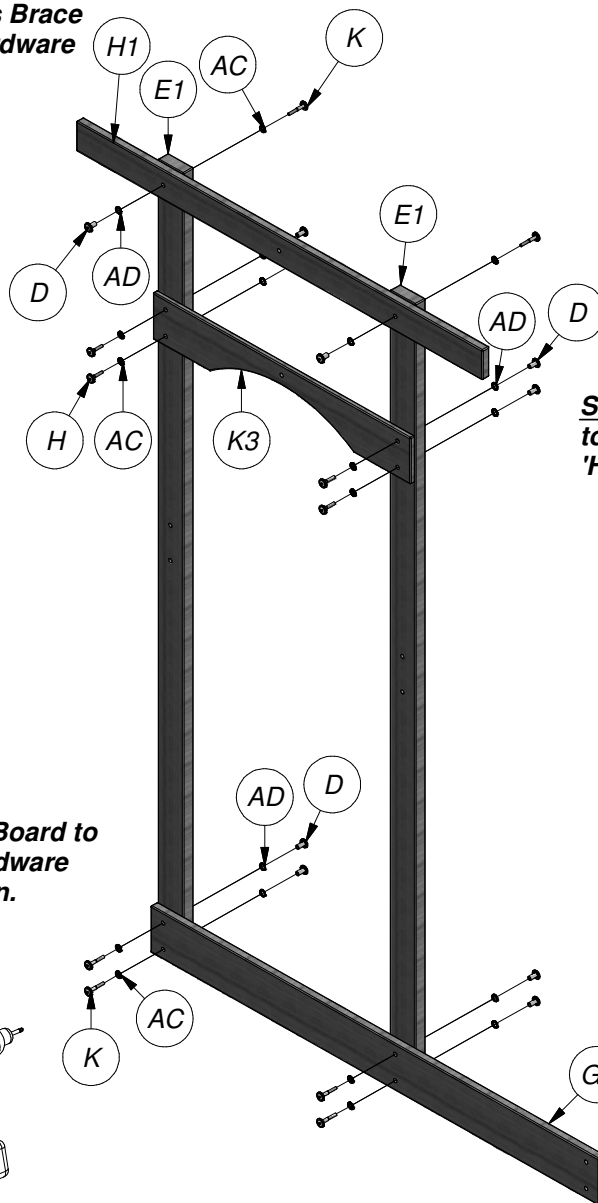

**Step 2:** Attach 'K3' Arched Wall Rail to 'E1' Fort Uprights using hardware 'H', 'AC', 'AD', & 'D' as shown.

**Step 3:** Attach 'G1' Ground Board to 'E1' Fort Uprights using hardware 'K', 'AC', 'AD', & 'D' as shown.

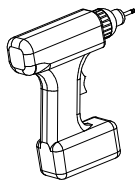

# Fort Assembly

## Phase 3

### Parts needed:

- (2) M3 - TARP SUPPORT - W101539
- (1) M4 - FLOOR/TARP SUPPORT - W101541
- (3) K1 - WALL RAIL - W101528
- (1) K2 - ARCHED WALL RAIL - W101531
- (1) M5 - WALL RAIL - W101522
- (1) M13 - WALL RAIL - W4L05295

### Hardware needed:

- (8) CK - SCREW PFH 8x2 - H100111
- (4) BP - SCREW PFH 8x1-1/2 - H100086
- (20) Z - LAG SCREW WH 5/16x2 - H100027
- (20) AC - WASHER LOCK EXT 8x19 - H100030

### Phase Notes

- Assemble with hardware as shown.

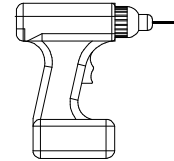

To prevent board splitting, you must pre-drill each board with a 1/8" drill bit, before attaching.

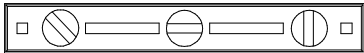

**Note:** It is vital that the fort be level before and after each phase of assembly.

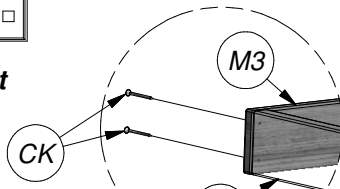

**Step 5:** Attach 'M3' Tarp Supports to 'H1' Roof Cross Braces using Screw 'CK', as shown.

**Step 3:** Attach 'K1' Wall Rail & 'K2' Arched Wall Rail to 'E1' & 'E2' fort uprights using Lag Screw 'Z' & Washer 'AC', as shown.

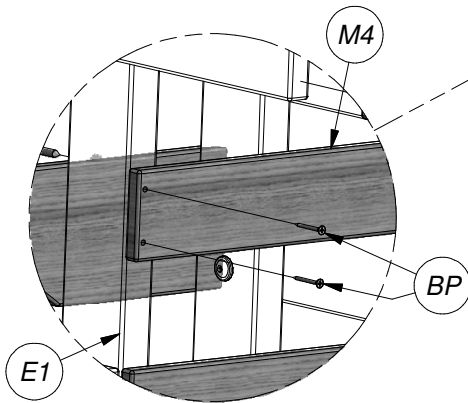

**Step 4:** Attach 'M4' Floor / Tarp Support to 'E1' & 'E2' fort uprights using Screw 'BP', as shown.

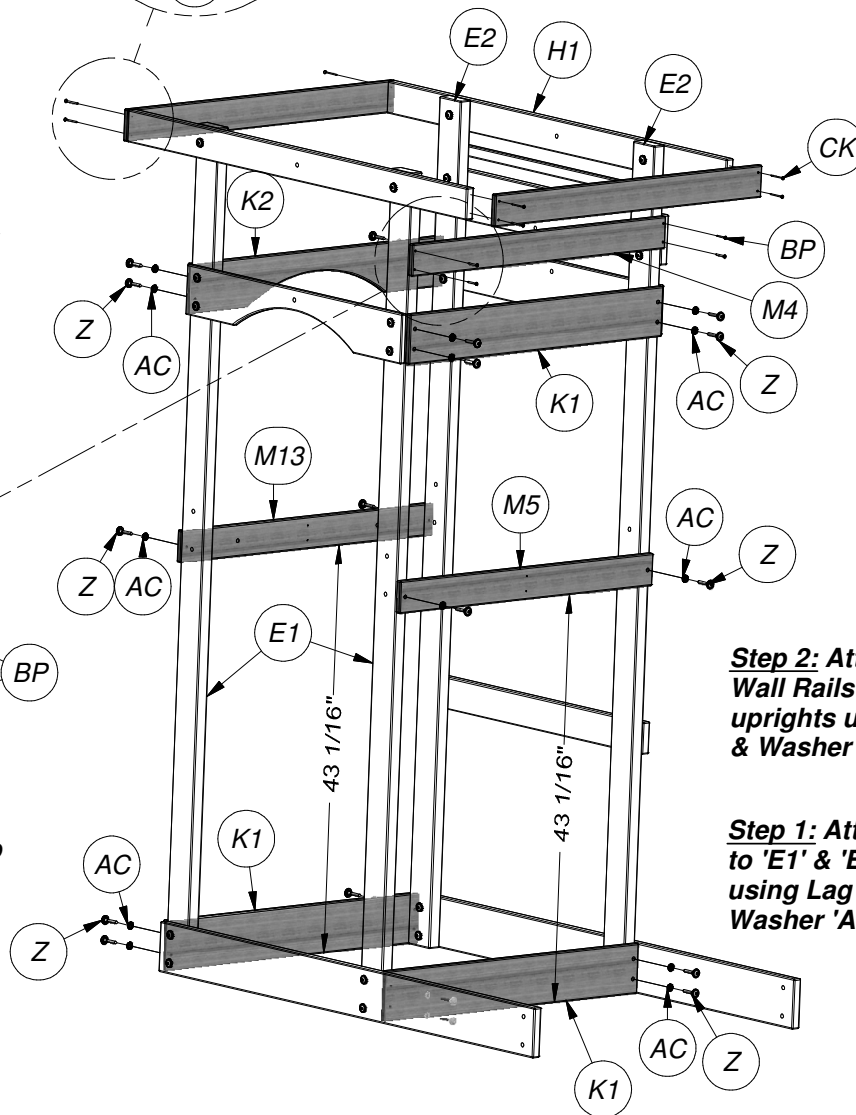

**Step 2:** Attach 'M5' and 'M13' Wall Rails to 'E1' & 'E2' fort uprights using Lag Screw 'Z' & Washer 'AC', as shown.

**Step 1:** Attach 'K1' Wall Rails to 'E1' & 'E2' fort uprights using Lag Screw 'Z' & Washer 'AC', as shown.



# Fort Assembly

## Phase 4

### Parts needed:

- (1) H4 - FLOOR BRACE - W101631
- (2) H2 - FLOOR JOIST - W101521
- (4) H10 - FLOOR BRACE - W101534
- (2) F1 - ANGLE BRACE - W101630

### Phase Notes

- Assemble with hardware as shown.



**Note:** It is vital that the fort be level before and after each phase of assembly.

### Hardware needed:

- (4) BT - SCREW PFH 8x2-1/2 - H100090
- (4) N10 - BOLT WH 5/16x2-3/4 - H100015
- (8) AC - WASHER LOCK EXT 8x19 - H100030
- (4) AD - WASHER LOCK EXT 12x19 - H100031
- (4) D - NUT BARREL WH 5/16x7/8 - H100005
- (4) Z - LAG SCREW WH 5/16x2 - H100027

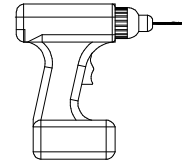

To prevent board splitting, you must pre-drill each board with a 1/8" drill bit, before attaching.

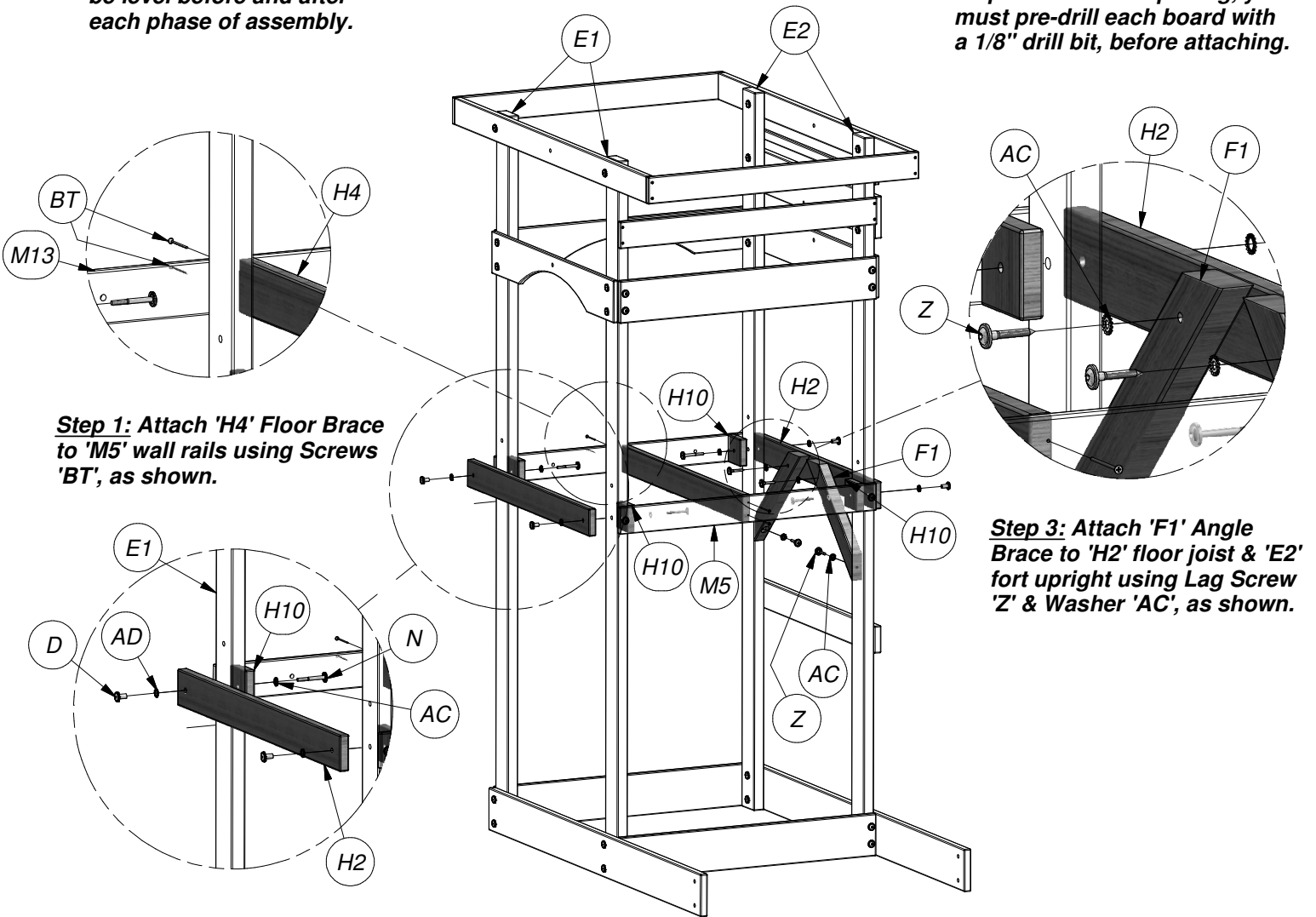

**Step 1:** Attach 'H4' Floor Brace to 'M5' wall rails using Screws 'BT', as shown.

**Step 2:** Attach 'H2' Floor Joist & 'H10' Floor Brace to 'E2' fort upright using Bolt 'N10', Washer 'AC' & 'AD' and Barrel Nut 'D', as shown. Repeat this process in each of the remaining three corners of the fort.

**Step 3:** Attach 'F1' Angle Brace to 'H2' floor joist & 'E2' fort upright using Lag Screw 'Z' & Washer 'AC', as shown.

# Fort Assembly

## Phase 5

### Parts needed:

- (2) M7 - FLOOR BOARD - W101524
- (8) M2 - FLOOR BOARD - W101525

### Hardware needed:

- (40) CK - SCREW PFH 8x2 - H100111
- (20) BQ - SCREW PFH 8x1-1/4 - H100087

### Phase Notes

- Assemble with hardware as shown.

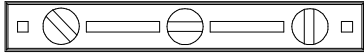

**Note:** It is vital that the fort be level before and after each phase of assembly.

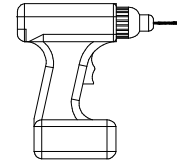

To prevent board splitting, you must pre-drill each board with a 1/8" drill bit, before attaching.

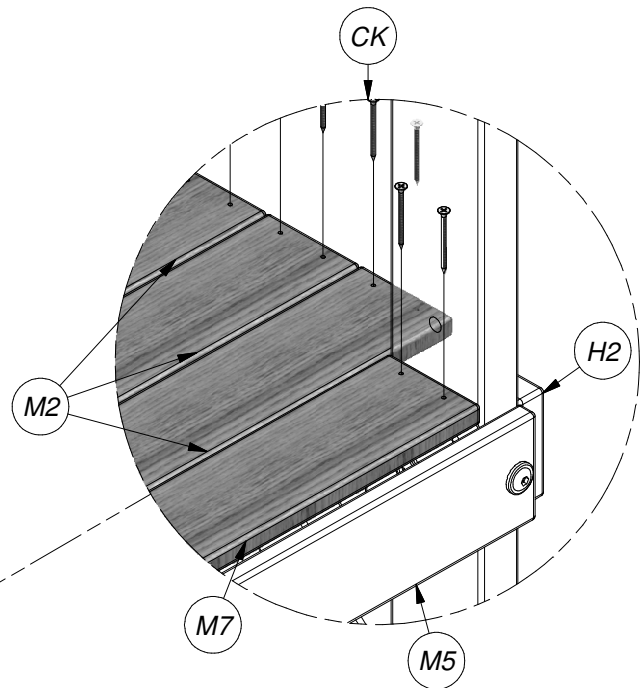
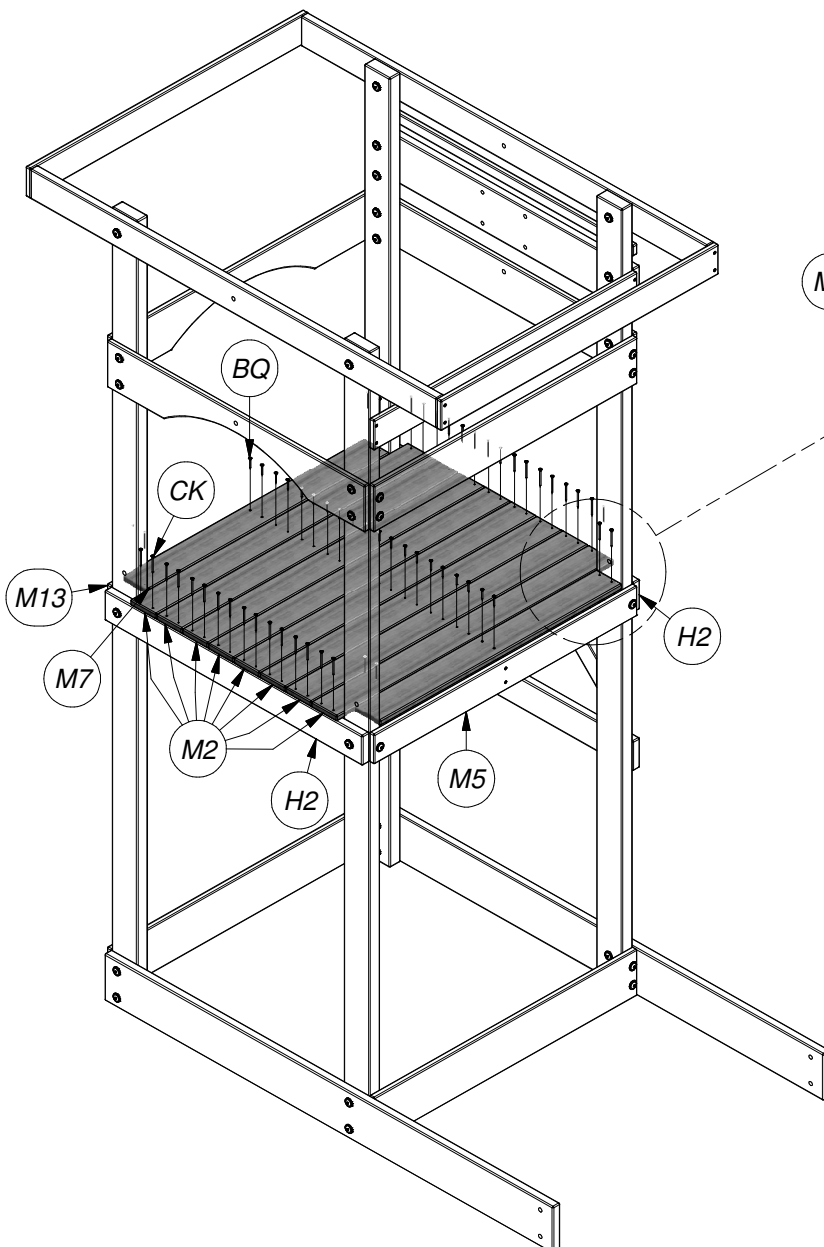

**Step 1:** Gather the (2) 'M7' Floor Boards & (8) 'M2' Floor Boards and arrange them on floor supports, as shown. Pre-drill and secure each floor board using Screws 'CK' (outside) & 'BQ' (middle), as shown.

**Note:** Do not overtighten screws, overtightening may cause the screw to stick through the boards and may cause sharp points. The head of the screw should NOT sink into the wood for this phase, it should be flush.

# Fort Assembly

## Phase 6

### Parts needed:

- (2) M11 - WALL RAIL - W101527
- (2) M10 - WALL RAIL - W101621
- (1) M6 - WALL RAIL - W101523
- (1) H2 - FLOOR JOIST - W101521

### Phase Notes

- Assemble with hardware as shown.



**Note:** It is vital that the fort be level before and after each phase of assembly.

### Hardware needed:

- (2) K - BOLT WH 5/16x2 - H100012
- (8) AC - WASHER LOCK EXT 8x19 - H100030
- (4) AD - WASHER LOCK EXT 12x19 - H100031
- (4) D - NUT BARREL WH 5/16x7/8 - H100005
- (2) H - BOLT WH 5/16x1-1/2 - H100010
- (4) Z - LAG SCREW WH 5/16x2 - H100027

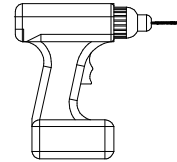

To prevent board splitting, you must pre-drill each board with a 1/8" drill bit, before attaching.

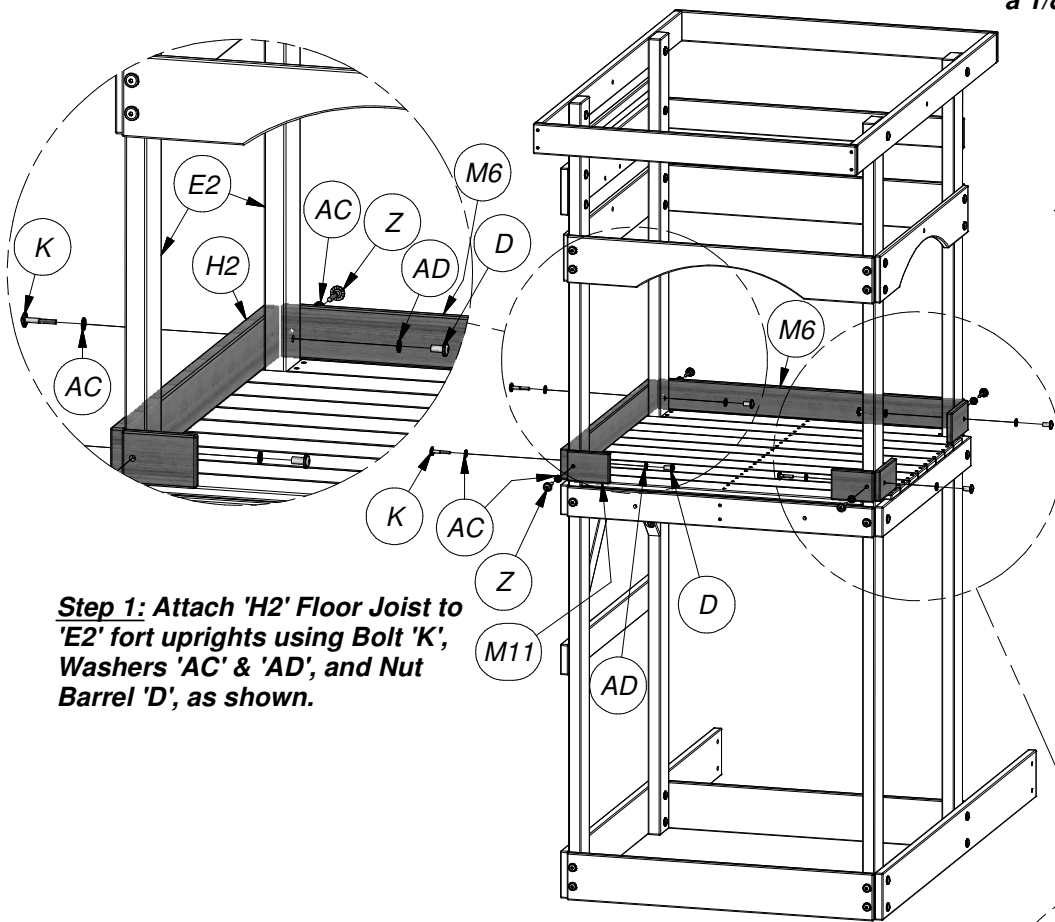

**Step 1:** Attach 'H2' Floor Joist to 'E2' fort uprights using Bolt 'K', Washers 'AC' & 'AD', and Nut Barrel 'D', as shown.

**Step 2:** Attach 'M6' Wall Rail to the edges of 'E1' & 'E2' fort uprights using Lag Screw 'Z', Washers 'AC', as shown.

**Step 4:** Attach 'M11' Wall Rails to the edges of 'E1' & 'E2' fort uprights using Lag Screw 'Z', Washers 'AC', as shown.

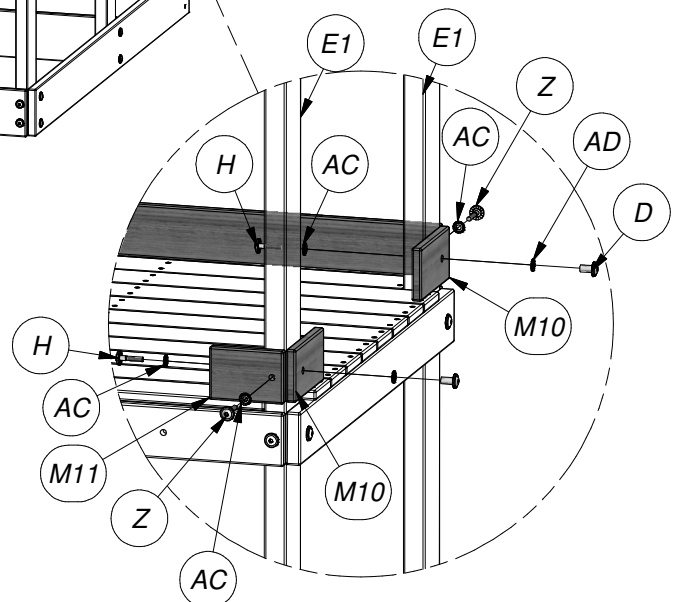

**Step 3:** Attach 'M10' Wall Rails to 'E1' fort uprights using Bolt 'H', Washers 'AC' & 'AD', and Nut Barrel 'D', as shown.

# Fort Assembly

## Phase 7

### Parts needed:

- (2) H6 - WALL SLAT - W101535
- (2) EJ - L BRACKET GREEN - A100053

### Hardware needed:

- (8) BQ - SCREW PFH 8x1-1/4 - H100087
- (4) BL - SCREW TAPPING 14x3/4 - H100083

### Phase Notes

- Assemble with hardware as shown.

**Note:** Do not overtighten screws, overtightening may cause the screw to stick through the boards and may cause sharp points. The head of the screw should NOT sink into the wood for this phase, it should be flush.

**Note:** Due to the changing size of the wood as a result of moisture content, you may need to adjust the spacing of your wall slats 1/16" to 1/8" when assembling walls. It would be best to line up the boards on the wall before attaching to estimate if a larger or smaller gap is needed.

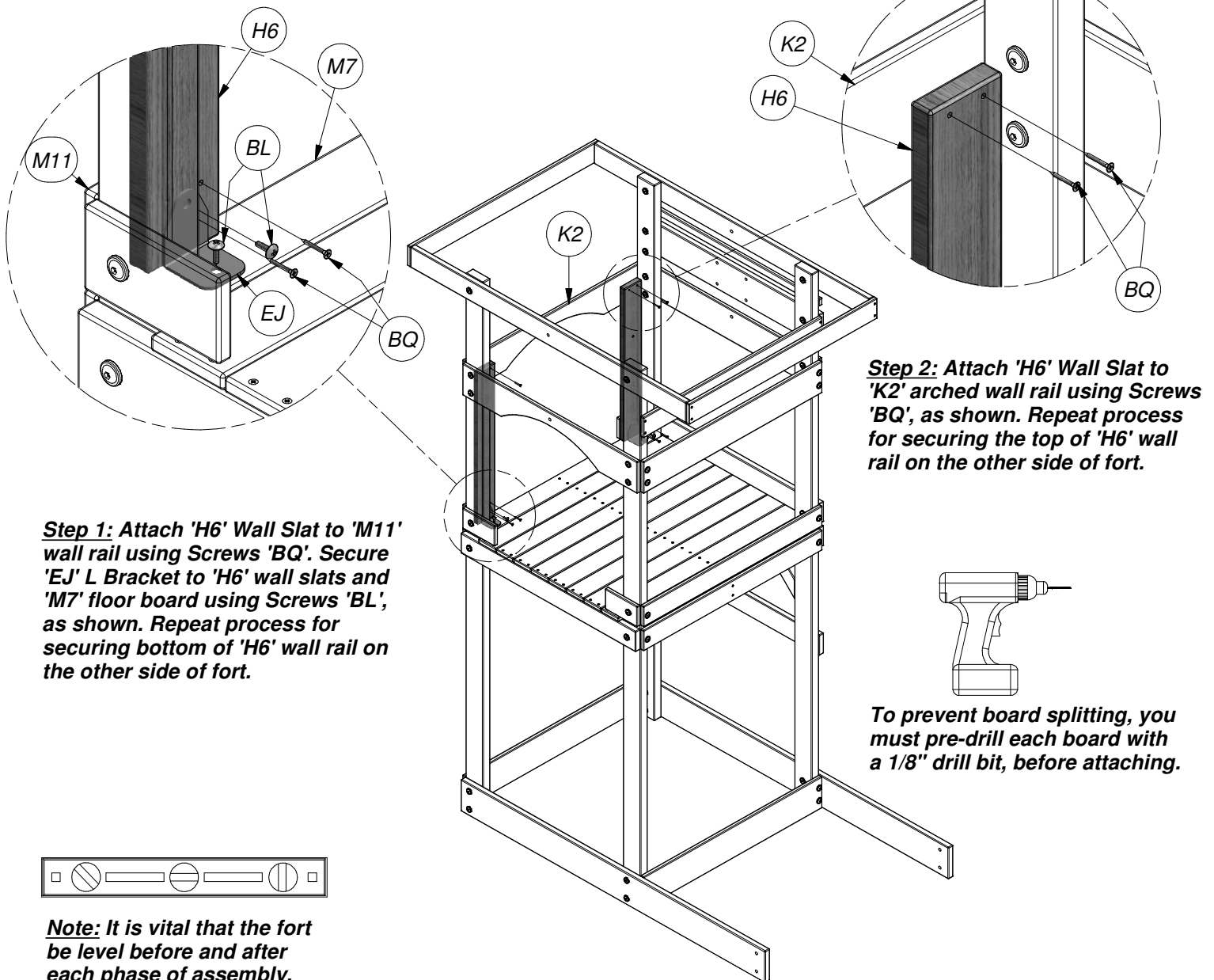

**Step 1:** Attach 'H6' Wall Slat to 'M11' wall rail using Screws 'BQ'. Secure 'EJ' L Bracket to 'H6' wall slats and 'M7' floor board using Screws 'BL', as shown. Repeat process for securing bottom of 'H6' wall rail on the other side of fort.

**Step 2:** Attach 'H6' Wall Slat to 'K2' arched wall rail using Screws 'BQ', as shown. Repeat process for securing the top of 'H6' wall rail on the other side of fort.

To prevent board splitting, you must pre-drill each board with a 1/8" drill bit, before attaching.



**Note:** It is vital that the fort be level before and after each phase of assembly.

# Fort Assembly

## Phase 8

### Parts needed:

- (4) M12 - WALL SLAT - A101536

### Phase Notes

- Assemble with hardware as shown.



**Note:** It is vital that the fort be level before and after each phase of assembly.

### Hardware needed:

- (8) BR - SCREW PFH 8x1-1/8 - H100088
- (8) BQ - SCREW PFH 8x1-1/4 - H100087

**Note:** Do not overtighten screws, overtightening may cause the screw to stick through the boards and may cause sharp points. The head of the screw should NOT sink into the wood for this phase, it should be flush.

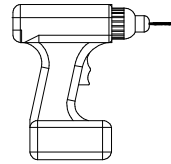

To prevent board splitting, you must pre-drill each board with a 1/8" drill bit, before attaching.

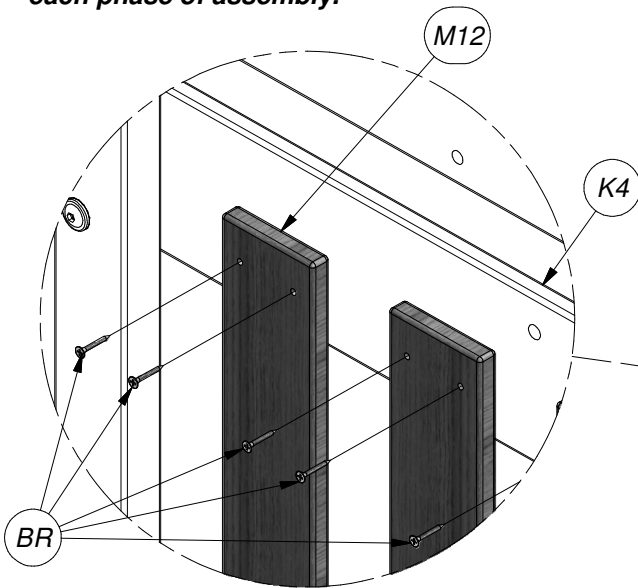

**Step 1:** Attach 'M12' Wall Slats to 'K4' wall rail using Screws 'BR', as shown.

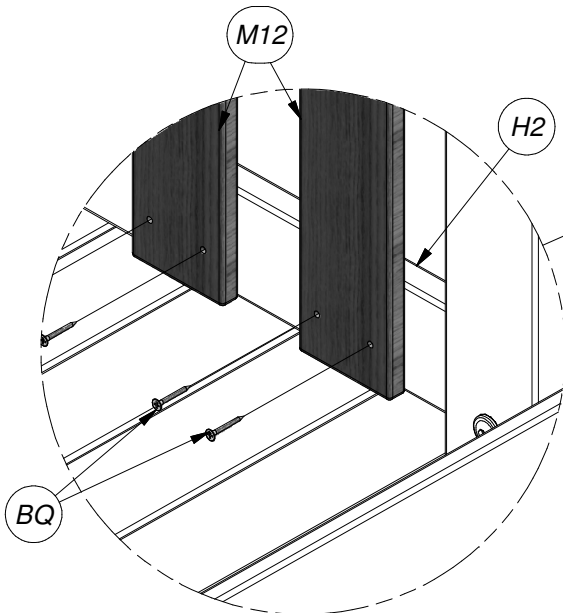

**Step 2:** Attach 'M12' Wall Slats to 'H2' floor joist using Screws 'BQ', as shown.

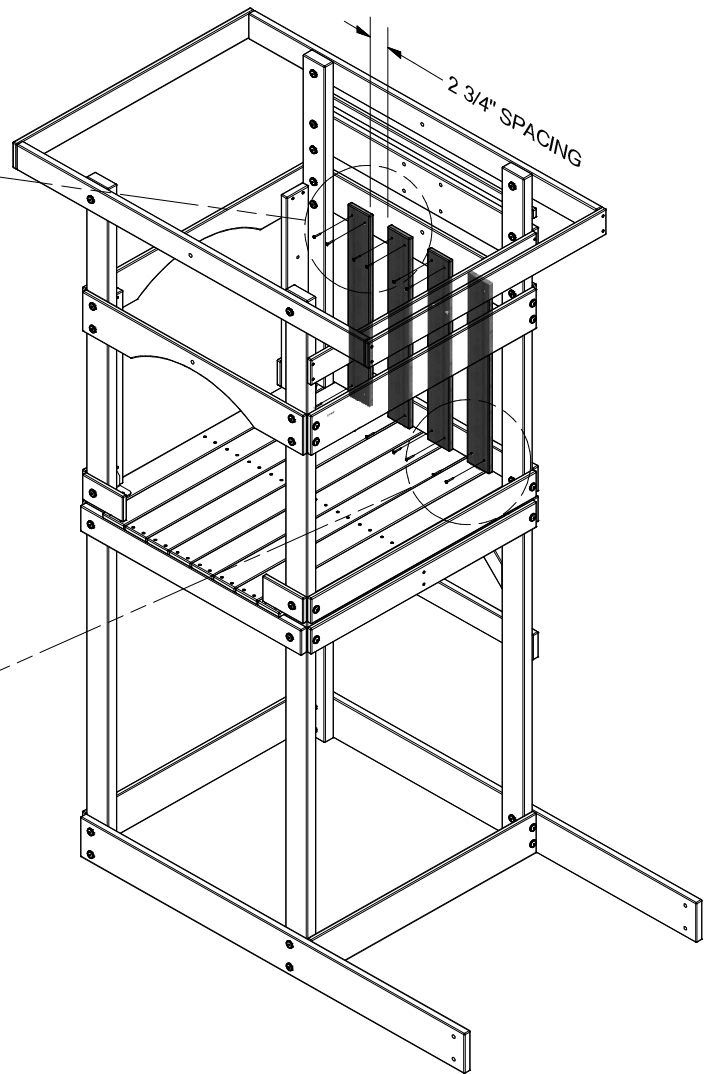

**Note:** Due to the changing size of the wood as a result of moisture content, you may need to adjust the spacing of your wall slats 1/16" to 1/8" when assembling walls. It would be best to line up the boards on the wall before attaching to estimate if a larger or smaller gap is needed.

# Fort Assembly

## Phase 9

### Parts needed:

- (5) M12 - WALL SLAT - W101536
- (2) J1 - WALL SLAT - W101622
- (2) EJ - L BRACKET GREEN - A100053

### Phase Notes

- Assemble with hardware as shown.

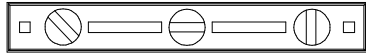

**Note:** It is vital that the fort be level before and after each phase of assembly.

### Hardware needed:

- (20) BR - SCREW PFH 8x1-1/8 - H100088
- (8) BQ - SCREW PFH 8x1-1/4 - H100087
- (4) BL - SCREW TAPPING 14x3/4 - H100083

**Note:** Do not overtighten screws, overtightening may cause the screw to stick through the boards and may cause sharp points. The head of the screw should NOT sink into the wood for this phase, it should be flush.

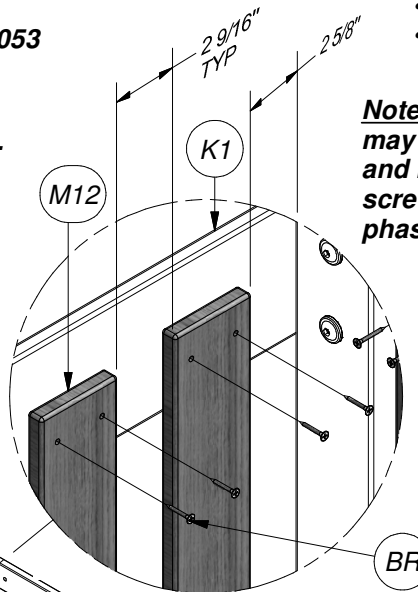

**Step 1:** Attach 'M12' Wall Slats to 'K1' wall rail using Screws 'BR', as shown.

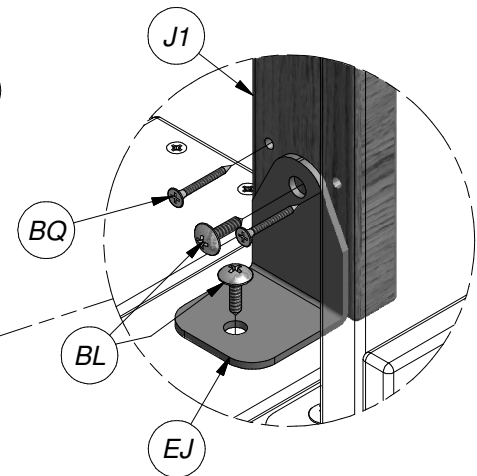

**Step 3:** Attach 'J1' Wall Slat to 'K3' arched wall rail & 'M10' wall rail using Screws 'BQ'. Secure 'EJ' L Bracket to 'J1' wall slats and 'M2' floor board using Screws 'BL', as shown. Repeat process for securing bottom of second 'J1' wall rail on the other side of fort.

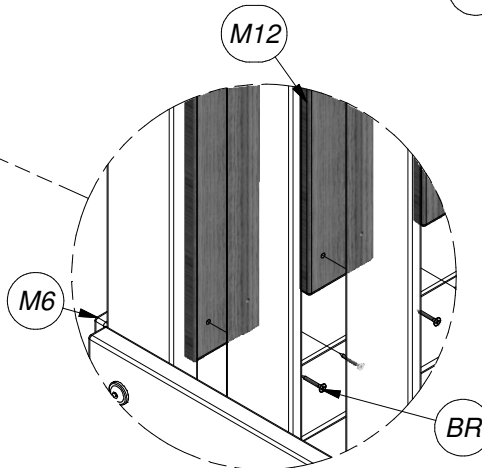
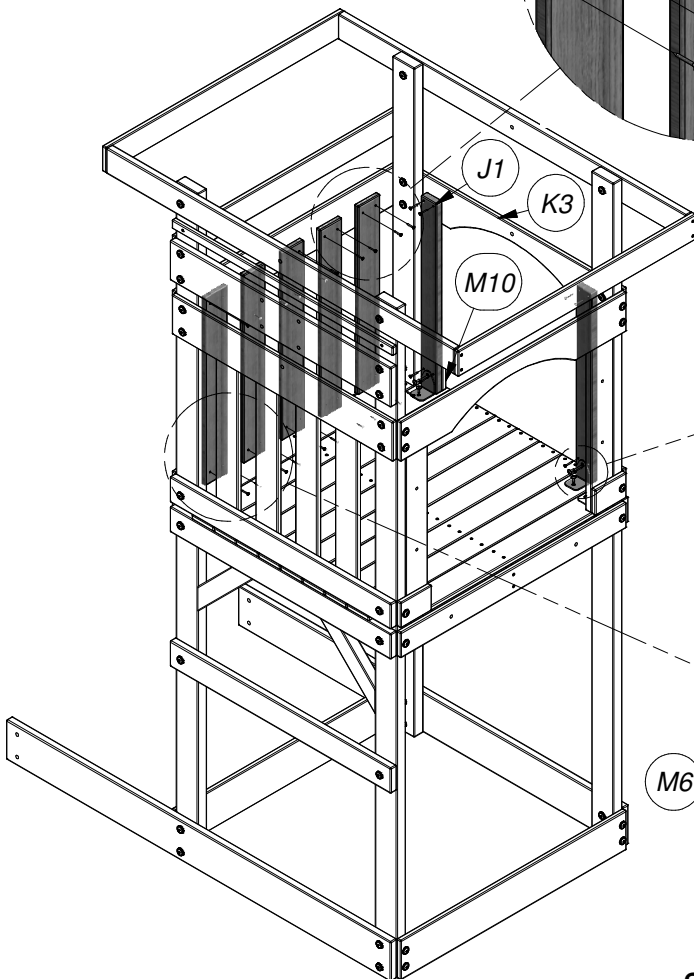

**Step 2:** Attach 'M12' Wall Slats to 'M6' wall rail using Screws 'BR', as shown.

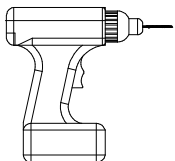

To prevent board splitting, you must pre-drill each board with a 1/8" drill bit, before attaching.

**Note:** Due to the changing size of the wood as a result of moisture content, you may need to adjust the spacing of your wall slats 1/16" to 1/8" when assembling walls. It would be best to line up the boards on the wall before attaching to estimate if a larger or smaller gap is needed.

# Fort Assembly

## Phase 10

### Parts needed:

- (2) H5 - PICNIC TARP SUPPORT - W101542
- (1) M3 - TARP SUPPORT - W101539

### Hardware needed:

- (2) Z - LAG SCREW WH 5/16x2 - H100027
- (2) AC - WASHER LOCK EXT8x19 - H100030
- (4) CK - SCREW PFH 8x2 - H100111

### Phase Notes

- Assemble with hardware as shown.

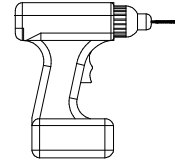

To prevent board splitting, you must pre-drill each board with a 1/8" drill bit, before attaching.

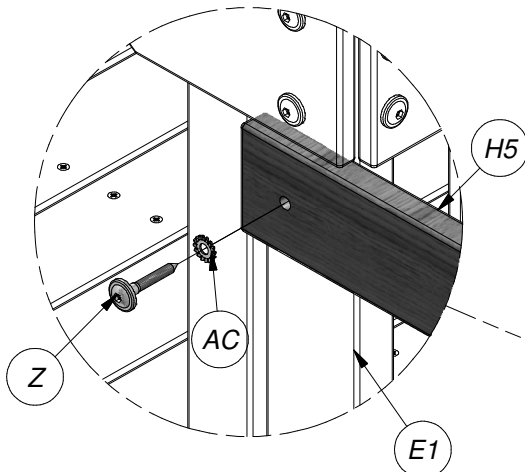

**Step 1:** Attach 'H5' Picnic Tarp Support to 'E1' & 'E2' fort uprights using Lag Screws 'Z' & Washer 'AC', as shown.

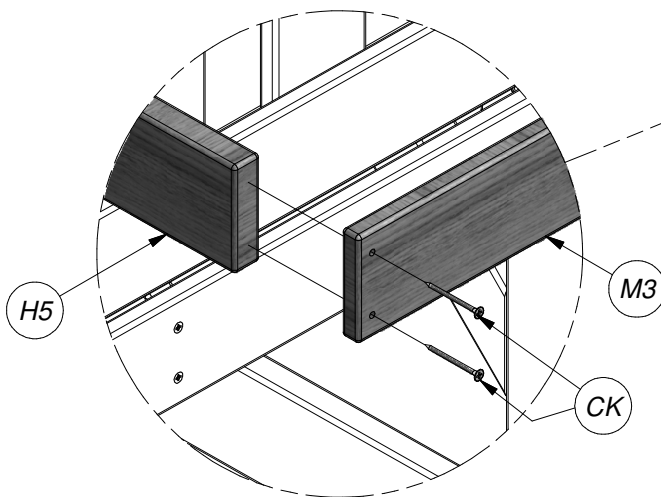
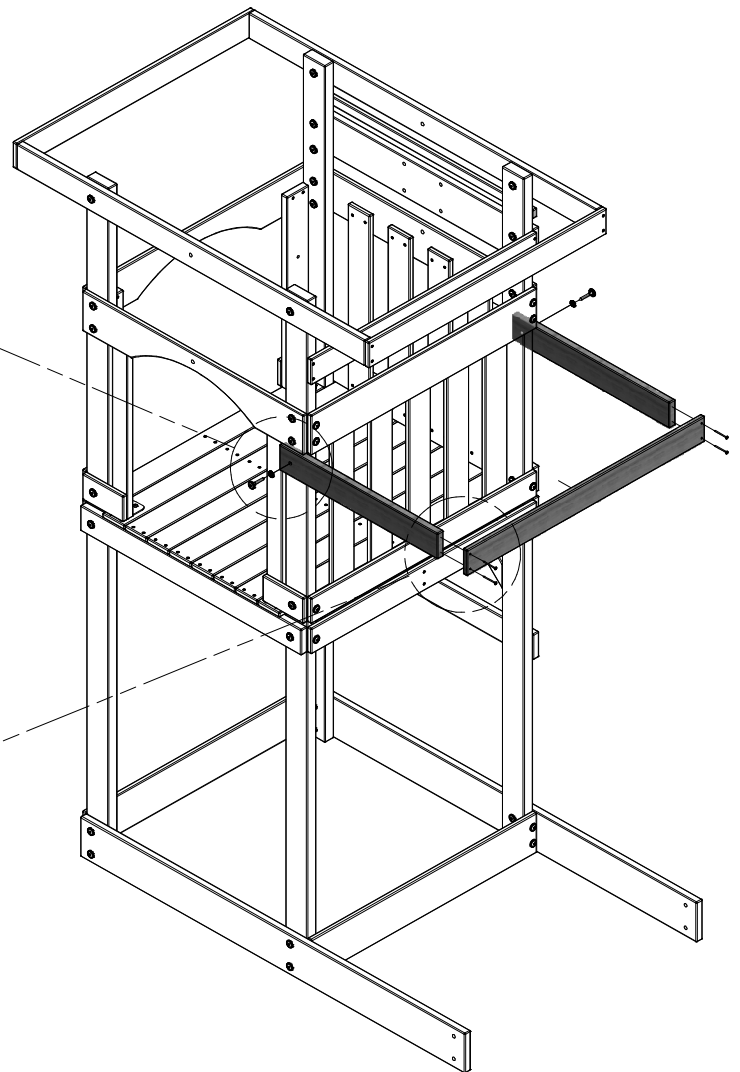

**Step 2:** Attach 'M3' Tarp Support to 'H5' Picnic Tarp Support using Screws 'CK', as shown.



**Note:** It is vital that the fort be level before and after each phase of assembly.

# Fort Assembly

## Phase 11

### Parts needed:

- (2) H8 - PICNIC SUPPORT - W101628
- (2) F2 - ANGLE BRACE - W101629
- (3) M2 - FLOOR BOARD - W101525
- (1) M8 - PICNIC CLEAT - W101632

### Hardware needed:

- (2) BG - T-NUT 5/16 - H100074
- (8) AC - WASHER LOCK EXT 8x19 - H100030
- (2) L - BOLT WH 5/16x2-1/4 - H100013
- (6) Z - LAG SCREW WH 5/16x2 - H100027
- (12) CK - SCREW PFH 8x2 - H100111
- (6) BR - SCREW PFH 8x1-1/8 - H100088

### Phase Notes

- Assemble with hardware as shown.

**Note:** Do not overtighten screws, overtightening may cause the screw to stick through the boards and may cause sharp points. The head of the screw should NOT sink into the wood for this phase, it should be flush.

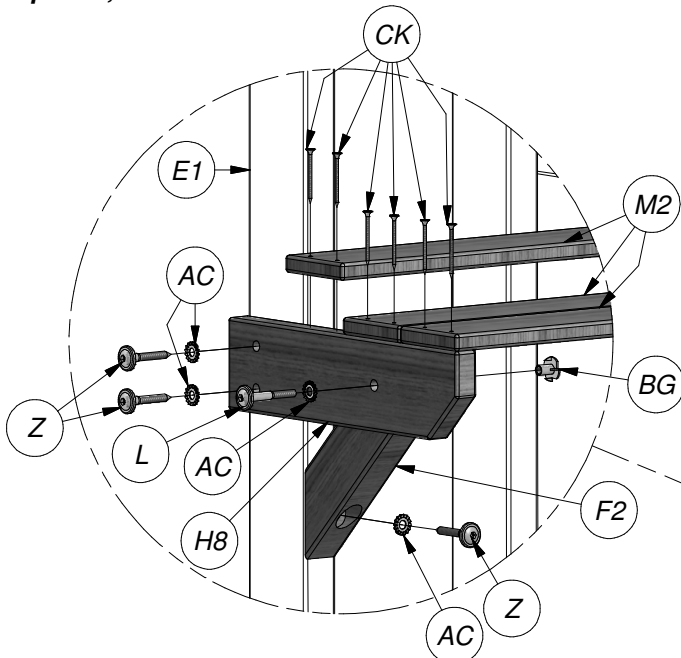

**Step 1:** Pre-drill and attach 'H8' Picnic Support to 'E1' & 'E2' fort uprights using Lag Screws 'Z' and Washer 'AC'. Attach 'F2' Angle Brace to 'H8' picnic support using Bolt 'L', Washers 'AC' and T-Nut 'BG'. (The T-Nuts will need to be inserted into the 'F2' angle brace before it is attached to the uprights.) Attach 'F2' angle brace to 'E1' fort upright using Lag Screws 'Z' and Washers 'AC', as shown. Repeat this process to attach the picnic support to the other side. Now, attach 'M2' Floor Boards to 'H8' picnic support using Screws 'CK', as shown.

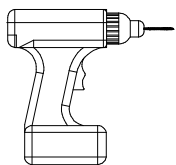
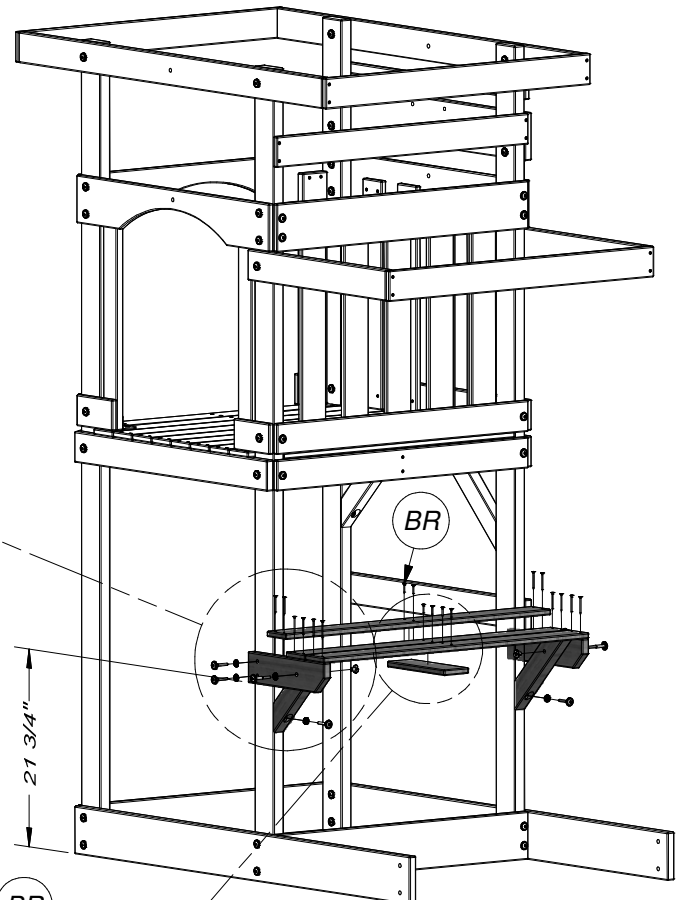

To prevent board splitting, you must pre-drill each board with a 1/8" drill bit, before attaching.

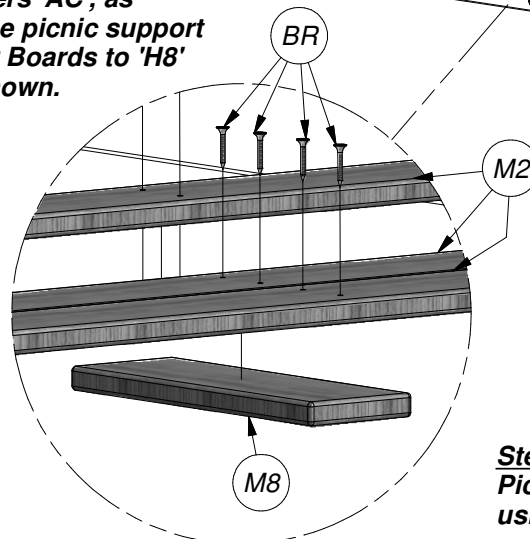

**Note:** It is vital that the fort be level before and after each phase of assembly.

**Step 2:** Pre-drill and attach 'M8' Picnic Cleat to 'M2' floor board using Screws 'BR', as shown.



# Fort Assembly

## Phase 12

### Parts needed:

- (2) H7 - PICNIC SUPPORT - W101625
- (2) G3 - PICNIC SUPPORT - W101627
- (2) H9 - PICNIC SUPPORT - W101626
- (2) M2 - FLOOR BOARD - W101525
- (1) M9 - PICNIC CLEAT - W101633

### Phase Notes

- Assemble with hardware as shown.

**Note:** Do not overtighten screws, overtightening may cause the screw to stick through the boards and may cause sharp points. The head of the screw should NOT sink into the wood for this phase, it should be flush.

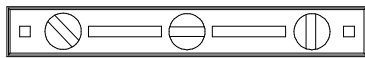

**Note:** It is vital that the fort be level before and after each phase of assembly.

### Hardware needed:

- (8) D - NUT BARREL WH 5/16x7/8 - H100005
- (8) AD - WASHER LOCK EXT12x19 - H100031
- (8) AC - WASHER LOCK EXT8x19 - H100030
- (8) H - BOLT WH 5/16x1-1/2 - H100010
- (6) BS - SCREW PFH 8x1-3/4 - H100089
- (8) CK - SCREW PFH 8x2 - H100111
- (4) BR - SCREW PFH 8x1-1/8 - H100088

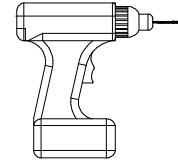

To prevent board splitting, you must pre-drill each board with a 1/8" drill bit, before attaching.

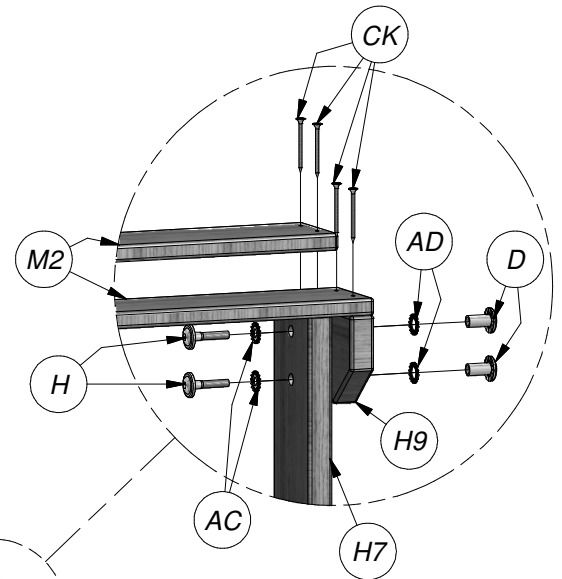
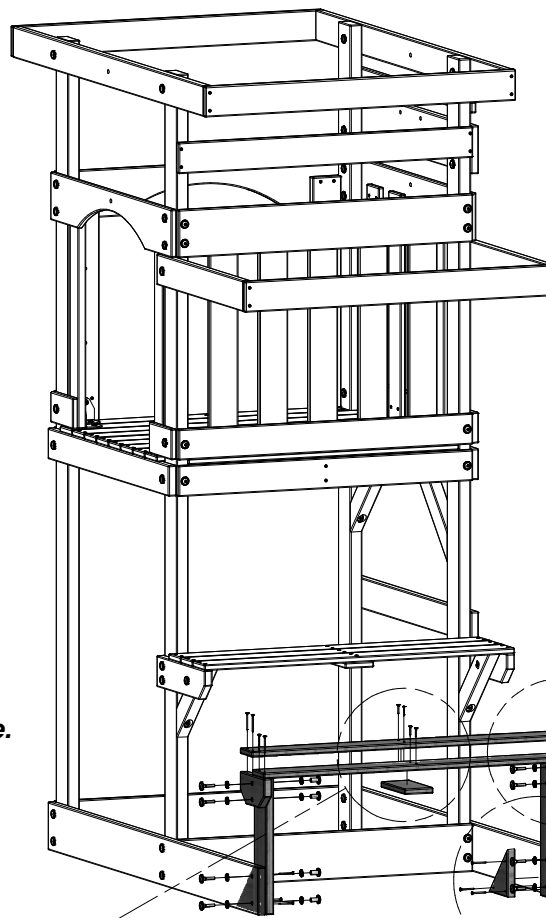

**Step 1:** Attach 'H7' Picnic Support to 'G1' ground board using "Safe-T-Fuse" hardware. Pre-drill & attach 'G3' Picnic Support to 'G1' ground board using Screws 'BS', as shown.

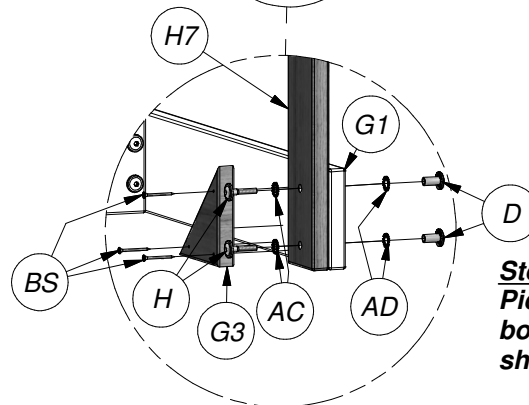
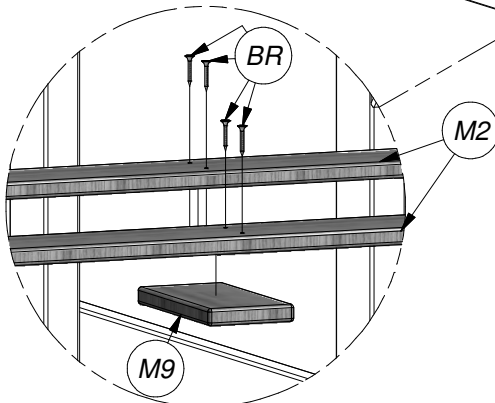

**Step 2:** Attach 'H9' Picnic Support to 'H7' picnic support using "Safe-T-Fuse" hardware. Attach 'M2' floor boards to 'H9' picnic support using Screws 'CK', as shown.

**Step 3:** Pre-drill & attach 'M9' Picnic Cleat to 'M2' floor board using Screws 'BR', as shown.

# Fort Assembly

## Phase 13

### Parts needed:

- (2) M1 - TARP SUPPORT - W101540
- (1) M4 - FLOOR / TARP SUPPORT - W101541

### Phase Notes

- Assemble with hardware as shown.

### Hardware needed:

- (2) B - NUT BARREL WH 5/16x5/8 - H100004
- (2) D - NUT BARREL WH 5/16x7/8 - H100005
- (4) AD - WASHER LOCK EXT12x19 - H100031
- (4) AC - WASHER LOCK EXT8x19 - H100030
- (4) F - BOLT WH 5/16x1 - H100008
- (4) BP - SCREW PFH 8x1-1/2 - H100086



**Note:** It is vital that the fort be level before and after each phase of assembly.

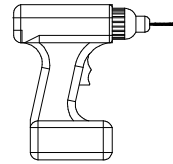

To prevent board splitting, you must pre-drill each board with a 1/8" drill bit, before attaching.

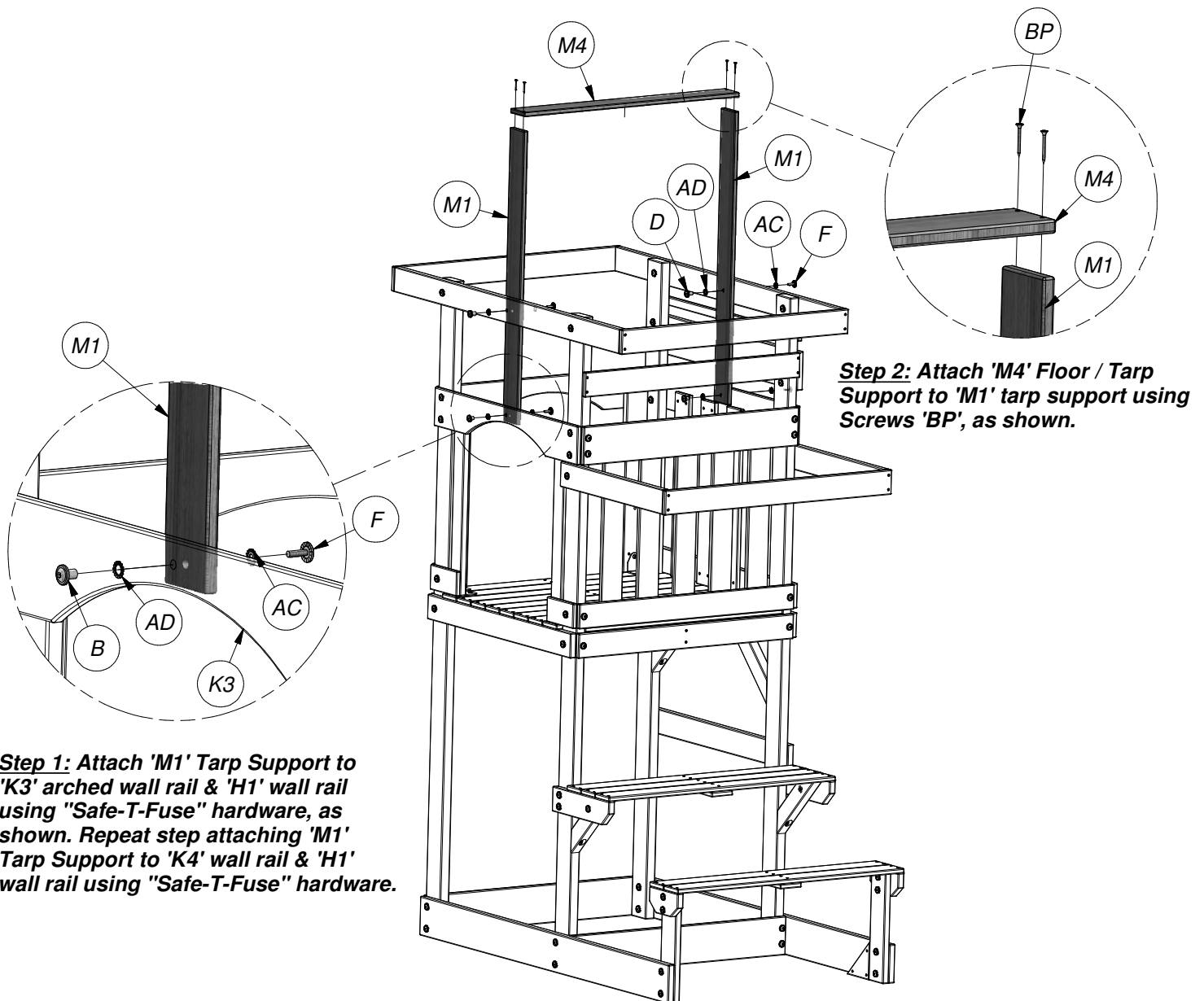

**Step 2:** Attach 'M4' Floor / Tarp Support to 'M1' tarp support using Screws 'BP', as shown.

**Step 1:** Attach 'M1' Tarp Support to 'K3' arched wall rail & 'H1' wall rail using "Safe-T-Fuse" hardware, as shown. Repeat step attaching 'M1' Tarp Support to 'K4' wall rail & 'H1' wall rail using "Safe-T-Fuse" hardware.

# Fort Assembly

## Phase 14

### Parts needed:

- (1) KC - ROOF TARP - A100196

### Hardware needed:

- (6) CY - SCREW PWH 8x5/8 - H100128

### Phase Notes

- Assemble with hardware as shown.

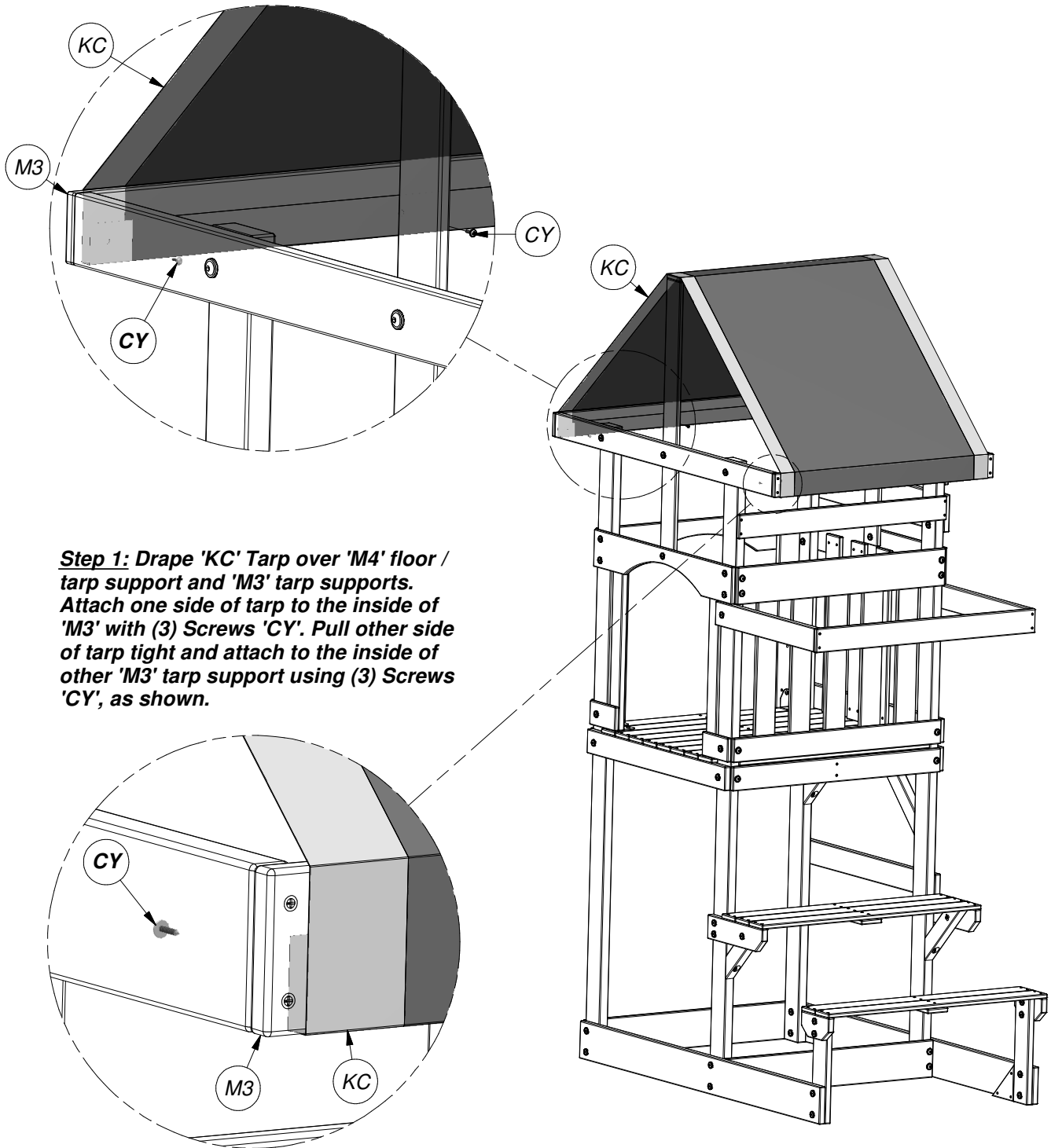

# Fort Assembly

## Phase 15

### Parts needed:

- (1) KB - PICNIC TABLE TARP - A100195

### Hardware needed:

- (6) CY - SCREW PWH 8x5/8 - H100128

### Phase Notes

- Assemble with hardware as shown.

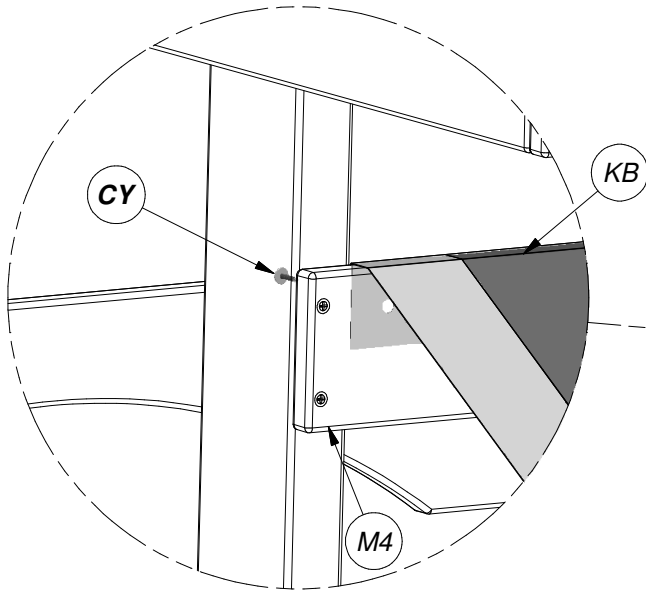

**Step 1:** Drape 'KB' Tarp over 'M4' floor / tarp support and 'M3' tarp supports. Attach one side of tarp to the inside of 'M3' with (3) Screws 'CY'. Pull other side of tarp tight and attach to the inside of 'M4' tarp support using (3) Screws 'CY', as shown.

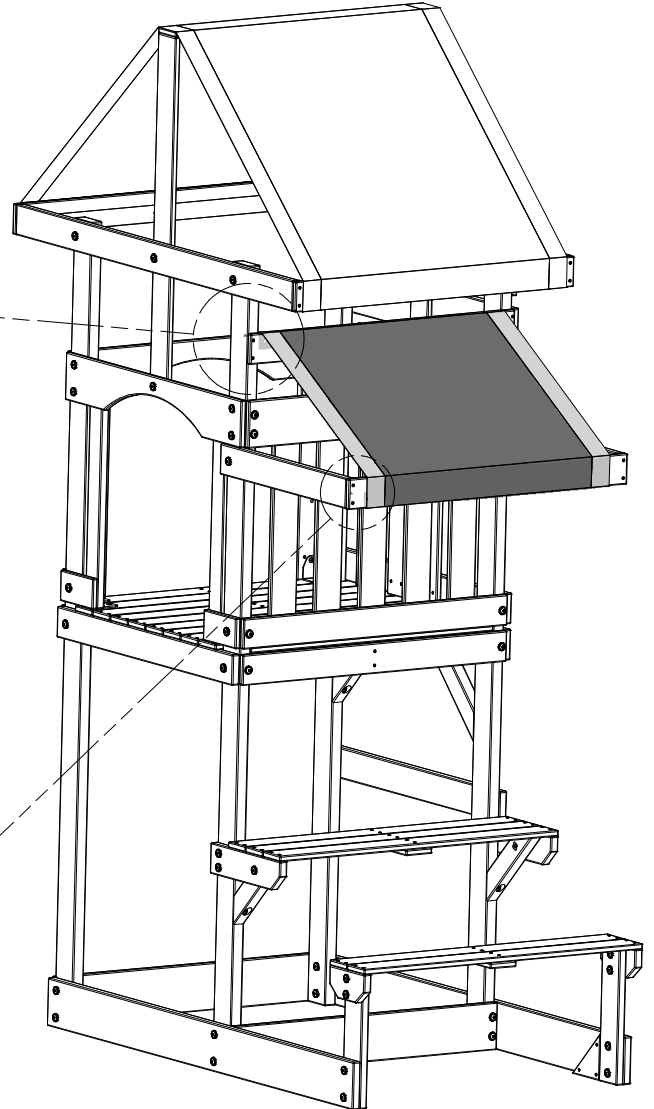
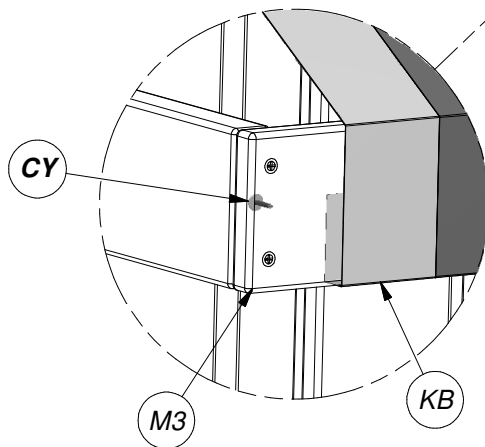

# Fort Assembly

## Phase 16

### Parts needed:

- (2) EA - HAND GRIP YELLOW PLASTIC - A100043

### Hardware needed:

- (4) AZ - BOLT PTH 1/4x1-1/4 - H100062
- (4) CG - WASHER LOCK EXT 8x15 - H100108
- (4) CE - WASHER FLAT 9x18 - H100106
- (4) BE - T-NUT 1/4 - H100072

### Phase Notes

- Assemble with hardware as shown.

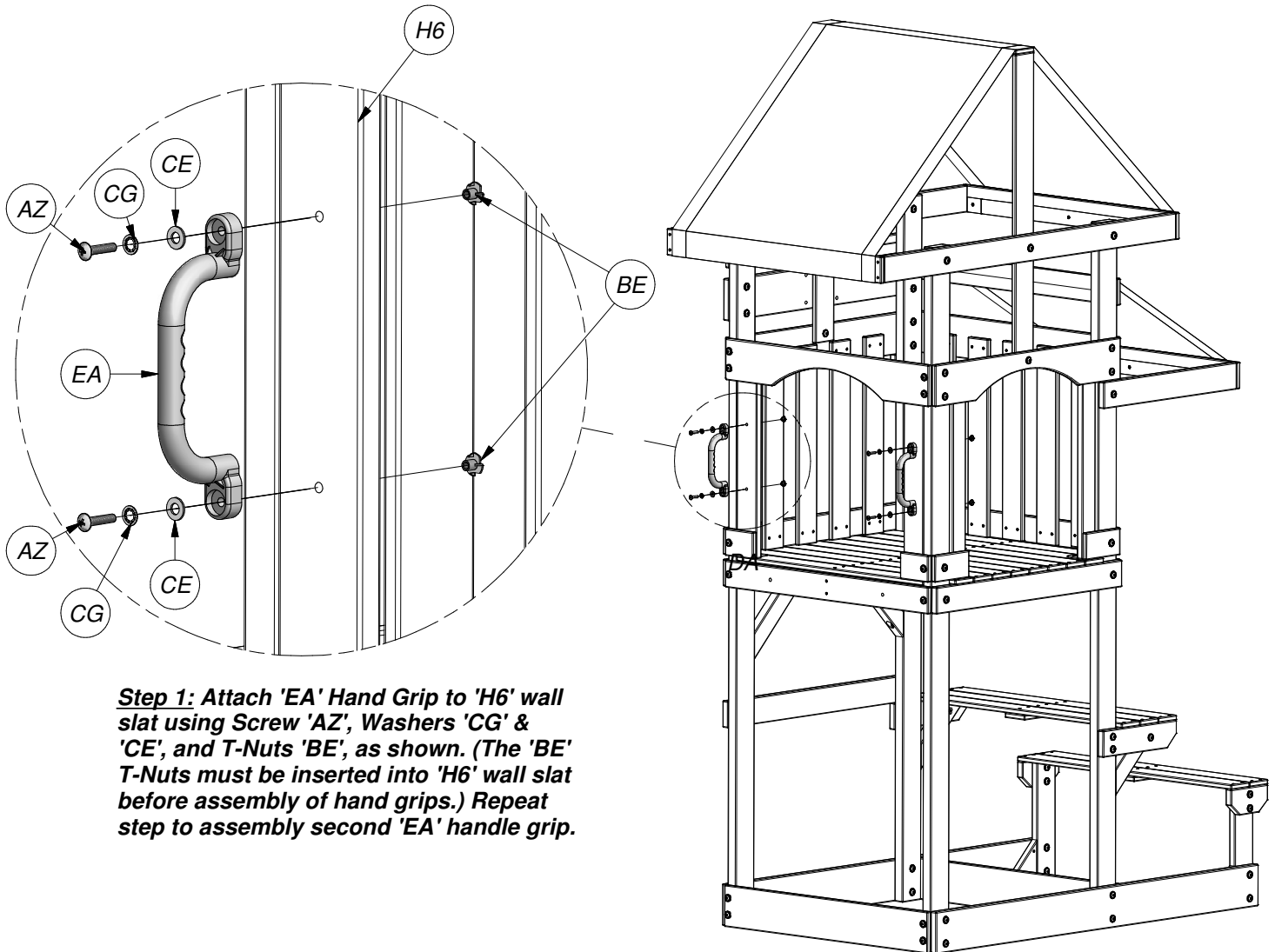

**Step 1: Attach 'EA' Hand Grip to 'H6' wall slat using Screw 'AZ', Washers 'CG' & 'CE', and T-Nuts 'BE', as shown. (The 'BE' T-Nuts must be inserted into 'H6' wall slat before assembly of hand grips.) Repeat step to assembly second 'EA' handle grip.**

# Rock Ladder Attachment

## Phase 17

### Parts needed:

- (1) ROCK WALL LADDER ASSEMBLY

### Hardware needed:

- (2) AA - LAG SCREW WH 5/16x2-1/2 - H100028
- (2) AC - WASHER LOCK EXT 8x19 - H100030

### Phase Notes

- Assemble with hardware as shown.

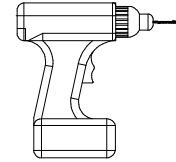

To prevent board splitting, you must pre-drill each board with a 1/8" drill bit, before attaching.

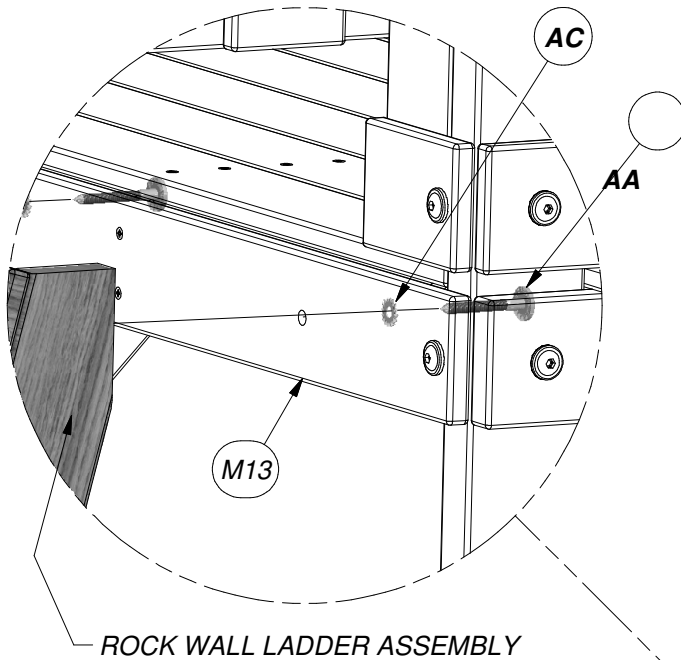

**Step 1:** Using 'M13' as a guide, pilot drill the ladder rails using a 1/8" drill bit and attach the Rock Wall Ladder to 'M13' wall rail using Lag Screws 'AA' & Washers 'AC', as shown.

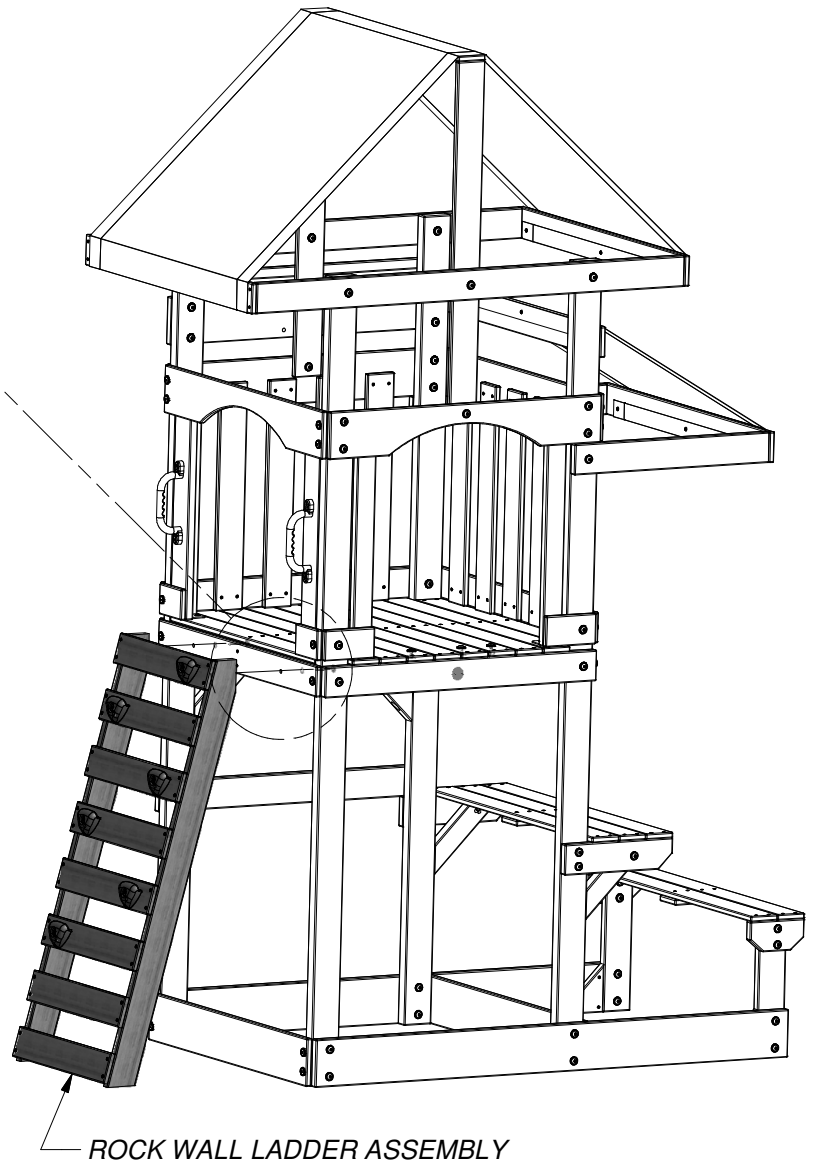
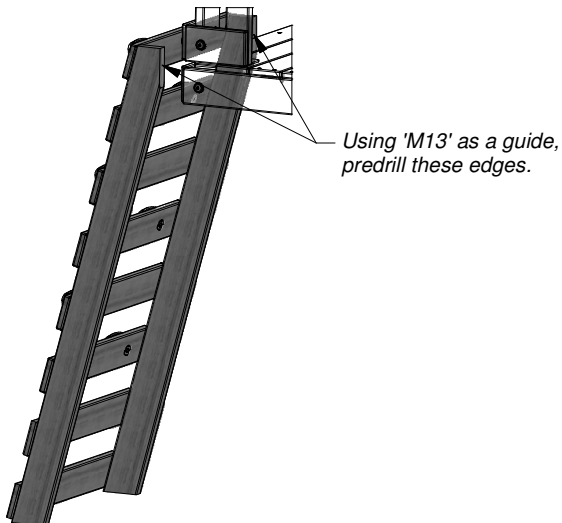

# Slide Attachment

## Phase 18

### Parts needed:

- (1) SLIDE ASSEMBLY

### Phase Notes

- Assemble with hardware as shown.

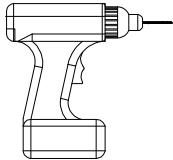

To prevent board splitting, you must pre-drill each board with a 1/8" drill bit, before attaching.

### Hardware needed:

- (3) BG - T-NUT 5/16 - H100074
- (3) CM - BOLT WH 5/16x1/2 - H100115

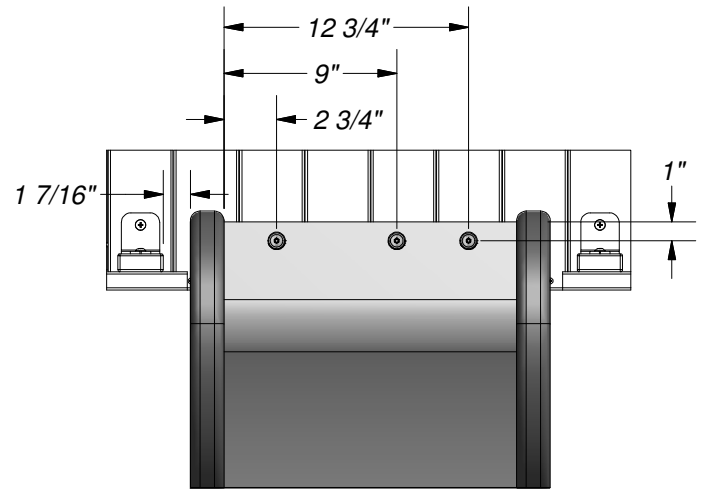

**DRILLING DIAGRAM**

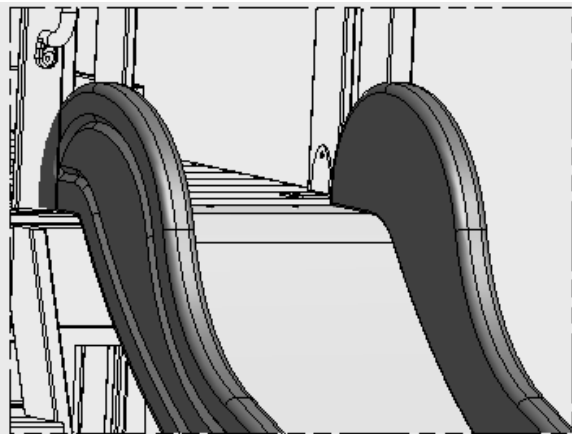

**Step 1:** Center the wave slide assembly in the opening opposite the swing beam assembly, as shown.

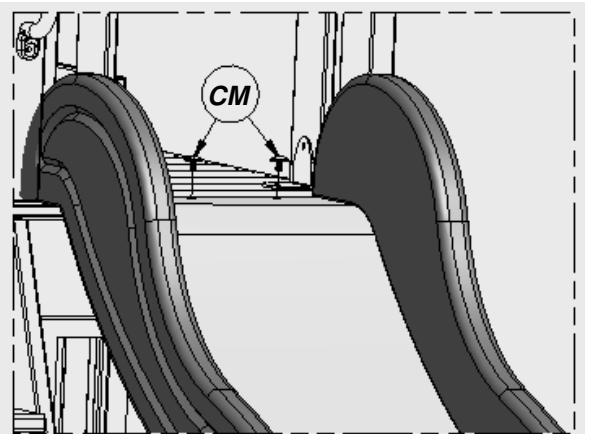

**Step 2:** Using a drill with a 5/16" bit, drill (3) holes through the slide and through the fort floor boards.

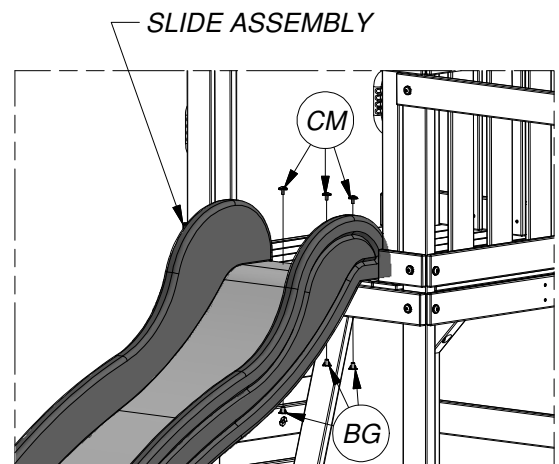
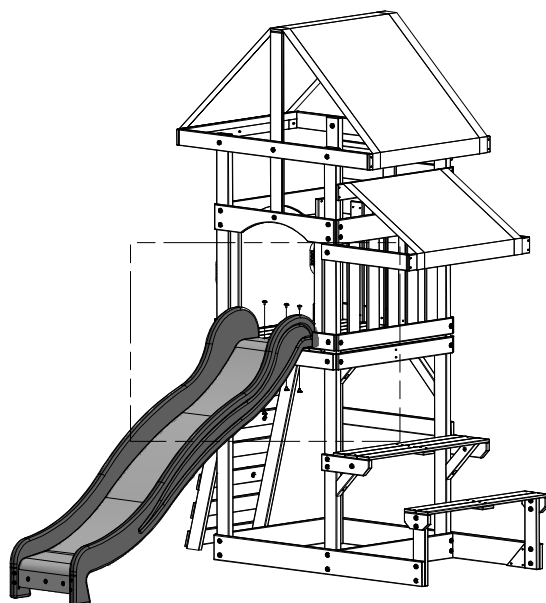

**Step 3:** Attach the Slide Assembly to the fort floor using hardware, as shown.

# Swing Beam Attachment

## Phase 19

### Parts needed:

- (1) SWING BEAM ASSEMBLY
- (1) HC - BACKYARD DISCOVERY ID TAG - A100164
- (1) SR - "B" REVISION TAG - A100315

### Hardware needed:

- (4) BG - T-NUT 5/16 - H100074
- (4) BX - WASHER SPLIT 5/16 - H100095
- (4) CD - WASHER FLAT 8x27 - H100105
- (4) AJ - BOLT HEX 5/16x1-1/4 - H100042
- (6) CY - SCREW PFH 8x5/8 - H100128

### Phase Notes

- Assemble with hardware as shown.

**Step 1:** Attach the Swing Beam Assembly to 'G2' Swing Beam Support using Bolts 'AJ', Washer 'BX' & Washer 'CD' through the 'GD' angle brackets & 'G2' swing beam support and into T-Nuts 'BG' that will need to be hammered in the holes on the backside of 'G2', as shown.

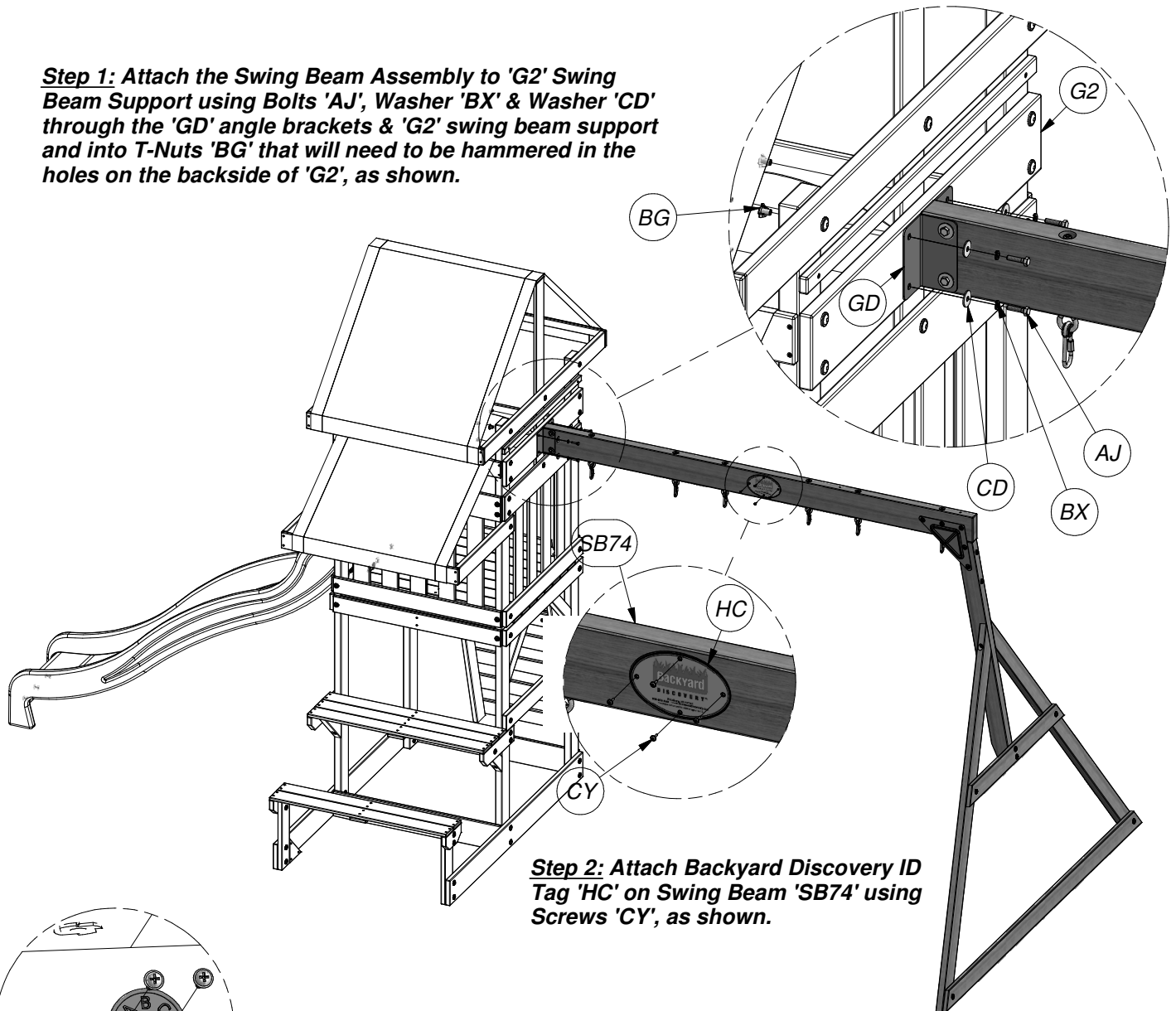

**Step 2:** Attach Backyard Discovery ID Tag 'HC' on Swing Beam 'SB74' using Screws 'CY', as shown.

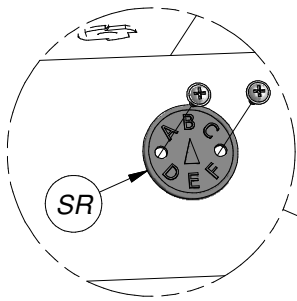

**Step 3:** Attach 'SR' "B" Revision Tag to the back side of 'H2' Floor Joist using Screws 'CY', as shown.

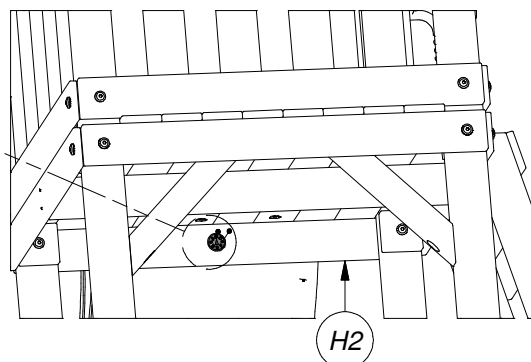



# Anchoring Instructions

## Phase 20

### Parts needed:

- (6) KD - PLASTIC GROUND STAKE BROWN - A100179
- (6) FA - QUICK LINK - A100069
- (4) EZ - CHAIN GREEN 51.25" - A100068
- (2) FB - SWING SEAT YELLOW - A100070
- (2) FW - CHAIN GREEN 31" - A100177
- (1) KF - PLASTIC TRAPEZE BAR YELLOW - A6P00034

### Hardware needed:

- (6) CK - SCREW PFH 8x2 - H100111

### Phase Notes

- Assemble with hardware as shown.
- Install the screw into the upright so that the tip of the screw does not stick through. Make sure you have enough wood to accommodate the screw before installing.
- FAILURE TO USE STAKES CAN VOID WARRANTY & CAUSE INJURY!

**Step 2:** Attach Swing Seats 'FB' to swing beam using Quick Clip 'FA' and Chain 'EZ'.

**Step 3:** Attach Trapeze Bar 'KF' to swing beam using Chain 'FW'.

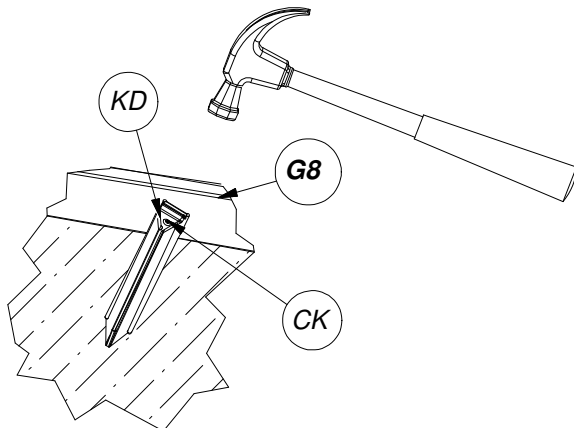
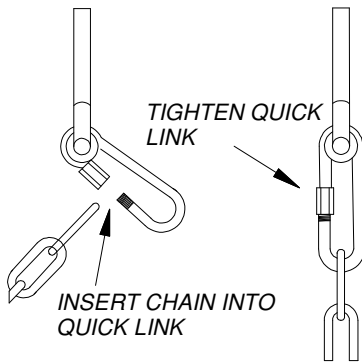

**Step 1:** Drive Stakes 'KD' into the ground against boards where shown and attach with Screws 'CK', as shown.

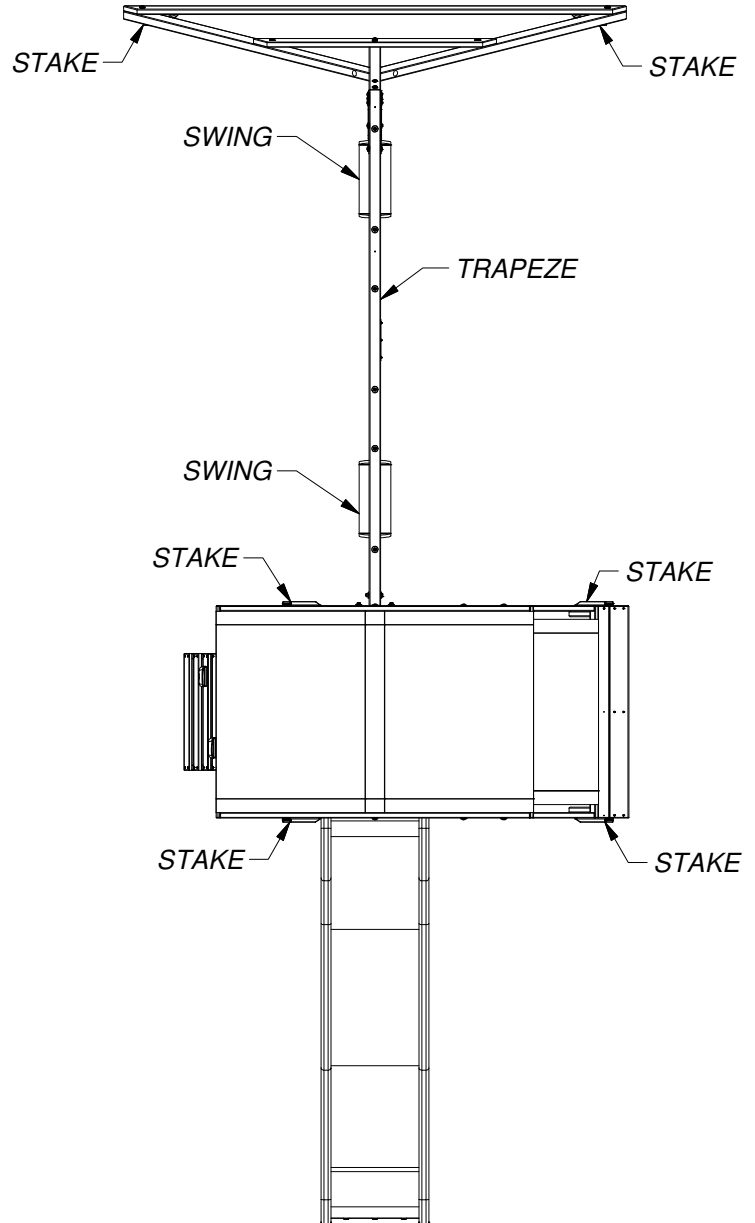

**Final Step:** Double check and make sure every bolt, screw and nut is tight. Make sure every board is secure. Make sure the fort is level and enjoy your swing set.

# WARRANTY

## AUSTRALIAN CONSUMER LAW

Many of our products come with a guarantee or warranty from the manufacturer. In addition, they come with guarantees that cannot be excluded under the Australian Consumer law. You are entitled to a replacement or refund for a major failure and compensation for any other reasonably foreseeable loss or damage.

You are entitled to have the goods repaired or replaced if the goods fail to be of acceptable quality and the failure does not amount to a major failure. Full details of your consumer rights may be found at [www.consumerlaw.gov.au](http://www.consumerlaw.gov.au)

Please visit our website to view our full warranty terms and conditions:

<http://www.lifespankids.com.au/Warranty-Policy-Kids>

Please send all warranty and support inquiries through our ticketing system via the email address:

[support@lifespankids.com.au](mailto:support@lifespankids.com.au).