

ACTIVEGO

AG003 ACTIVEGO RALLYSTRIKE OUTDOOR FOLDING TABLE TENNIS PING PONG TABLE

USER MANUAL

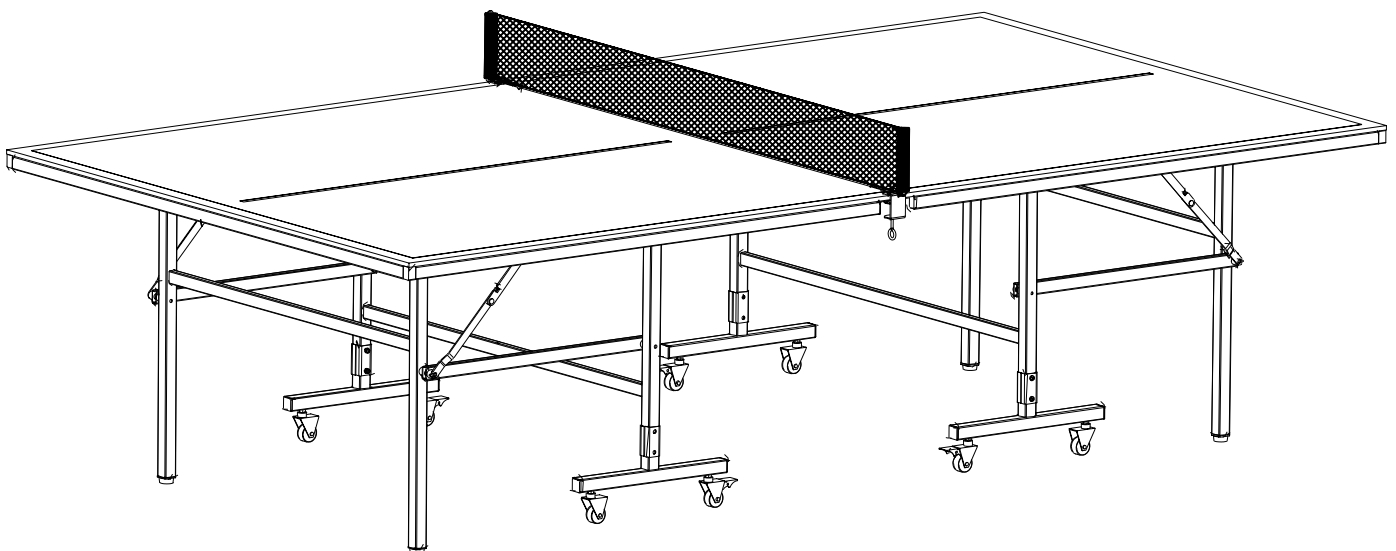
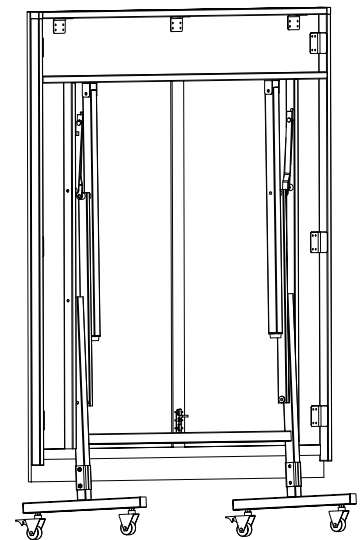
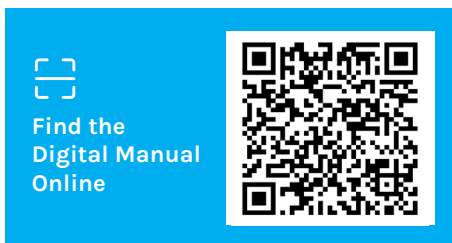

Product may vary slightly from the item pictured due to model upgrades.



**Read all instructions carefully before using this product.
Retain this owner's manual for future reference.**

NOTE:

This manual should not be used to guide your purchasing decision. Your product, and the contents inside its carton, may vary from what is listed in this manual. This manual may also be subject to updates or changes. Updated manuals are available through our website at www.lifespanfitness.com.au



TABLE OF CONTENTS

I. Care and Maintenance	03
II. Parts List	04
III. Assembly Instructions	05
IV. Folding Instructions	10
V. Warranty	12

I. CARE AND MAINTENANCE

Please keep this manual with you at all times.

- Seek assistance when required to move or fold the table for storage.
- Two pieces of the table must be separated before folding or opening.
- Move the table on its wheels and do not drag the table on the legs without wheels.
- Do not hit the table with your paddle as this can damage the surface.
- Do not place hot goods on the tabletop.
- Do not place heavy goods on the table to avoid distortion.
- Do not sit, stand, lean, walk or jump on the table. Failure to comply can result in personal injury and product damage.
- Do not use the table for any other exercise other than table tennis.
- Store the table indoors in a dry and well-ventilated area. Avoid storing it near sunlight to avoid warping. Storing outdoors is not recommended.
- Variances in external temperatures such as temperature and humidity may cause a distortion in the table as it expands or contracts. This is normal and should not cause concern as it does not detract from play or the utility value of the table.
- All wheels and feet can be adjusted slightly to ensure level playing surface.
- For cleaning the table, simply use a damp cloth to wipe down. Do not use any abrasive cleaners and ensure to dry off before storing away.
- Check hardware is tightened properly before using the table.

II. PARTS LIST

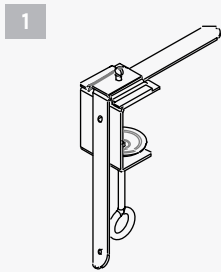

1

2pcs.

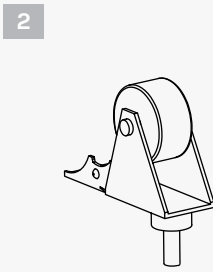

2

4pcs.

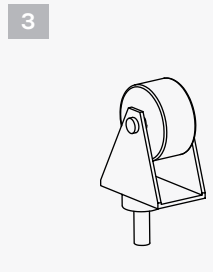

3

4pcs.

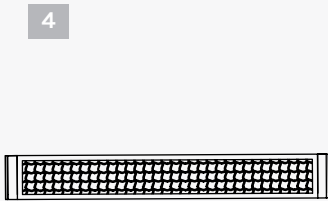

4

1pc.

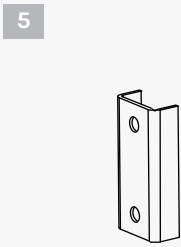

5

8pcs.

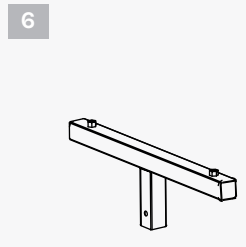

6

4pcs.



7

M6x45 - 8pcs.



8

M6 - 8pcs.

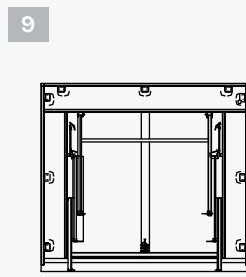

9

2pcs.

III. ASSEMBLY INSTRUCTIONS

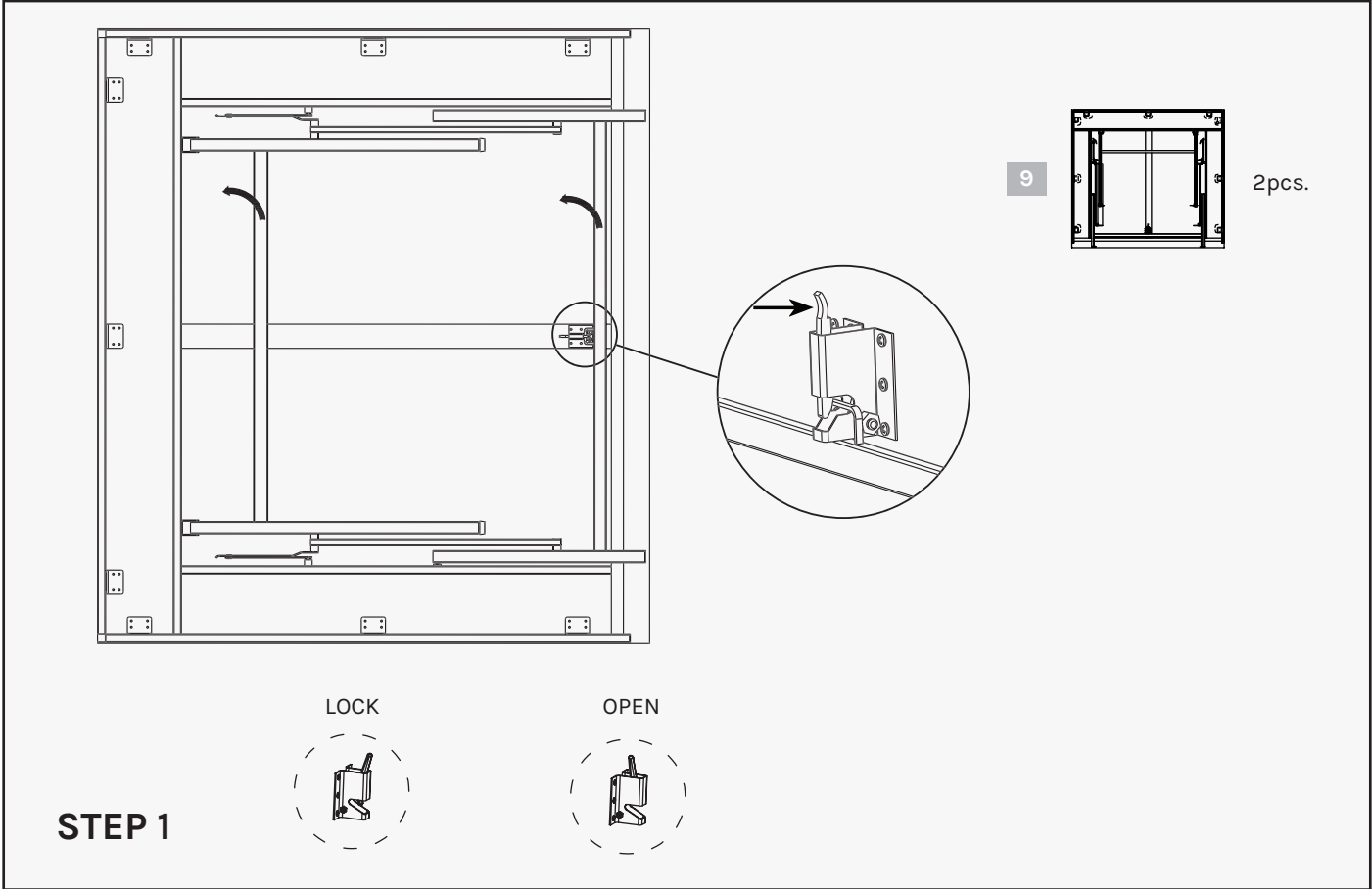

Place the table on a flat surface facing down. You can place a cloth on the ground to protect the table. Unlock the legs from the table. Then unfold the legs.

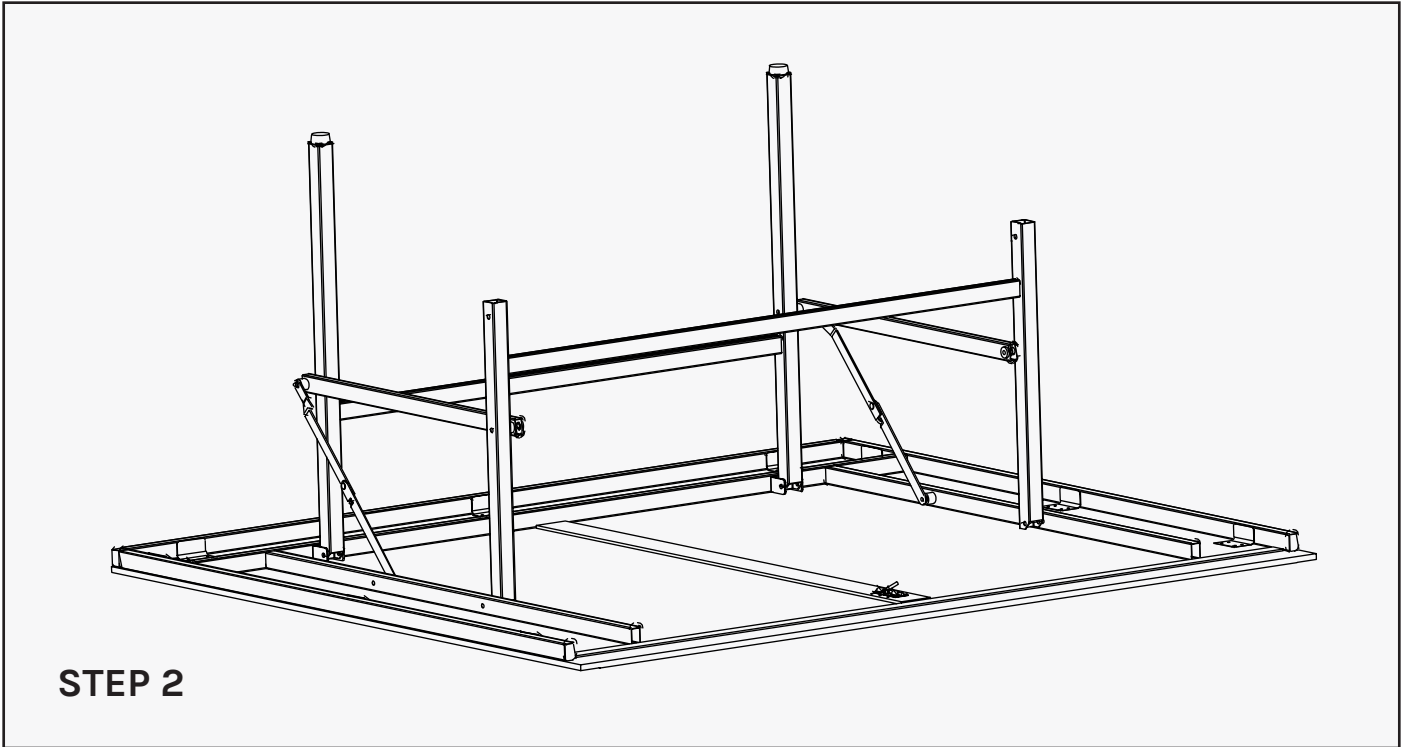

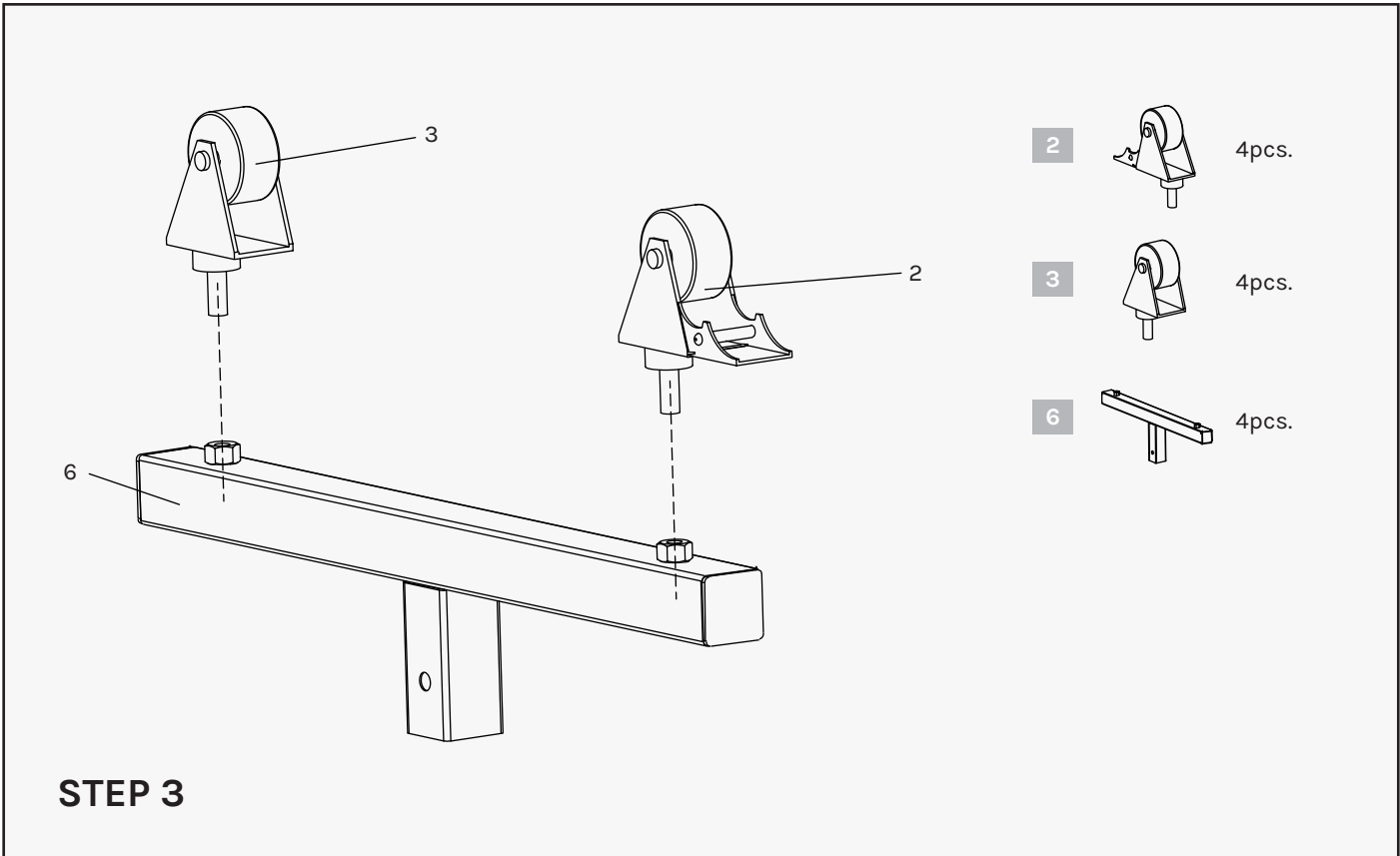

Install the wheels on the legs of both part 6.

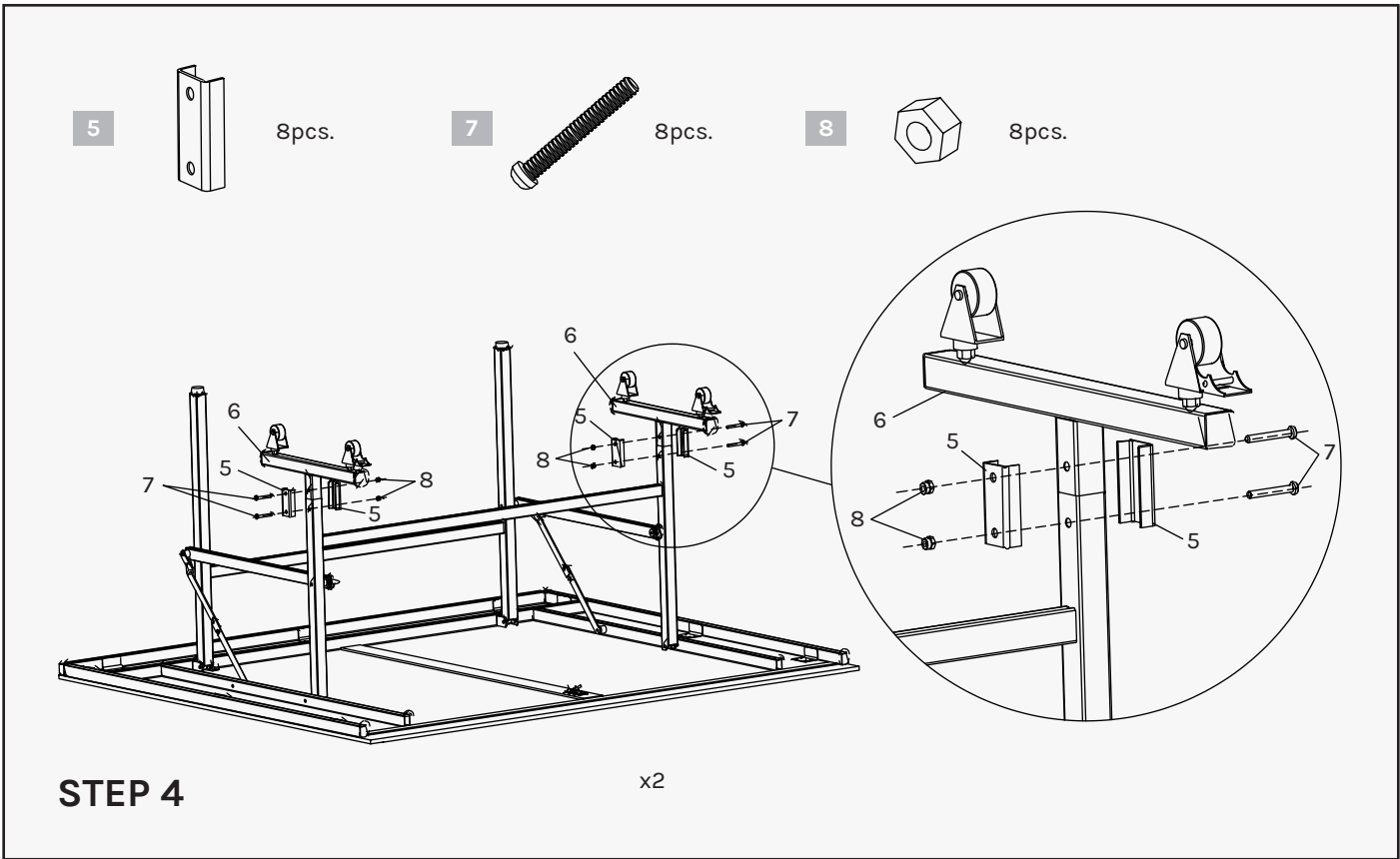

When attaching the Part 6 to the frame, ensure that both part 2 is on the outside and the part 3 is facing the frame leg as shown.

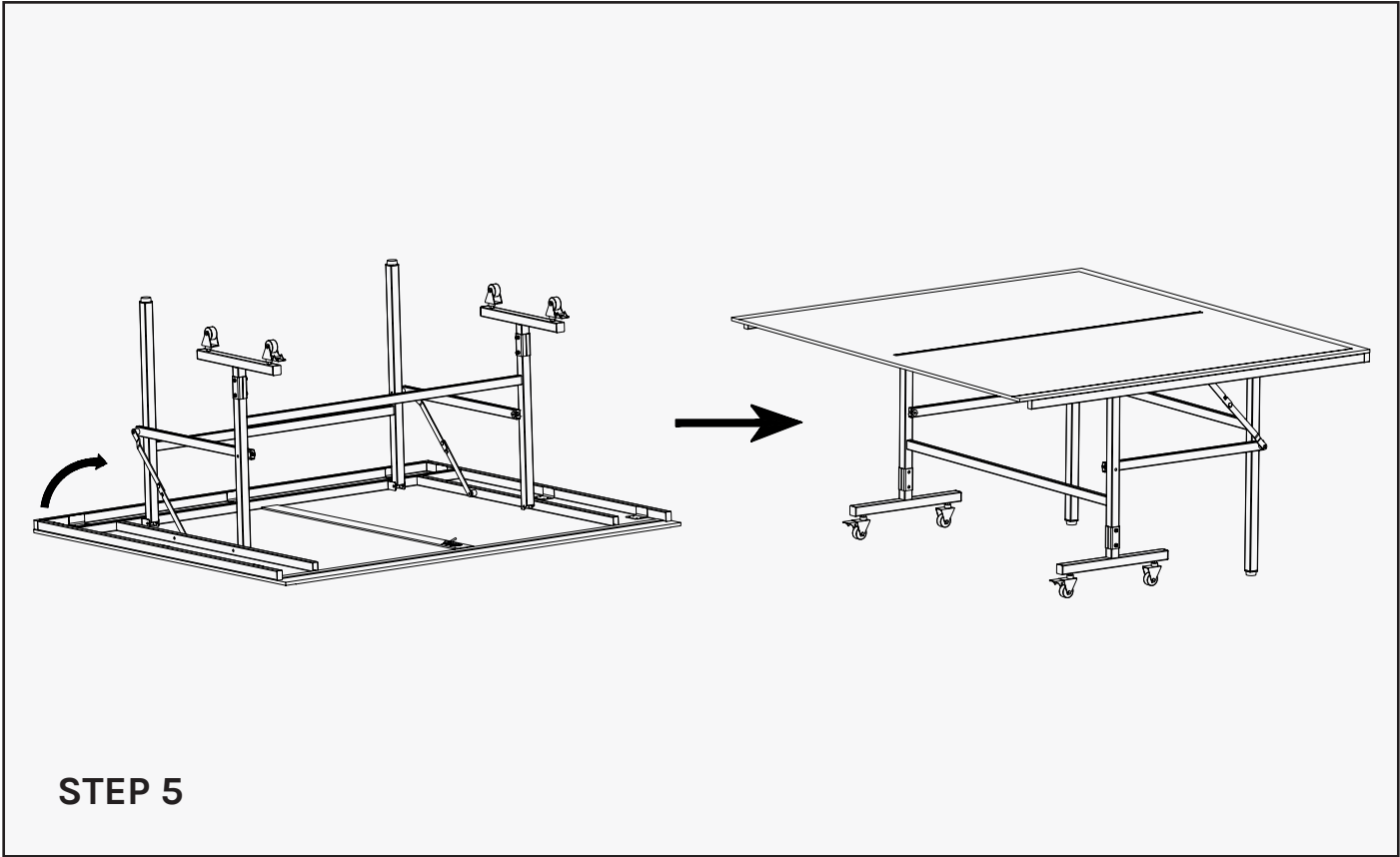

Flip over both tables once the legs are attached.

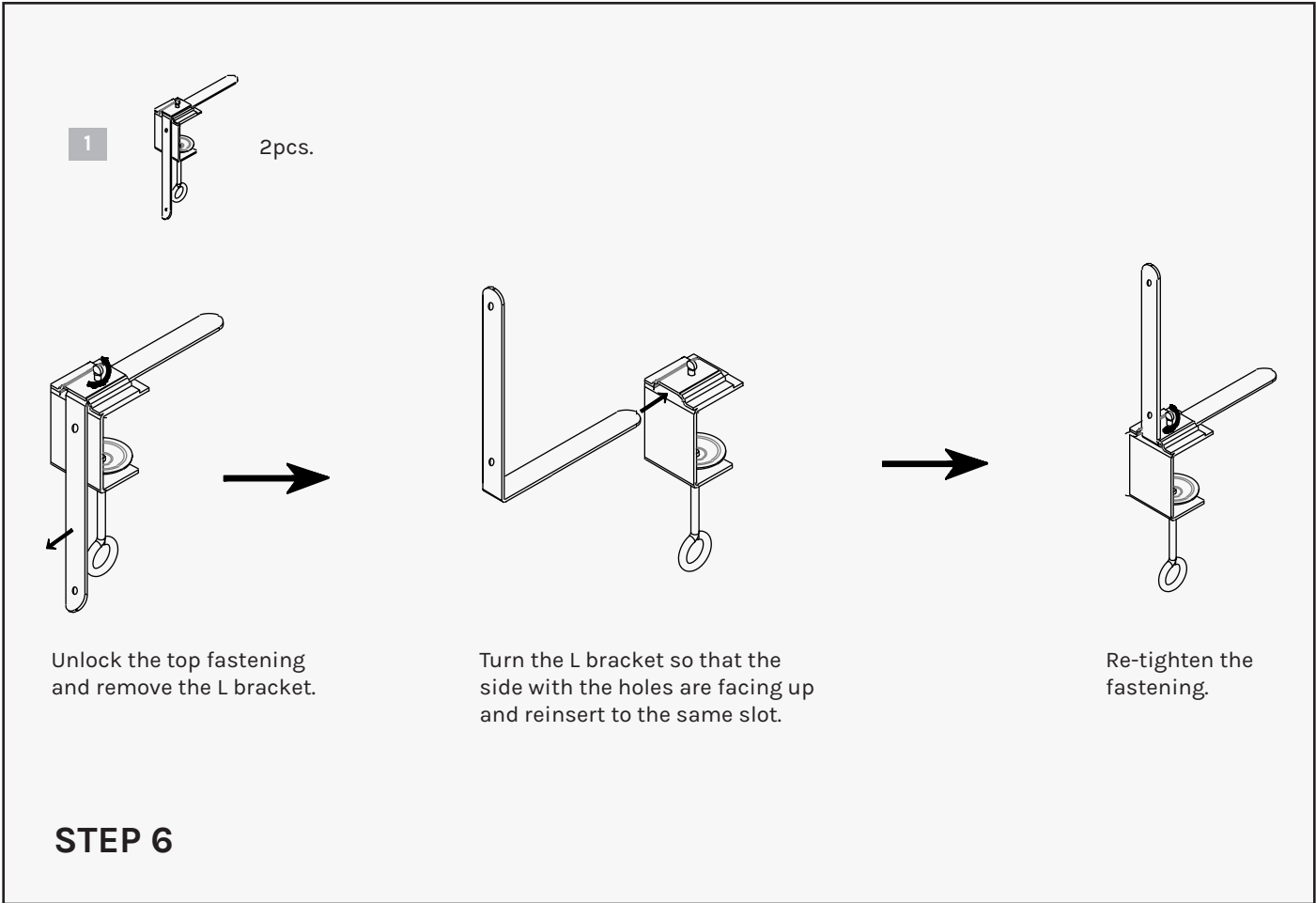

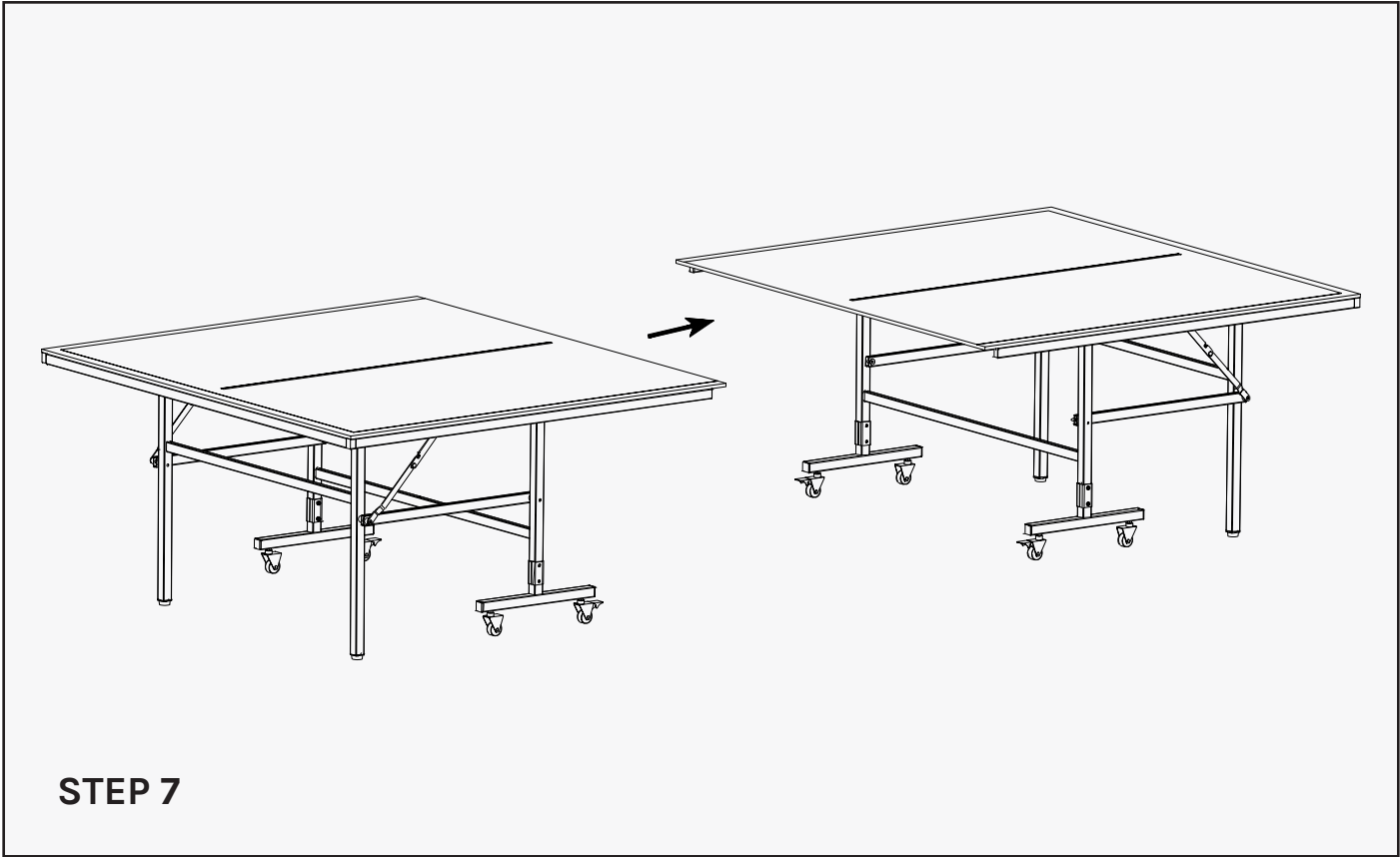

Bring both tables together.

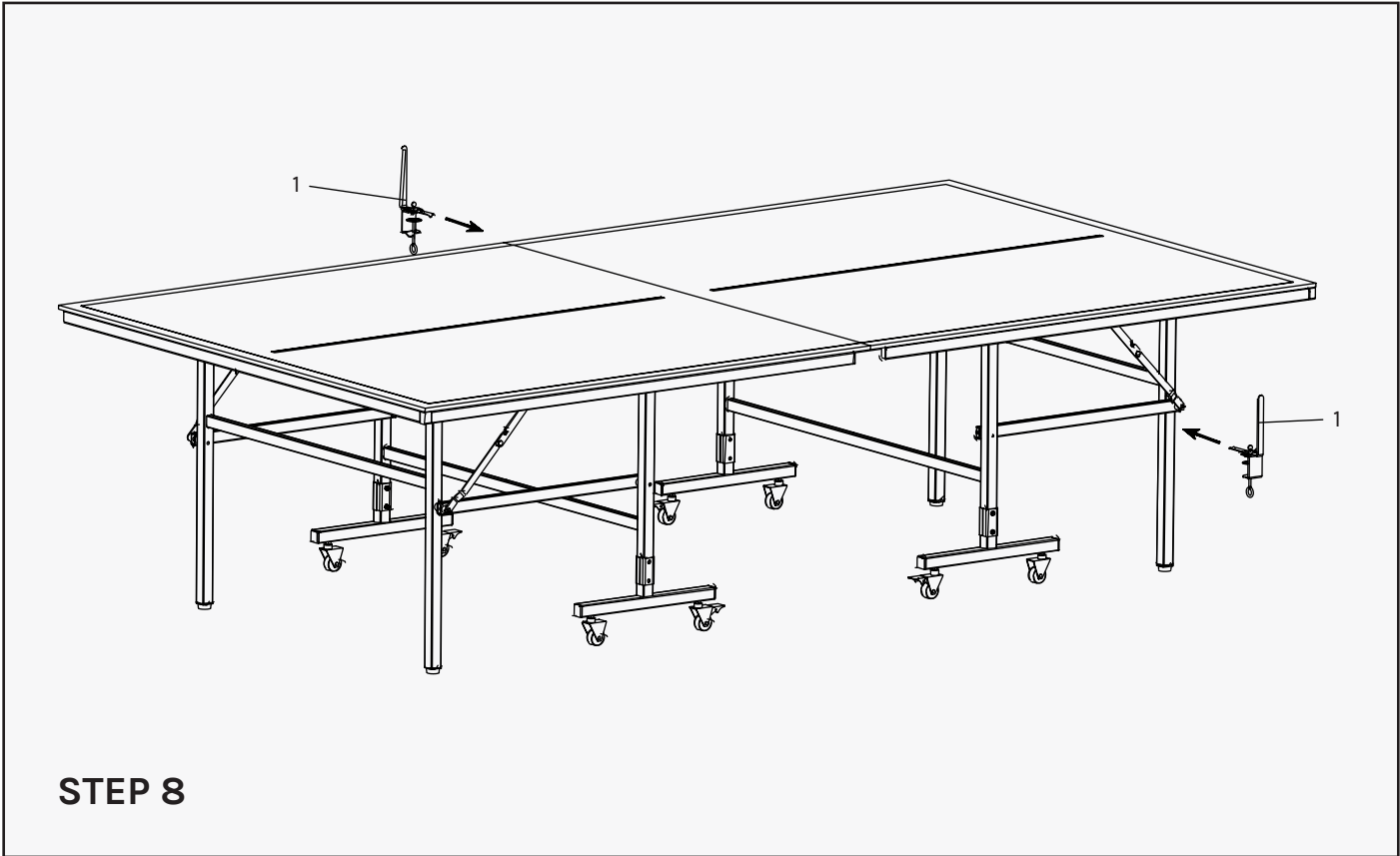

Place the part 1 pieces on either ends in the middle where both table joins.

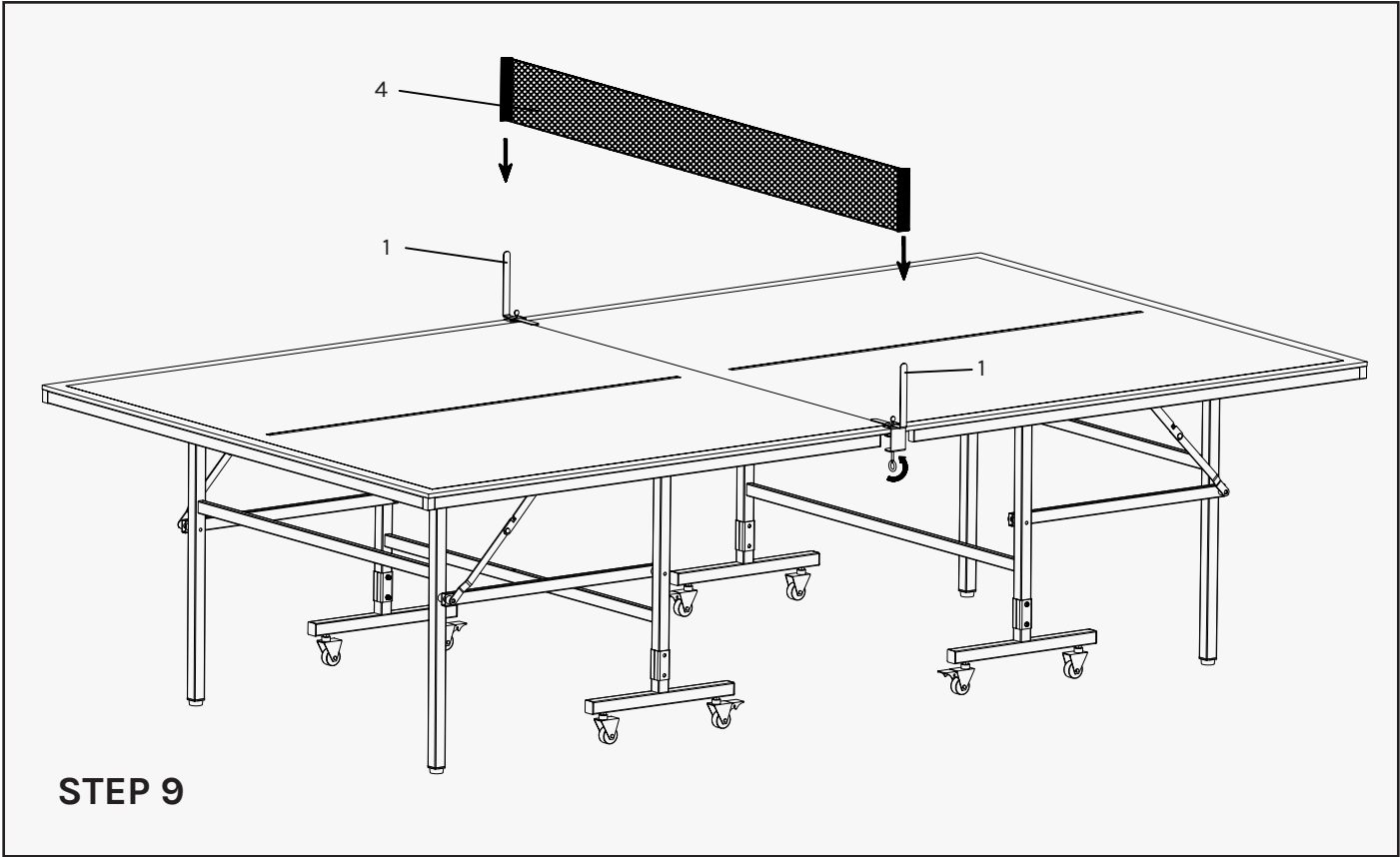

Turn the bottom fastening on part 1 to secure to table. Place the netting (4) to the part 1 bracket.

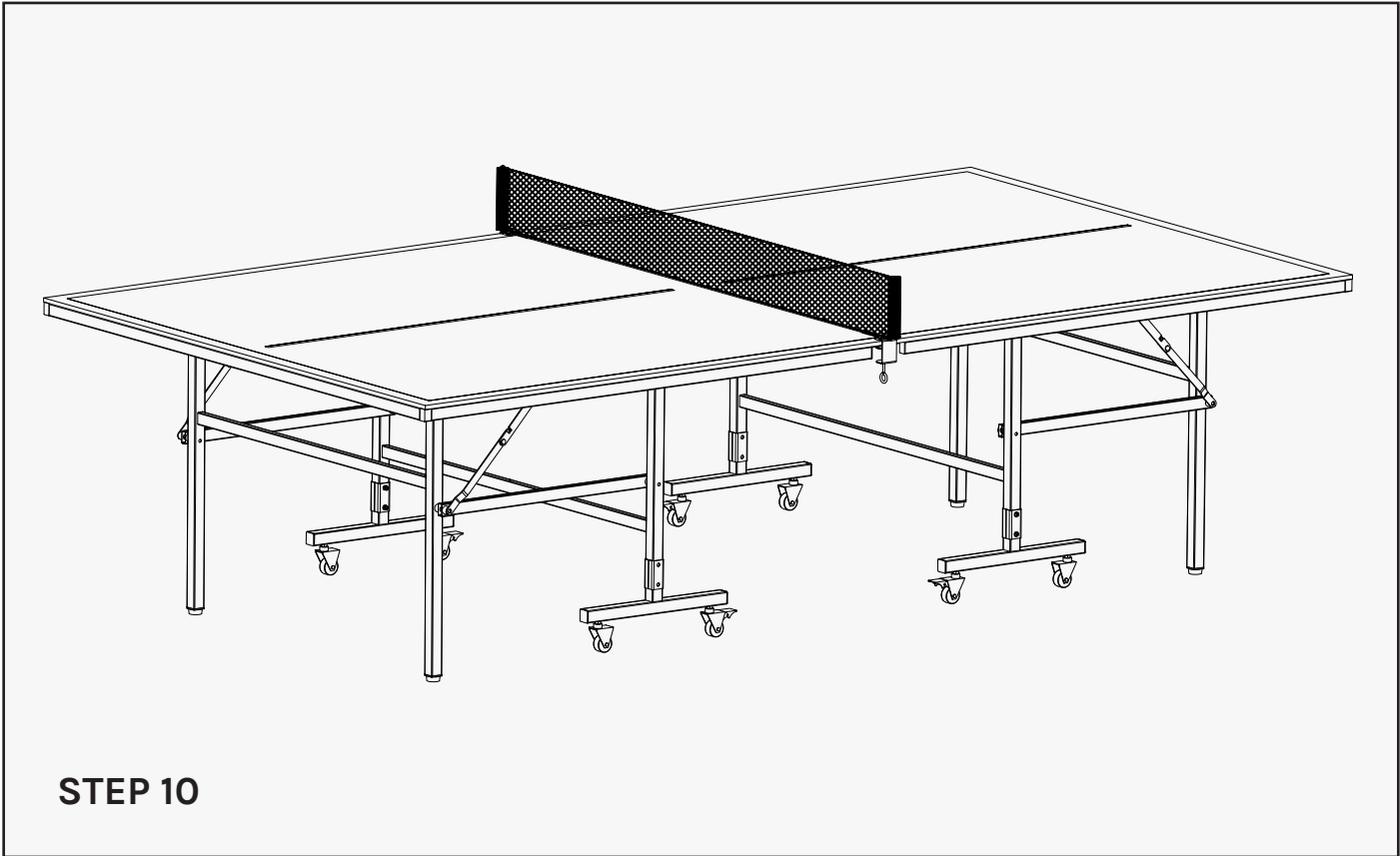

Assembly is complete.
You can lock the wheels once in position to prevent movement during play.

IV. FOLDING INSTRUCTIONS

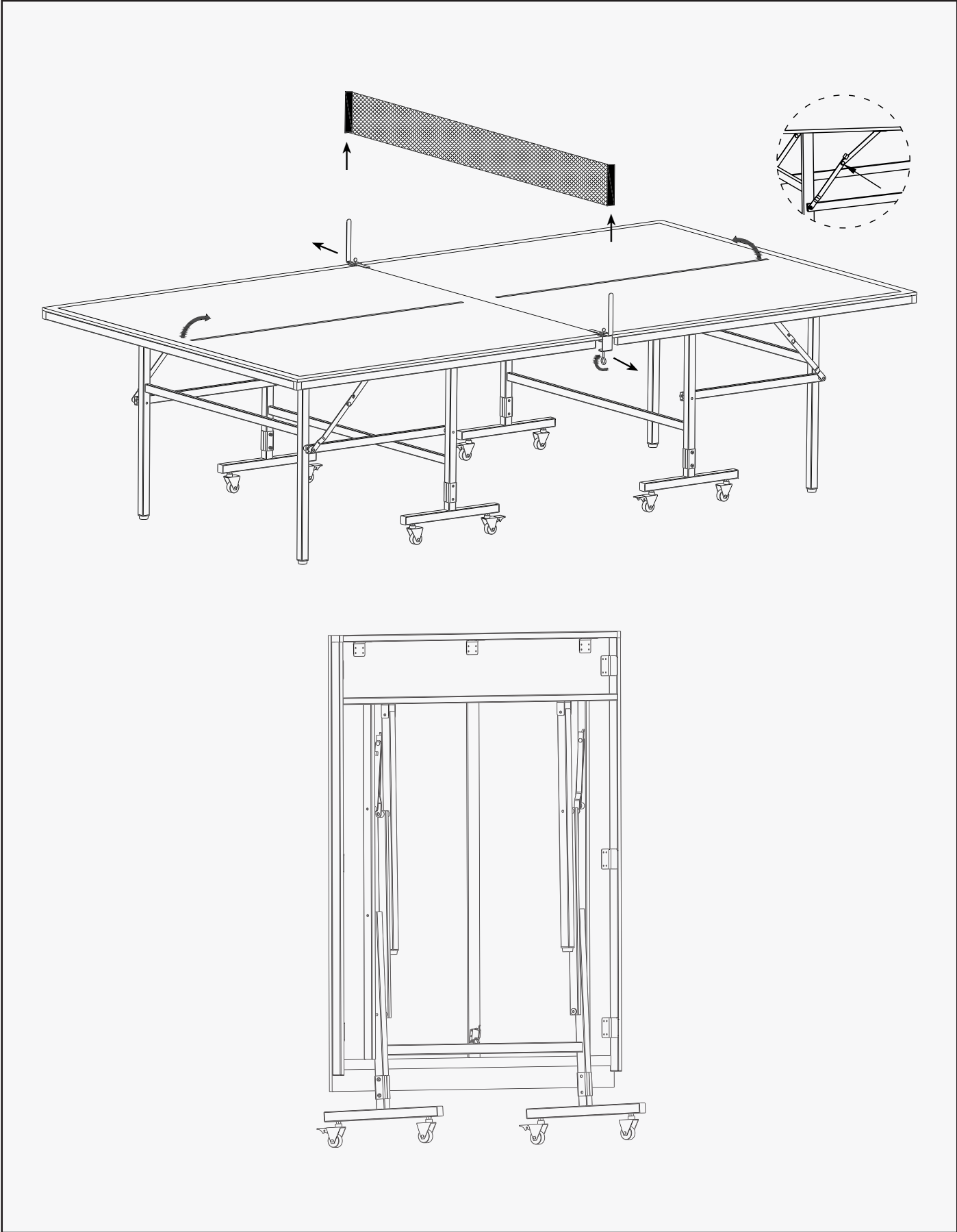

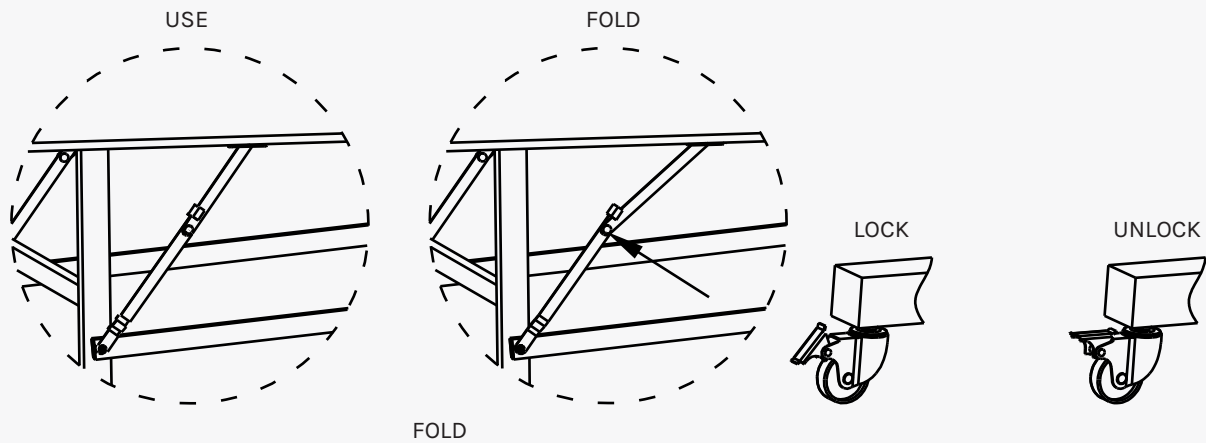

LEG HINGE WHEEL OPERATION

Straighten the hinge when the table is in use. Lock the wheel tightly by pushing the tab (on the wheel) down and lift up to unlock when you are transporting.

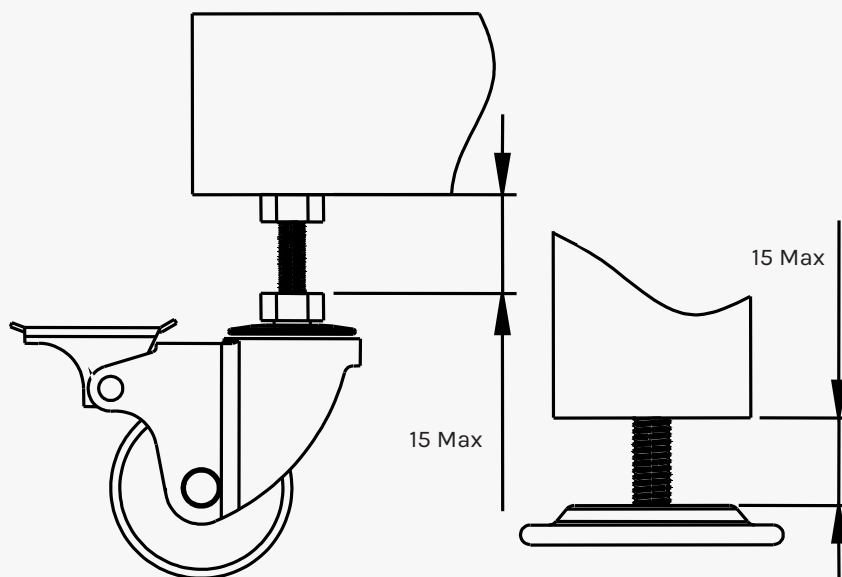

HEIGHT ADJUSTING METHOD

The wheel height can be adjusted to a maximum of 15mm. The foot height can also be adjusted to a maximum of 15mm.

V. WARRANTY

AUSTRALIAN CONSUMER LAW

Many of our products come with a guarantee or warranty from the manufacturer. In addition, they come with guarantees that cannot be excluded under the Australian Consumer Law. You are entitled to a replacement or refund for a major failure and compensation for any other reasonably foreseeable loss or damage.

You are entitled to have the goods repaired or replaced if the goods fail to be of acceptable quality and the failure does not amount to a major failure. Full details of your consumer rights may be found at www.consumerlaw.gov.au.

Please visit our website to view our full warranty terms and conditions:
<http://www.lifespanfitness.com.au/warranty-repairs>

WARRANTY AND SUPPORT

Any claim against this warranty must be made through your original place of purchase. Proof of purchase is required before a warranty claim may be processed.

If you have purchased this product from the Official Lifespan Fitness website, please visit <https://lifespanfitness.com.au/warranty-form>

For support outside of warranty, if you wish to purchase replacement parts or request a repair or service, please visit <https://lifespanfitness.com.au/warranty-form> and fill in our Repair/Service Request Form or Parts Purchase Form.

Scan this QR code with your device to go to lifespanfitness.com.au/warranty-form



ACTIVEGO

WWW.ACTIVEGO.COM.AU