

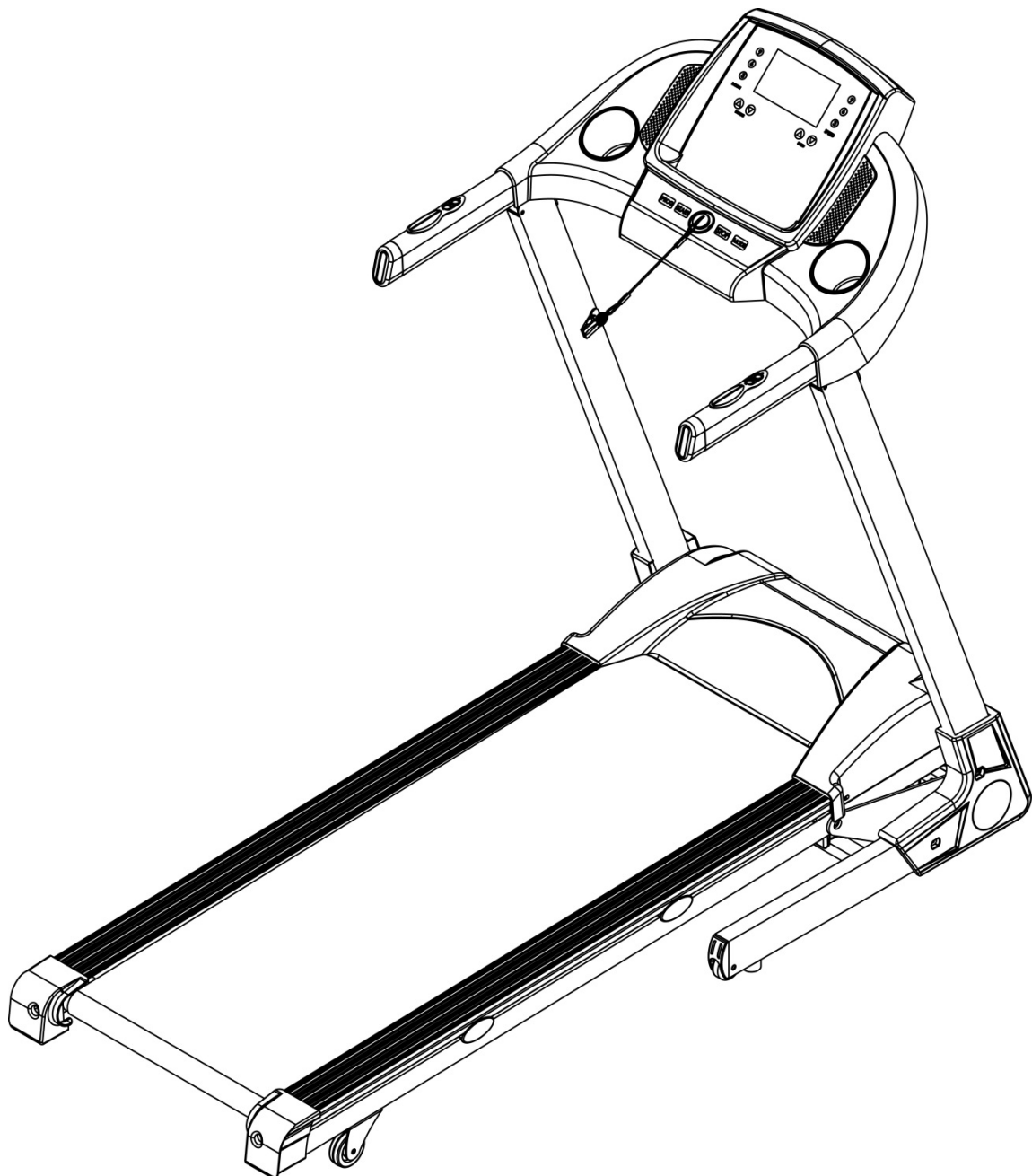

VISIT OUR BLOG FOR FITNESS TIPS,
HEATH TIPS, AND MUCH MORE!
BLOG.LIFESPANFITNESS.COM.AU

JAZZ OWNER'S MANUAL



Product may vary slightly from the item pictured due to model upgrades

Read all instructions carefully before using this product. Retain this owner's manual for future reference.

TABLE OF CONTENTS

1.	IMPORTANT SAFETY INSTRUCTIONS	3
2.	IMPORTANT ELECTRICAL INFORMATION	4
3.	IMPORTANT OPERATING INSTRUCTIONS	5
4.	ASSEMBLY INSTRUCTIONS	6
5.	FOLDING INSTRUCTIONS	11
6.	OPERATION GUIDE WITH PROGRAM CHART	12
7.	EXERCISE GUIDE	22
8.	MAINTENANCE INSTRUCTIONS	24
9.	TROUBLESHOOTING	29
10.	EXPLODED DIAGRAM	30
11.	PARTS LIST	31
12.	WARRANTY	33

1. IMPORTANT SAFETY INSTRUCTIONS

WARNING - Read all instructions before using this treadmill.

It is important your treadmill receives regular maintenance to prolong its useful life. Failing to regularly maintain your treadmill may void your warranty.

Danger – To reduce the risk of electric shock disconnect your treadmill from the electrical outlet prior to cleaning and/or service work.

DO NOT USE AN EXTENSION CORD: DO NOT ATTEMPT TO DISABLE THE GROUNDED PLUG BY USING IMPROPER ADAPTERS OR IN ANY WAY MODIFY THE CORD SET.

- Install the treadmill on a flat level surface with access to a 220-240 volt (50/60Hz), grounded outlet.
- Do not operate treadmill on deeply padded, plush or shag carpet. Damage to both carpet and treadmill may result.
- Do not block the rear of the treadmill. Provide a minimum of 1 metre clearance between the rear of the treadmill and any fixed object.
- Place your unit on a solid, level surface when in use
- Never allow children on or near the treadmill.
- When running, make sure the plastic clip is fastened on your clothing. It is for your safety, should you fall or move too far back on the treadmill.
- Keep hands away from all moving parts.
- Never operate the treadmill if it has a damaged cord or plug.
- Keep the cord away from heated surfaces.
- Do not operate where aerosol spray products are being used or where oxygen is being administered. Sparks from the motor may ignite a highly gaseous environment.
- Never drop or insert any object into any openings.
- The treadmill is intended for in-home use only and not suitable for long time running.

- To disconnect, turn all controls to the off position, remove the safety key, and then remove the plug from the outlet.
- The pulse sensors are not medical devices. Various factors, including the user's movement, may affect the accuracy of heart rate readings. The pulse sensors are intended only as exercise aids in determining heart rate trends in general.
- Use the handrails provided; they are for your safety.
- Wear proper shoes. High heels, dress shoes, sandals or bare feet are not suitable for use on your treadmill. Quality athletic shoes are recommended to avoid leg fatigue.
- Allowed temperature: 5 to 40 degrees.

Remove the safety key after use to prevent unauthorized treadmill operation.

2. IMPORTANT ELECTRICAL INFORMATION

WARNING!

- NEVER use a ground fault circuit interrupt (GFCI) wall outlet with this treadmill. Route the power cord away from any moving part of the treadmill including the elevation mechanism and transport wheels.
- NEVER remove any cover without first disconnecting AC power.
- NEVER expose this treadmill to rain or moisture. This treadmill is not designed for use outdoors, near a pool, or in any other high humidity environment.
- This is high-power item; please do not share the same outlet with other high power machines such as, fridges, air conditioning etc. Please choose an outlet exclusively for the machine and make sure the fuse is 10A.

3. IMPORTANT OPERATING INSTRUCTIONS

- Be sure to read the entire manual before operating your machine.
- Understand that changes in speed and incline do not occur immediately. Set your desired speed on the computer console and release the adjustment key. The computer will obey the command gradually.
- Use caution while participating in other activities while walking on your treadmill, such as watching television, reading, etc. These distractions may cause you to lose balance or stray from walking in the centre of the belt; which may result in serious injury.
- In order to prevent losing balance and suffering unexpected injury, **NEVER** mount or dismount the treadmill while the belt is moving. This unit starts with at a very low speed. Simply standing on the belt during slow acceleration is proper after you have learned to operate this machine.
- Always hold on to handrail while making control changes.
- A safety key is provided with this machine. Remove the safety key will stop the walking belt immediately; the treadmill will shut off automatically. Inserting the safety key will reset the display.
- Do not use excessive pressure on console control keys. They are precision set to function properly with little finger pressure.

4. ASSEMBLY INSTRUCTIONS

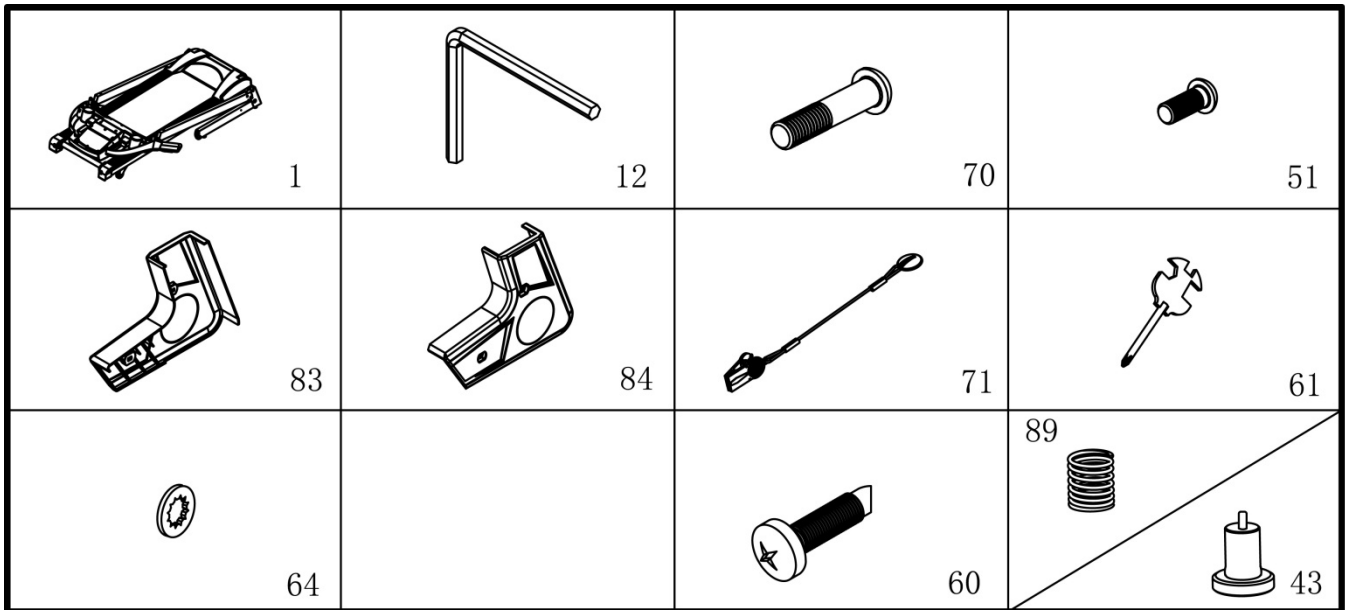

PARTIAL PART LIST

No	DES.	Specification	Qty	No	DES.	Specification	Qty
1	Main frame		1	71	Safety key		1
12	#5 Allen wrench	5mm	1	61	wrench w/screw driver	S=13, 14, 15	
70	Bolt	M8*45	2	64	Lock washer	8	5
83	Left back cover		1	60	Bolt	ST4.2*19	4
84	Right back cover		1	51	Bolt	M8*16	3
89	Spring		2	43	Rubber Pads		2

ASSEMBLY TOOLS:

5# Allen Wrench 5mm 1pc
#6 Allen Wrench 6mm 1pc
Wrench s/screw Driver S=13, 14, 15 - 1pc

Note: Do not plug in power until machine is completely assembled

STEP 1:

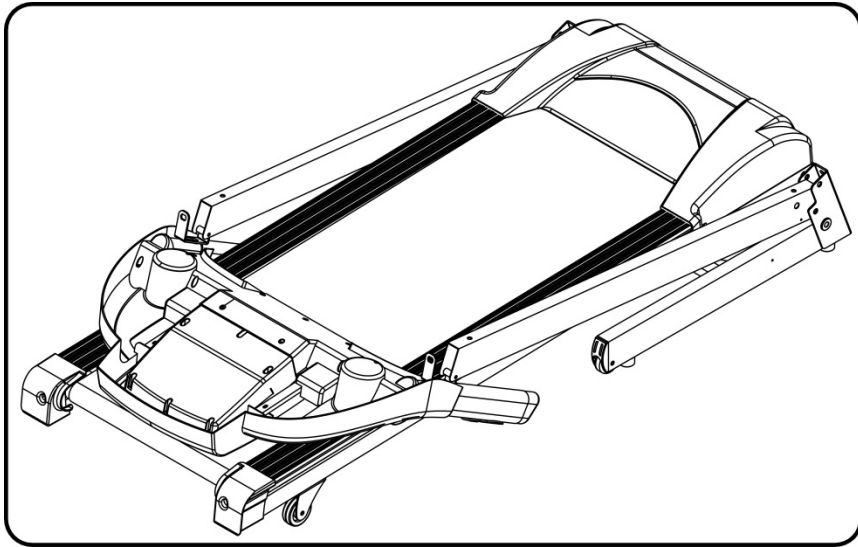

1. Open the carton
2. Extract the parts listed above
3. Place the Main Frame onto level ground

STEP 2:

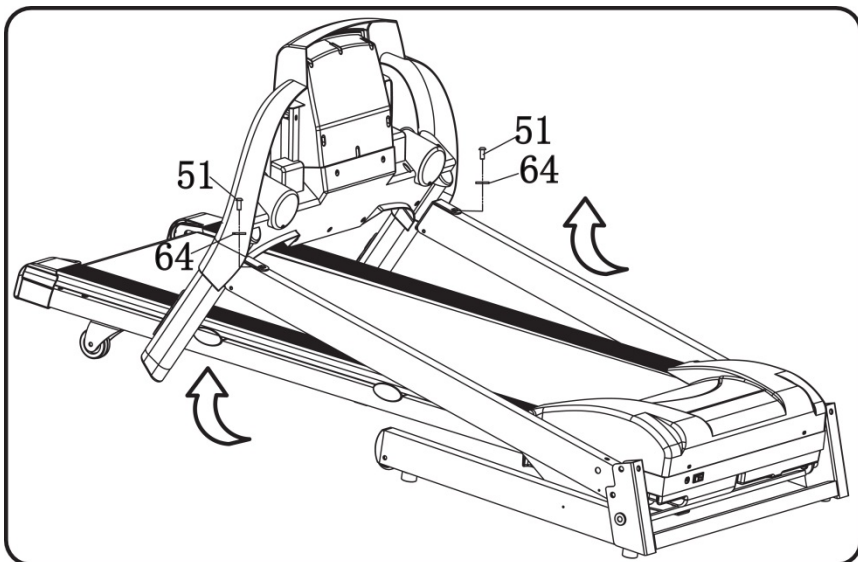

Do not damage the computer wire when folding the computer.

1. Move the computer according to the diagram.
2. Screw in Bolt M8*16(51) and the Lock washer (64) of Left Upright and Right Upright.
3. Secure the Computer frame to the Left Upright and Right Upright tightly with Bolt M8*16(51) and Lock washer (64)

Note: Support the upright with your hand to avoid it falling down and causing injury.

STEP 3:

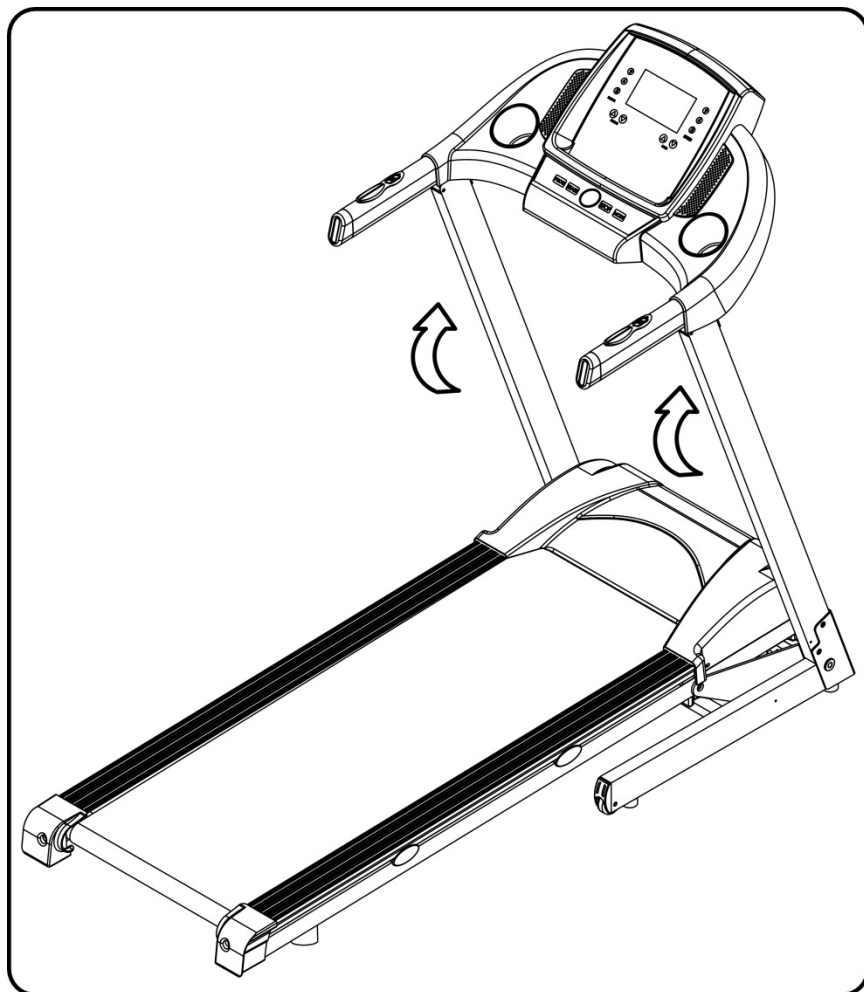

1. Do not sever the computer wire when folding the computer to on top of the Left Upright and Right Upright.
2. **Note: hold the Left Upright and Right Upright, to prevent them from falling down**

STEP 4:

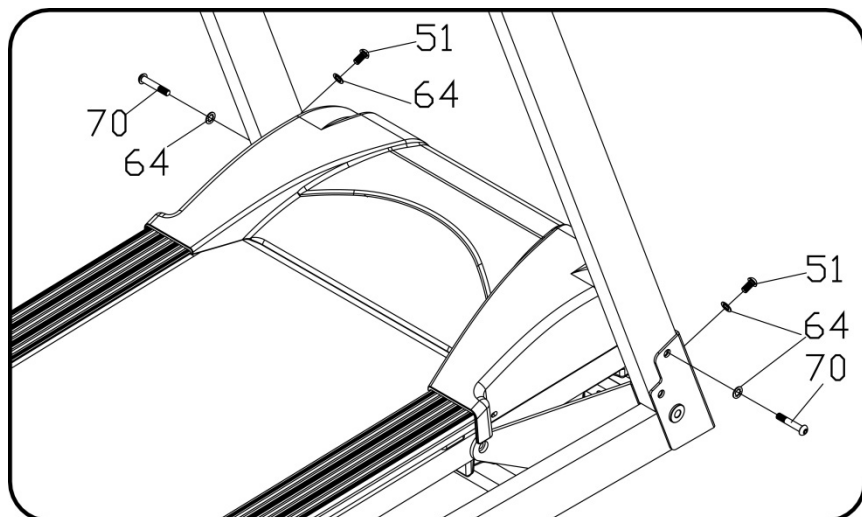

1. Using the 5# Allen wrench (12), screw in the Bolt M8*45 (70) and Lock washer (64)
2. Then attach the Right Upright Tube **(3)** to the Main Frame (1) using the Bolt M8*16(51) and Lock washer (64).
3. Repeat these steps for the Left Upright Tube

Note: Support the upright with your hand to avoid it falling down and causing injury.

STEP 5:

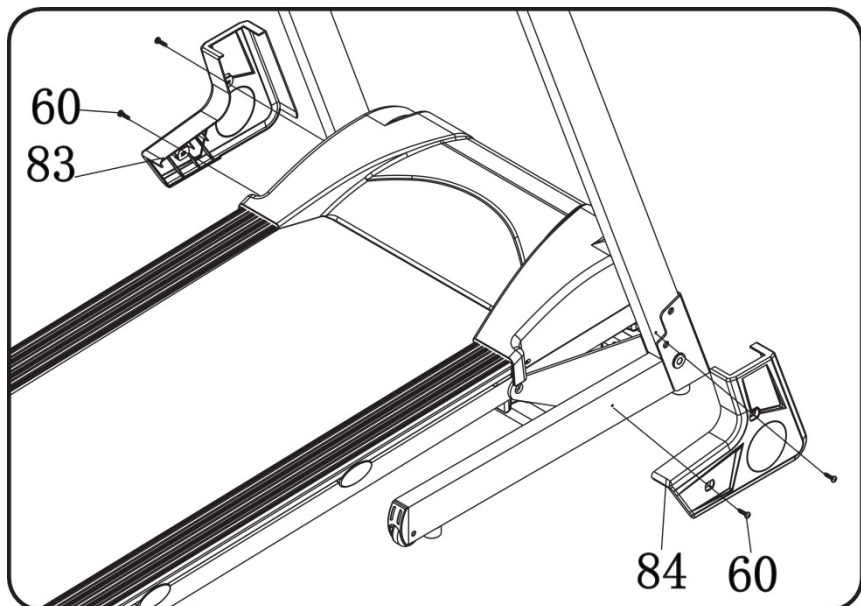

1. Use the wrench w/screw driver (61) to attach the **Left back cover (83)** onto the base frame with ST4.2*19(60).
2. Use the wrench w/screw driver (61) to attached the Right **back cover (84)** onto the base frame with ST4.2*19(60).

STEP 6:

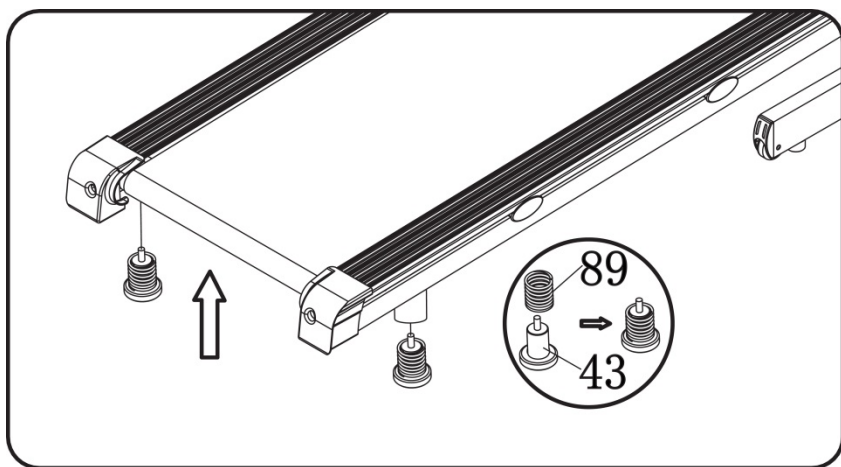

1. Attach the spring (89) to the rubber pads(43)
 2. Erect the frame and screw the entire assembly onto the frame
-

STEP 7:

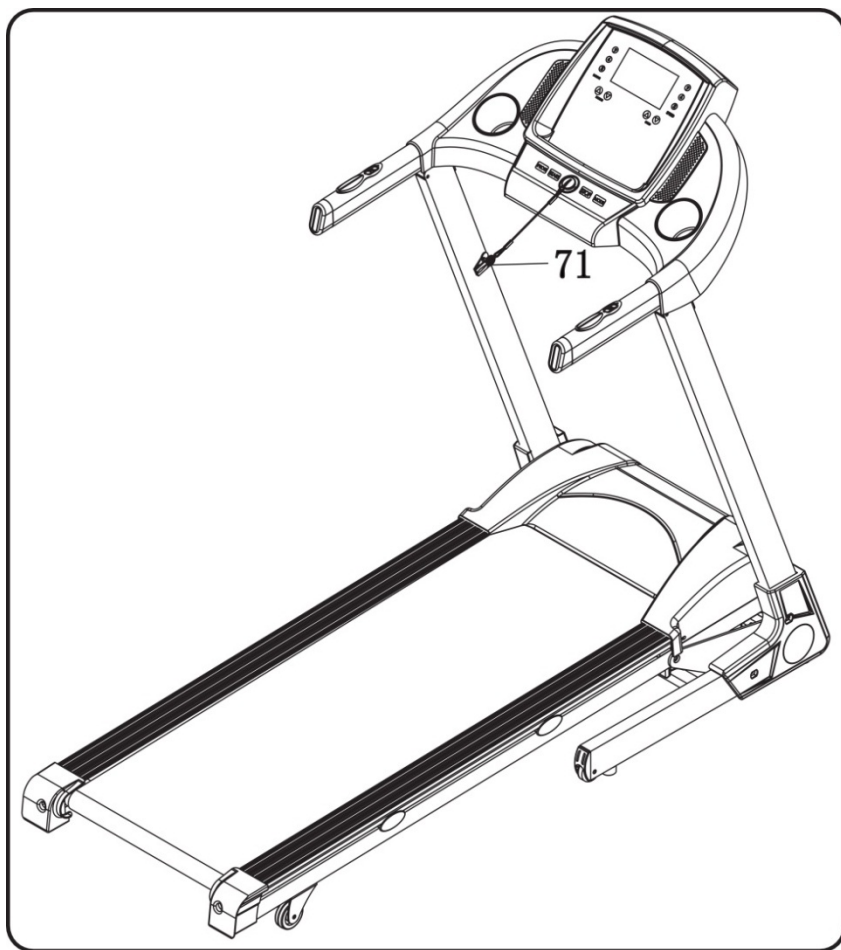

1. Place the safety key (71) on the computer and start your workout.
-

5. FOLDING INSTRUCTIONS

Unfolding:

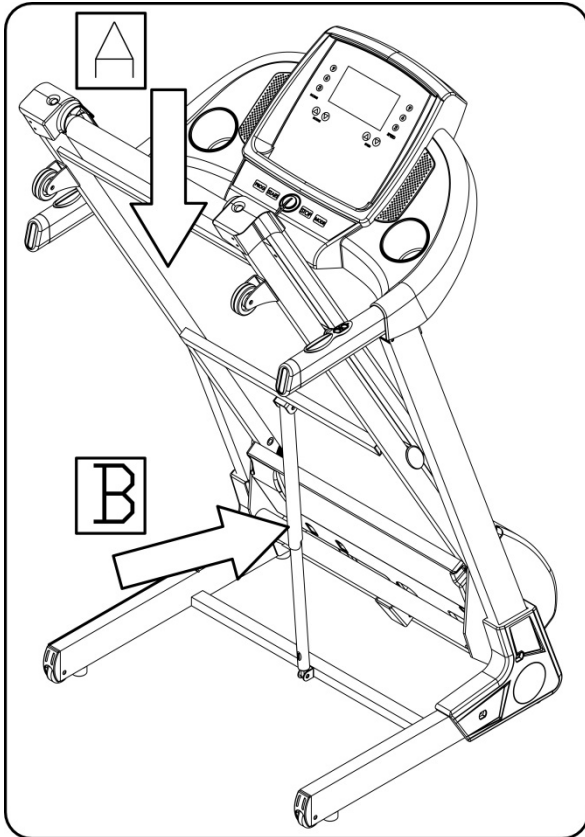

Whilst supporting position (A) with our hand, gently push position (B), the marked area on the air pressure bar, with your foot. The base frame will descend automatically. (Please keep people and any pets away the machine during descent)

Folding:

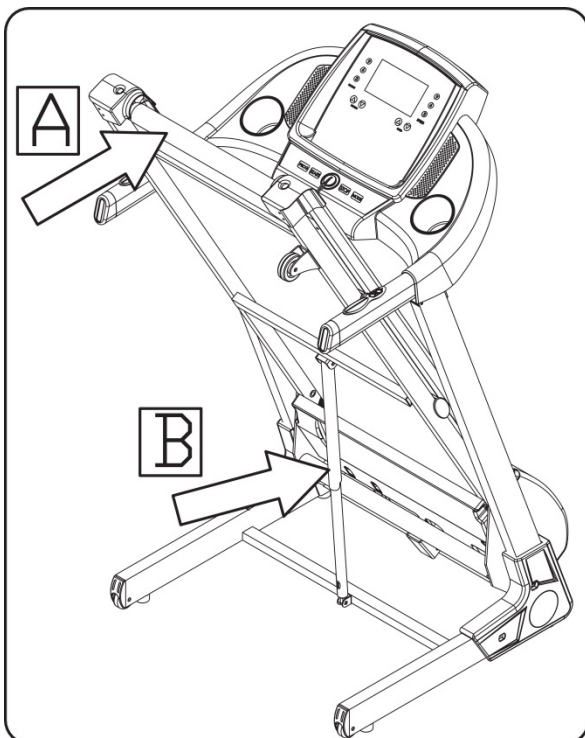

Place your hand on position (A), then pull up the base frame until you hear the click sound emitted when the air pressure bar (B) is locked into the round tube.

Video Tutorial Available at:
<http://youtu.be/TcuPbJ7KuxQ>

Lifespan Fitness YouTube Channel:
<http://www.youtube.com/user/treadmillsvideos>

6. OPERATION GUIDE WITH PROGRAM CHART

1. OVERVIEW



2. LCD WINDOW DISPLAY

1. **SPEED**: Shows speed and program.
2. **INCLINE window**: Shows degree of incline.
3. **TIME window**: displays running time
4. **DIST window**: shows the running distance.
5. **PULSE**: shows heart rate. (Heart rate data is for reference ONLY.)
6. **CALO window**: shows calories burnt. This is an estimate only. This is not intended to be used as medical data.

3. BUTTON FUNCTIONS

1. **“PROG”**: choose the program, cycle between manual mode, P01 - P99, U01 – U3, FAT
2. **“MODE”**: mode selection button. Press this button to cycle the mode: mode-time count down, mode-distance count down, mode-calories count down.
3. **“START”**: begins workout. When the power is on and safety key correctly placed on the computer, press this button to start the treadmill after a 3 second countdown.
4. **“STOP”**: press button to stop the motor running and to stop the machine
5. **SPEED+ \ SPEED-**: Increase or decrease speed when exercising. Sets parameter when stopped.
6. **“INCLINE+”, “INCLINE-”**: increase or decreases incline. Adjust the incline gradient during exercising. Sets parameter when stopped.
7. **“SPEED: 3, 6, 9”** Speed adjustment shortcut key
8. **“INCL: 3, 6, 9”** Incline adjustment shortcut key.

Left handle bar buttons: adjusts incline

Right handle bar buttons: adjusts speed

4. MAIN FUNCTIONS

4.1. Quick Start-up (Manual):

Attach the safety key. After a 3 second countdown, the treadmill will starting and running from the lowest speed, add and subtract to the speed using the SPEED +/- button.

4.2. Countdown mode:

Press the MODE button to cycle options: timer countdown, distance countdown, calories countdown. The default value corresponds to the window and flashing display. At this point the SPEED buttons serve as a plus and minus functions to adjust to the desired value. Press the START, add and subtract speed by using SPEED buttons once again. When the countdown reaches 0, the machine will stop. You can also directly press the STOP button or disconnect safety lock to stop.

4.3. Manual Operation:

When in Standby mode, press the "START" button and the treadmill will run at speed 1.0KM/H, incline 0. Other windows will begin to record your workout data. Use the "SPEED+", "SPEED-", "INCLINE+", "INCLINE-" buttons to change the incline and speed.

Setting TIME countdown: When Standby mode, press the "MODE" button and the "Time" window will show "15:00" and light up. Use the "SPEED+", "SPEED-", "INCLINE+", "INCLINE-" buttons to set the desired workout time. The setting range is between: 5:00-99:00.

Setting DISTANCE countdown: When Standby mode, press "MODE" until the "DISTANCE" window displays "1.00" and lights up. Use the "SPEED+", "SPEED-", "INCLINE+", "INCLINE-" buttons to set total workout distance. The setting range is between: 0.50-99.90.

Setting DISTANCE countdown: When Standby mode, press "MODE" until the "CALORIES" window displays lights up. Use the "SPEED+", "SPEED-", "INCLINE+", "INCLINE-" buttons to set total workout distance. The setting range is between: 10.0-999.0.

4.4. Preset Program Operation:

Preset programs change speed and incline for you during your workout. Every program will have 10 intervals, in which speed and incline will be adjusted between. See the next page for the program list. wake the treadmill.

4.5. MP3 Function (if applicable)

Plug the 3.5mm jack audio cable into any 3.5mm headphone jack slot. Music can be controlled via the MP3 device.

4.6. USB Function (if applicable)

Insert any USB or SD card which contains audio files. You can control the playback via the buttons on the display.

Please keep the volume at appropriate levels to prevent the speakers from damage

INNER PROGRAM DATA LIST

TIME		Each column represents 1/10 th of the total program time									
PROG		1	2	3	4	5	6	7	8	9	10
P1	SPEED	2	4	3	4	3	5	4	2	5	3
	INCLINE	1	2	3	3	1	2	2	3	2	2
P2	SPEED	2	5	4	6	4	6	4	2	4	2
	INCLINE	1	2	3	3	2	2	3	4	2	2
P3	SPEED	2	5	4	5	4	5	4	2	3	2
	INCLINE	1	2	2	3	1	2	2	2	2	1
P4	SPEED	3	6	7	5	8	5	9	6	4	3
	INCLINE	2	2	3	3	2	2	4	6	2	2
P5	SPEED	3	6	7	5	8	6	7	6	4	3
	INCLINE	1	2	4	3	2	2	4	5	2	1
P6	SPEED	2	8	6	4	5	9	7	5	4	3
	INCLINE	2	2	6	2	3	4	2	2	2	1
P7	SPEED	2	6	7	4	4	7	4	2	4	2
	INCLINE	4	5	6	6	9	9	10	12	6	3
P8	SPEED	2	4	6	8	7	8	6	2	3	2
	INCLINE	3	5	4	4	3	4	4	3	3	2
P9	SPEED	2	4	5	5	6	5	6	3	3	2
	INCLINE	3	5	3	4	2	3	4	2	3	2
P10	SPEED	2	3	5	3	3	5	3	6	3	3
	INCLINE	4	4	3	6	7	8	8	6	3	3
P11	SPEED	3	5	8	8	9	5	7	6	3	2
	INCLINE	4	5	6	6	9	9	10	12	6	3
P12	SPEED	2	5	5	4	4	6	4	2	3	4
	INCLINE	3	5	6	7	12	9	11	11	6	3
P13	SPEED	3	5	7	8	9	10	8	6	4	3
	INCLINE	1	2	3	4	5	5	4	3	2	1
P14	SPEED	2	4	6	8	10	10	8	6	4	2
	INCLINE	4	5	6	7	8	8	7	6	5	4
P15	SPEED	3	4	7	8	10	9	8	6	5	4
	INCLINE	3	4	5	6	7	8	8	5	3	2
P16	SPEED	2	3	5	4	5	5	7	5	4	2
	INCLINE	0	2	2	4	4	6	6	1	1	0
P17	SPEED	2	6	8	3	9	4	12	4	3	2
	INCLINE	5	5	10	10	3	3	3	7	1	0
P18	SPEED	1	5	4	5	9	5	4	5	3	2
	INCLINE	5	5	8	8	10	10	10	7	2	0
P19	SPEED	3	4	8	4	3	8	6	4	3	1
	INCLINE	2	4	4	4	4	2	3	3	1	0

P20	SPEED	3	2	3	6	6	6	6	5	3	3
	INCLINE	3	3	5	5	5	5	2	2	1	0
P21	SPEED	2	6	5	6	8	6	7	4	3	2
	INCLINE	2	3	3	3	4	4	1	1	2	0
P22	SPEED	2	4	6	8	10	8	6	4	6	6
	INCLINE	2	3	6	6	3	5	8	3	5	3
P23	SPEED	2	4	6	8	4	2	7	8	12	1
	INCLINE	3	6	5	3	5	3	5	5	4	2
P24	SPEED	2	4	6	4	6	8	10	8	6	4
	INCLINE	2	5	5	3	5	5	3	3	4	2
P25	SPEED	2	2	2	6	6	10	11	4	8	2
	INCLINE	5	5	8	8	8	3	3	5	8	0
P26	SPEED	2	4	10	12	4	10	4	10	4	2
	INCLINE	2	2	2	2	2	2	3	3	1	0
P27	SPEED	2	6	4	8	4	8	6	10	8	2
	INCLINE	3	3	6	6	6	6	2	2	1	0
P28	SPEED	2	4	6	8	10	4	6	8	10	2
	INCLINE	0	2	2	5	5	5	5	1	1	0
P29	SPEED	2	4	6	8	12	2	2	4	8	2
	INCLINE	5	5	10	10	3	3	3	8	2	0
P30	SPEED	2	4	6	10	8	4	10	6	10	2
	INCLINE	5	5	8	8	10	10	10	4	4	0
P31	SPEED	2	3	3	4	5	3	4	5	4	3
	INCLINE	1	1	3	3	3	3	3	2	2	1
P32	SPEED	2	4	4	5	6	4	6	5	4	2
	INCLINE	1	2	3	3	3	3	3	2	3	2
P33	SPEED	2	4	4	6	6	4	7	5	3	2
	INCLINE	2	3	4	3	4	3	3	3	4	2
P34	SPEED	3	5	5	6	7	7	5	7	9	3
	INCLINE	2	3	3	2	2	4	4	4	4	0
P35	SPEED	2	4	4	5	6	7	7	5	2	2
	INCLINE	3	3	3	4	4	5	5	5	5	2
P36	SPEED	2	4	4	4	5	5	5	8	6	2
	INCLINE	3	5	5	5	4	4	4	3	4	2
P37	SPEED	2	3	3	3	2	5	2	4	3	3
	INCLINE	4	4	4	3	3	6	6	8	3	1
P38	SPEED	2	3	3	6	9	9	9	9	4	2
	INCLINE	4	5	5	5	6	6	6	7	10	3
P39	SPEED	2	4	4	7	9	4	9	8	4	2
	INCLINE	5	5	5	6	6	6	4	4	8	2
P40	SPEED	2	4	5	6	7	9	4	9	5	3
	INCLINE	5	6	6	6	7	5	8	8	5	3
P41	SPEED	3	4	5	9	5	9	5	5	5	3
	INCLINE	3	6	5	3	5	3	5	5	4	2
P42	SPEED	2	5	8	10	7	7	10	10	9	3
	INCLINE	2	5	5	3	5	5	3	3	6	2

P43	SPEED	1	1	3	3	3	4	4	4	5	1
	INCLINE	5	5	8	8	8	3	3	6	8	0
P44	SPEED	3	4	6	3	4	6	3	4	6	3
	INCLINE	2	4	4	4	4	2	5	5	1	0
P45	SPEED	3	4	7	5	7	6	7	5	7	3
	INCLINE	3	3	5	5	5	5	3	3	1	0
P46	SPEED	3	3	3	5	5	5	5	5	7	2
	INCLINE	0	2	2	5	5	5	5	1	1	0
P47	SPEED	2	2	4	4	4	3	4	4	4	2
	INCLINE	5	5	10	10	6	6	6	7	9	0
P48	SPEED	1	3	4	4	4	4	5	5	5	2
	INCLINE	5	5	7	7	10	10	10	7	4	0
P49	SPEED	3	4	6	4	4	6	6	6	7	1
	INCLINE	2	3	3	3	3	2	0	2	1	0
P50	SPEED	3	4	4	7	7	7	7	7	6	3
	INCLINE	3	3	2	2	2	2	2	2	2	0
P51	SPEED	2	4	4	4	4	4	7	7	6	2
	INCLINE	2	3	3	3	2	2	1	4	4	0
P52	SPEED	2	4	6	8	10	8	6	4	10	4
	INCLINE	2	3	6	2	8	10	15	8	6	3
P53	SPEED	2	4	6	6	8	6	8	8	6	4
	INCLINE	3	6	5	5	4	6	8	14	5	2
P54	SPEED	2	4	7	4	6	8	10	8	6	1
	INCLINE	2	5	5	6	8	4	6	6	13	2
P55	SPEED	2	2	2	9	8	7	10	10	4	1
	INCLINE	5	5	9	8	9	4	4	4	4	0
P56	SPEED	2	2	4	9	10	12	4	4	10	1
	INCLINE	2	2	2	6	6	0	0	2	1	0
P57	SPEED	2	6	4	9	8	8	6	10	8	1
	INCLINE	3	3	6	1	2	2	2	2	2	0
P58	SPEED	2	4	3	8	10	2	4	6	6	1
	INCLINE	0	2	2	3	3	3	1	1	1	0
P59	SPEED	2	4	3	8	10	12	10	8	8	1
	INCLINE	5	5	10	9	9	4	4	4	4	0
P60	SPEED	2	4	2	10	8	4	10	6	10	1
	INCLINE	5	5	8	9	9	4	4	4	4	0
P61	SPEED	1	4	6	6	6	6	9	9	6	1
	INCLINE	2	3	6	2	8	10	15	8	6	3
P62	SPEED	2	6	6	6	6	6	10	8	4	2
	INCLINE	3	6	5	5	4	6	8	14	5	2
P63	SPEED	2	2	2	6	6	6	10	11	8	2
	INCLINE	2	5	5	6	8	4	6	6	13	2
P64	SPEED	2	2	4	4	10	12	4	5	4	2
	INCLINE	5	5	6	8	9	4	4	4	4	0
P65	SPEED	2	6	4	8	4	8	6	10	4	2
	INCLINE	2	2	7	6	6	0	0	2	1	0

P66	SPEED	2	4	6	8	12	2	6	6	10	2
	INCLINE	3	3	6	1	2	2	2	2	2	0
P67	SPEED	2	4	7	8	12	12	12	8	9	2
	INCLINE	0	2	2	3	3	3	1	1	1	0
P68	SPEED	2	4	6	12	8	4	12	7	10	2
	INCLINE	5	5	10	9	9	4	4	4	4	0
P69	SPEED	2	3	3	4	5	4	4	3	4	3
	INCLINE	5	5	6	9	9	4	4	4	4	0
P70	SPEED	2	4	4	6	6	4	6	6	4	2
	INCLINE	1	1	5	1	1	3	3	2	2	2
P71	SPEED	2	4	4	6	6	4	9	8	3	2
	INCLINE	1	2	5	3	3	4	4	3	2	2
P72	SPEED	3	5	5	6	8	8	5	8	4	3
	INCLINE	2	3	4	4	4	6	6	3	2	2
P73	SPEED	2	4	4	5	6	8	8	8	4	2
	INCLINE	2	3	3	4	6	6	3	2	2	0
P74	SPEED	2	4	3	4	5	8	9	8	3	2
	INCLINE	3	3	3	5	3	3	3	2	2	2
P75	SPEED	2	3	2	5	8	8	3	5	3	3
	INCLINE	3	5	5	4	3	3	3	4	3	2
P76	SPEED	2	3	3	6	4	2	3	4	4	2
	INCLINE	4	4	4	9	9	6	6	5	3	3
P77	SPEED	2	4	4	8	8	5	6	3	3	2
	INCLINE	4	5	5	10	10	12	12	8	6	3
P78	SPEED	2	4	5	7	9	5	4	4	2	3
	INCLINE	5	5	5	8	9	9	9	7	4	2
P79	SPEED	3	4	5	9	5	7	5	9	6	3
	INCLINE	5	6	6	8	8	10	10	8	6	3
P80	SPEED	2	5	7	6	11	10	6	5	4	3
	INCLINE	3	6	5	5	3	3	2	4	5	2
P81	SPEED	1	1	3	3	2	5	4	3	1	1
	INCLINE	2	5	5	6	4	4	6	6	3	2
P82	SPEED	3	4	6	4	2	2	6	3	4	3
	INCLINE	5	5	8	8	9	4	4	4	4	0
P83	SPEED	3	4	7	5	7	2	6	4	4	3
	INCLINE	2	4	4	6	6	0	0	2	1	0
P84	SPEED	3	3	3	5	7	5	7	6	2	2
	INCLINE	3	3	5	1	2	2	2	2	2	0
P85	SPEED	2	2	4	3	3	3	4	4	2	2
	INCLINE	0	2	2	3	3	3	1	1	1	0
P86	SPEED	1	3	4	3	3	4	5	5	3	2
	INCLINE	5	5	10	9	9	4	4	4	4	0
P87	SPEED	3	4	6	9	9	9	9	6	2	1
	INCLINE	5	5	7	9	9	4	4	4	4	0
P88	SPEED	3	4	5	5	5	5	7	7	3	3
	INCLINE	2	3	3	6	6	0	0	2	1	0

P89	SPEED	2	4	4	5	5	4	7	7	3	2
	INCLINE	3	3	2	1	2	2	2	2	2	0
P90	SPEED	2	4	9	9	10	8	6	4	4	3
	INCLINE	2	3	3	5	5	4	4	4	4	0
P91	SPEED	2	4	6	8	8	3	8	9	12	2
	INCLINE	2	3	6	2	8	10	15	8	6	3
P92	SPEED	2	4	7	8	8	8	10	4	8	1
	INCLINE	3	6	5	5	4	6	8	14	5	2
P93	SPEED	2	2	8	9	8	8	10	7	8	1
	INCLINE	2	5	5	6	8	4	6	6	13	2
P94	SPEED	2	2	4	9	12	12	4	10	4	1
	INCLINE	5	5	9	8	9	4	4	4	4	0
P95	SPEED	1	2	3	4	5	6	7	8	4	2
	INCLINE	2	2	2	6	6	0	0	2	1	0
P96	SPEED	2	12	3	12	12	3	4	8	10	1
	INCLINE	3	3	6	1	2	2	2	2	2	0
P97	SPEED	2	4	2	8	2	12	2	4	8	1
	INCLINE	0	2	2	3	3	3	1	1	1	0
P98	SPEED	2	4	2	12	1	4	12	6	10	1
	INCLINE	5	5	10	9	9	4	4	4	4	0
P99	SPEED	2	4	2	12	8	4	12	6	10	1
	INCLINE	5	5	8	9	9	4	4	4	4	0

4.5. Heart Rate:

When holding the hand pulse with two hands, the pulse window will show your heart rate after 5 seconds. To increase accuracy please check heart rate with the machine stopped and after keeping your hands on the sensors for more than 30 seconds.

The heart rate data is for reference purposes ONLY and should not be used for medical purposes.

4.6. Sleep Function:

The treadmill automatically enters sleep mode after 10 minutes of inactivity. Press any key on the display to wake the treadmill.

4.7. Safety Key Function:

Disconnecting the safety key will result in the treadmill beeping 3 times and stopping the current workout.

4.8. USB and AUX Connection:

Connect the AUX cable with your audio device to playback audio through the speakers. Audio playback can also be achieved by connecting a USB memory stick with music files via the USB input.

4.9. Speakers:

Please do not over increase the volume as doing so for extended periods of time may affect the quality of sound and circuit connections.

4.10. Data display and set range:

	RANGE	DEFAULT MODE	DEFAULT PROGRAM	SET RANGE
Time (min:sec)	0:00	15:00	5:00-99:00	0:00—99:59
Incline (levels)	0	0	0-19	0-19
Speed (km/h)	1.0	1.0	1.0-22	1.0-22
Distance (km)	0	1.00	0.50-99.9	0.00—99.9
Pulse (beats/min)	P	N/A	N/A	50-200
Calories (kilocalories)	0	50.0	10.0-999	0—999

4.11. Body Fat Test Function

1. Press the “PROGRAM” button under ready condition until the letters “FAT” show in the speed window. “FAT” is body fat test mode.
2. Press the “MODE” button to input data into parameters “SEX / AGE / HEIGHT / WEIGHT”. The “TIME/DIST” window will show “-1-”, “-2-”, “-3-”, “-4-“, which corresponds to “SEX / AGE / HEIGHT / WEIGHT” respectively. 01 is MALE, whilst 02 is FEMALE.
3. When setting each parameter, press SPEED ▲/▼ to adjust the data, and CAL/PULSE window will show the data. Press the “MODE” button to finish, and the window will show“-5-” and “-” then it will enter into ready condition. Hold the hand pulse sensors with both hands and it will show your BMI data after 5 seconds.

F-1	Seg	01MALE	02FEMALE
F-2	Age	10-----99	
F-3	Height	100----200	
F-4	Weight	20-----150	
F-5	FAT	≤19	Underweight
	FAT	=(20---25)	Normal weight
	FAT	=(25---29)	Overweight
	FAT	≥30	Obese

7. EXERCISE GUIDE

PLEASE NOTE: Before beginning any exercise program, consult your physician. This is important especially if you are over the age of 45 or individuals with pre-existing health problems.

The pulse sensors are not medical devices. Various factors, including the user's movement, may affect the accuracy of heart rate readings. The pulse sensors are intended only as an exercise aid in determining heart rate trends in general.

Exercising is great way to control your weight, improving your fitness and reduce the effect of aging and stress. The key to success is to make exercise a regular and enjoyable part of your everyday life.

The condition of your heart and lungs and how efficient they are in delivering oxygen via your blood to your muscles is an important factor to your fitness. Your muscles use this oxygen to provide enough energy for daily activity. This is called aerobic activity. When you are fit, your heart will not have to work so hard. It will pump a lot fewer times per minute, reducing the wear and tear of your heart.

So as you can see, the fitter you are, the healthier and greater you will feel.

Warm-up

Start each workout with 5 to 10 minutes of stretching and some light exercises. A proper warm-up increases your body temperature, heart rate and circulation in preparation for exercise. Ease into your exercise.

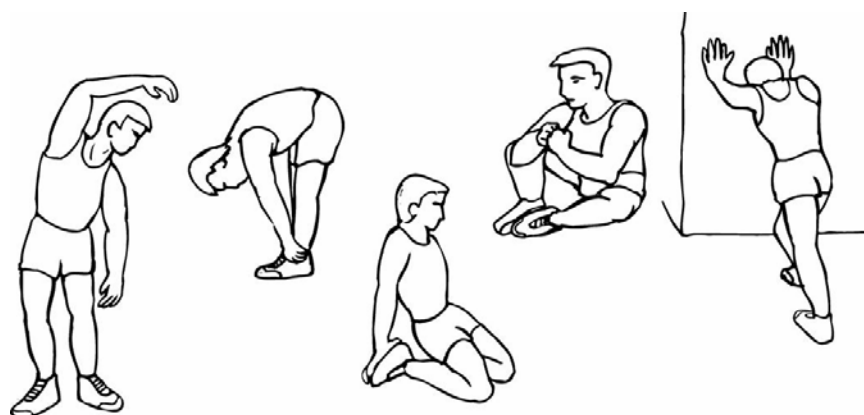

Training Zone Exercise

After warming up, increase the intensity to your desired exercise program. Be sure to maintain your intensity for maximum performance. Breathe regularly and deeply as you exercise-never hold your breath.

Cool Down

Finish each workout with a light jog or walk for at least 1 minute. Then complete 5 to 10 minutes of stretching to cool down. This will increase the flexibility of your muscles and will help prevent post-exercise problems.

Workout Guidelines

TARGET ZONE

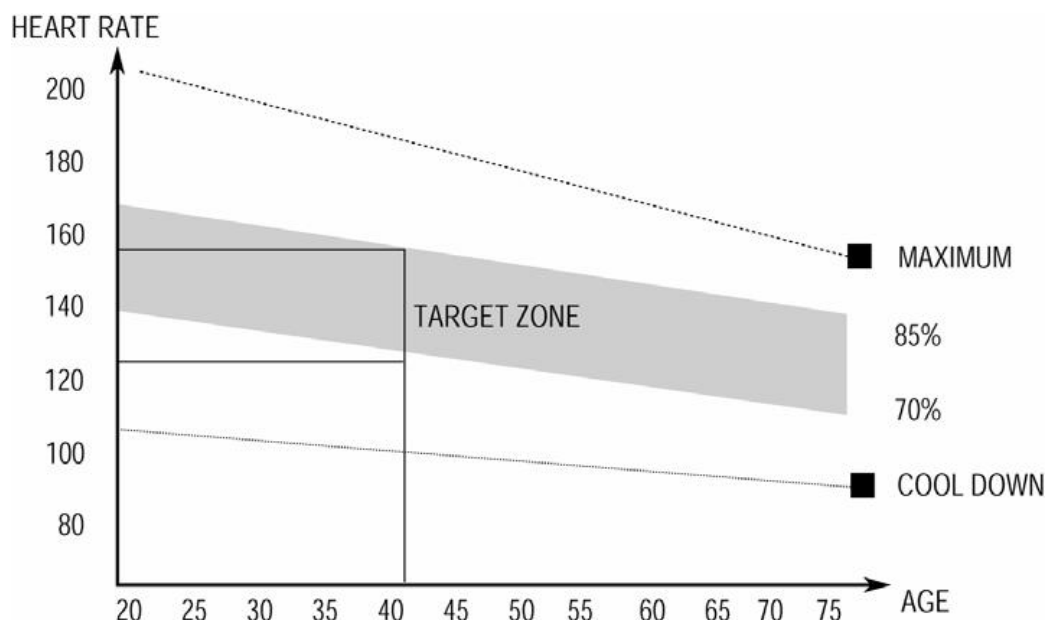

THIS IS HOW YOUR PULSE SHOULD BEHAVE DURING GENERAL FITNESS EXERCISE.

REMEMBER TO WARM UP AND COOL DOWN FOR A FEW MINUTES.

The most important factor here is the amount of effort you put in. The harder and longer you work, the more calories you will burn. Effectively this is the same as if you were training to improve your fitness, the difference is the goal.

8. MAINTENANCE INSTRUCTIONS

Reasonable cleaning/lubricating should be made to extend the life time of this unit. Performance is maximized when the belt and mat are kept as clean as possible.

WARNING: THE MAT/DECK FRICTION MAY PLAY A MAJOR ROLE IN THE FUNCTION AND LIFE OF YOUR TREADMILL AND THAT IS WHY WE RECOMMEND YOU CONSTANTLY LUBRICATE THIS FRICTION POINT TO PROLONG THE USEFUL LIFE OF YOUR TREADMILL. FAILING TO DO THIS MAY VOID YOUR WARRANTY.

WARNING: UNPLUG POWER CORD BEFORE MAINTENANCE

WARNING: STOP TREADMILL BEFORE FOLDING

1. General Cleaning

- Use a soft, damp cloth to wipe the edge of the belt and the area between the belt edge and frame. A mild soap and water solution along with a nylon scrub brush will clean the top of the textured belt. This task should be done once a month. Allow to dry before using.
- On a monthly basis, vacuum underneath your treadmill to prevent dust build up. Once a year, you should remove the black motor shield and vacuum out dirt that may accumulate.

2. General Care

- Check parts for wear before use.
- Pay particular attention to the fixing knobs and make sure they are tight.
- Always replace the mat if worn and any other defective parts.

- If in doubt do not use the treadmill and contact us.

TAKE CARE TO PROTECT CARPETS AND FLOOR in case of leakages. This product is a machine that contains moving parts which have been greased / lubricated and could leak.

3. Belt/Deck/Roller Lubrication

The mat/deck friction may play a major role in the function and life of your treadmill and that is why we recommend you constantly lubricate this friction point to prolong the useful life of your treadmill. You should apply lubrication after approximately the first 30 hours of operation. We recommend lubrication of the deck according to the following timetable:

- Light use (less than 3 hours per week) every 6 months
- Medium use (3-5 hours a week) every 3 months
- Heavy use (more than 5 hours per week) every 6-8 weeks

See below procedures for lubricating:

1. Use a soft, dry cloth to wipe the area between the belt and deck.
2. Spread lubricant onto the inside surface of belt and deck evenly (make sure the machine is turned off and power is disconnected).

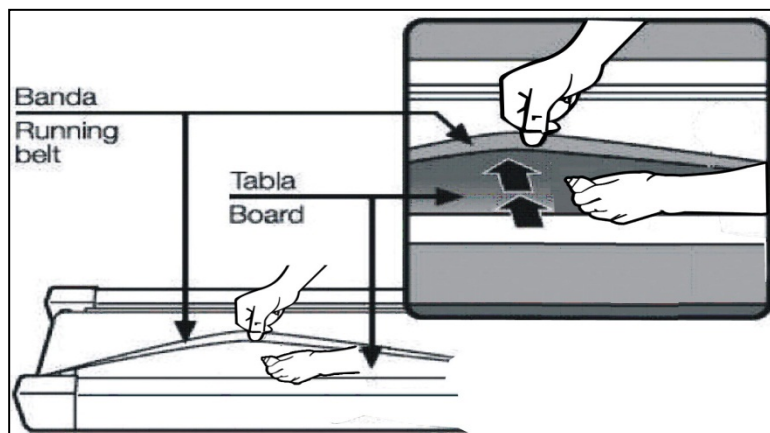

3. Periodically lubricate the front and rear rollers to keep them at their peak performance. If the treadmill belt/deck/roller is kept reasonably clean it is possible to expect over 1200 hours before relubricating is necessary.

Video Tutorial Available at:
<http://youtu.be/cP9NtFHfWlc>

Lifespan Fitness Channel:
<http://www.youtube.com/user/treadmillsvideos>

4. How to check the running mat for proper lubrication:

1. Disconnect the main power supply.
2. Fold the treadmill up into the storage position.
3. Feel the underside surface of the running mat.

If the surface is slick when touched, then no further lubrication is needed.

If the surface is dry to the touch, apply a suitable silicone lubricant.

We recommend that you use a silicone based spray to lubricate your Lifespan treadmill. This can be purchased directly from us or any hardware store.

5. Adjusting the Running Belt

Place treadmill on a level surface. Run treadmill at approximately 4km/h, checking the running condition.

If the belt has drifted to the **right**:

Whilst the treadmill is running at 4km/h, carefully turn the **right** adjusting bolt 1/4 turn **clockwise**. Then monitor treadmill until the belt centers. Repeat until the belt correctly centers.

See *Picture A*

If you have over adjusted the belt and it drifts to the right, carefully turn the **right** adjusting bolt **anticlockwise** until the belt centers.

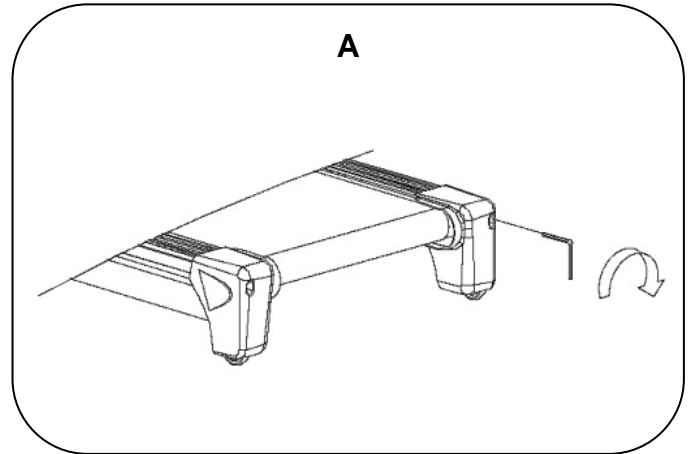

If the belt has drifted to the **left**:

Whilst the treadmill is running at 4km/h, carefully turn the **left** adjusting bolt 1/4 turn **clockwise**. Then monitor treadmill until the belt centers. Repeat until the belt correctly centers.

See *Picture B*

If you have over adjusted it, carefully turn the **left** adjusting bolt **anticlockwise** and until the belt centers.

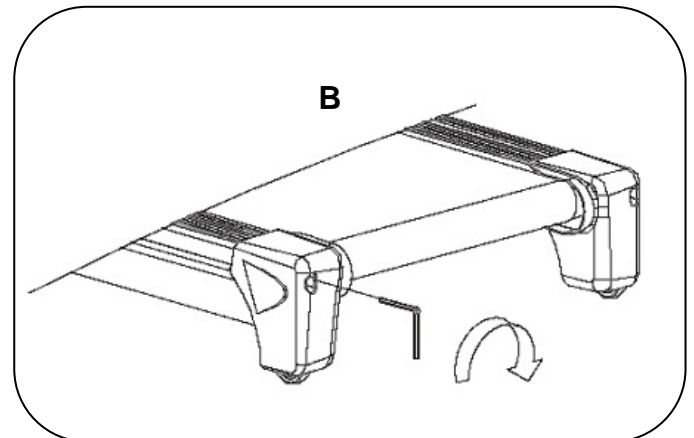

To adjust the **tightness** of the belt:

Turn the treadmill off. Turn both the left and right adjusting bolts 1/4 turn clockwise. Repeat until the belt correctly tightens.

See *Picture C*

If the belt is over tightened, simply do the opposite to loosen.

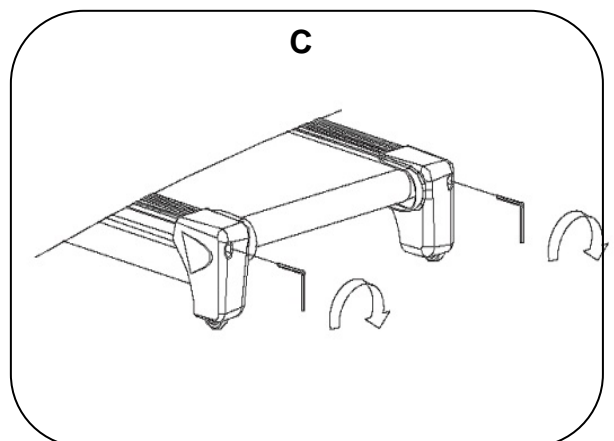

NOTE: When properly tightened, you should be able to peel the very edge of the side of the belt up approximately 2 inches. However this is a rough reference and not all treadmills are the same. Some treadmills that have longer belts may give different measurements for correct belt tightness.

Simply, if the belt begins to slip during use, this is an indication that the belt still needs tightening.

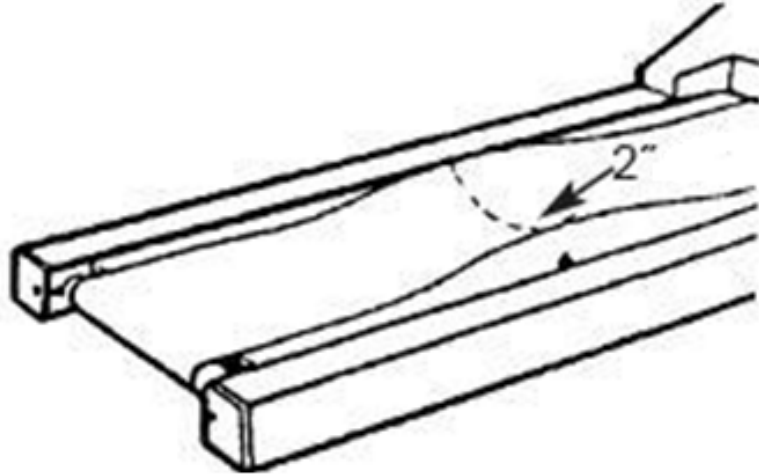

Video Tutorial Available at:
<http://youtu.be/vllsamTSvVA>

Lifespan Fitness Channel:
<http://www.youtube.com/user/treadmillsvideos>

9. TROUBLESHOOTING

CODE	REASON	SOLUTION
E01	Connection failure between computer and bottom control board	<ol style="list-style-type: none"> 1. Check the computer and bottom control board wire connection 2. Check if IC on bottom control board is loose, reset the IC 3. Power on bottom control board. If it is faulty change the bottom control board
E02	Burst clash	<ol style="list-style-type: none"> 1. Check that the correct power is being used. If not, use correct power to test 2. Check if the bottom control has been burnt out. If so replace and reconnect the motor wire.
E05	Current overload protecting	<ol style="list-style-type: none"> 1. The machine is overloaded or the motor is stuck, causing excessive current. When this occurs the machine will start damage protection measure. Adjust the machine and restart. 2. Check if the machine is emitting noise from the motor or if the motor or bottom control board is burnt out. If burnt out replace motor or bottom control. Remember to use correct voltage.
E08	EEPROM with problem	Change the bottom control board

10. EXPLODED DIAGRAM

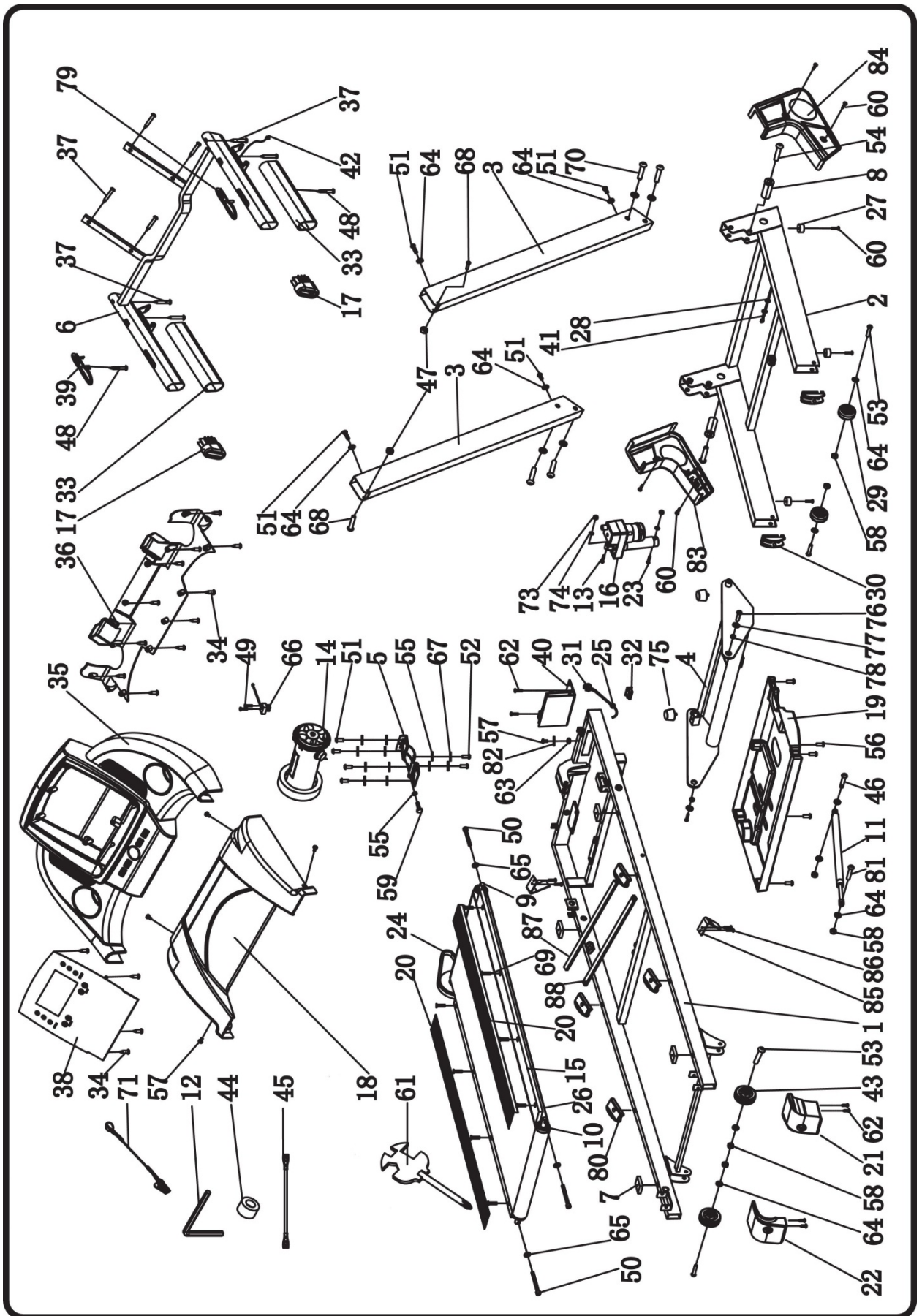

11. PARTS LIST

NO.	DESCRIPTION	SPEC.	QTY	NO.	DESCRIPTION	SPEC.	QTY
1	Main Frame		1	45	blue single wire		1
2	Base Frame		1	46	Bolt	M8*25	1
3	Upright bracket		2	47	Lock Nut	M6	2
4	Incline frame		1	48	Screw	ST4.2*28	2
5	Motor Bracket		1	49	Screw	ST2.9*6.5	2
6	Computer Bracket		1	50	Bolt	M6*65	3
7	Rubber pad		4	51	Bolt	M8*16	8
8	Turning casing		2	52	Bolt	M8*12	2
9	Front Roller		1	53	Bolt	M8*40	4
10	Back Roller		1	54	Bolt	M10*60	2
11	Cylinder		1	55	Flat Washer	8	7
12	5#Allen Wrench	5mm	1	56	Screw	ST4.2*12	5
13	Bolt	M10*42	1	57	Bolt	M5*8	5
14	DC Motor		1	58	Lock Nut	M8	6
15	Running Board		1	59	Bolt	M8*25	1
16	Incline motor		1	60	Screw	ST4.2*19	8
17	Circle end cap		2	61	Curved washer	S=13、14、15	4
18	Motor Up Cover		1	62	Screw	ST4.2*19	6
19	Motor Bottom Cover		1	63	Lock washer	5	1
20	Side Rail		2	64	Lock washer	8	14
21	Right Back End Cover		1	65	Lock Washer	6	3
22	Left Back End Cover		1	66	inductor		1
23	Bolt	M10*55	1	67	spring washer	8	6
24	Motor Belt		1	68	Bolt	M6*27	2
25	Power Wire Buckle		1	69	Bolt	M6*35	8
26	Running Belt		1	70	Bolt	M8*45	4
27	Foot pad		4	71	Safety Key		1
28	ring wire plug B		2				
29	Transport Wheel		2	73	Lock Nut	M10	2
30	Moving wheel cover		2	74	Lock washer	10	2
31	Power Wire		1	75	Tapered cushion		2
32	Switch		1	76	Bolt	M10*20	2
33	Foam		2	77	Flat washer	10	2
34	Screw	ST4.2*13	17	78	Tube		2
35	Computer up cover		1	79	Hand pulse with speed		1
36	Computer bottom cover		1	80	Elastic cushion		4
37	Screw	ST4.2*20	8	81	Bolt	M8*42	1
38	Computer		1	82	Spring Washer	5	1
39	Hand pulse with incline		1	83	Left back cover		1
40	Control Board		1	84	Right back cover		1
41	Computer Bottom Wire		1	85	Hook		2

42	Computer Up Wire	1	86	Conduction band Bolt	ST4.2*12	4
43	Adjust roller	2	87	EVA Cusion	450*20*7	1
44	Magnetic Ring	1	88	Running Board Strengthen Tube		1

12. WARRANTY

AUSTRALIAN CONSUMER LAW

Many of our products come with a guarantee or warranty from the manufacturer. In addition, they come with guarantees that cannot be excluded under the Australian Consumer Law. You are entitled to a replacement or refund for a major failure and compensation for any other reasonably foreseeable loss or damage.

You are entitled to have the goods repaired or replaced if the goods fail to be of acceptable quality and the failure does not amount to a major failure. Full details of your consumer rights may be found at www.consumerlaw.gov.au

Please visit our website to view our full warranty terms and conditions:

<http://www.lifespanonline.com.au/Warranty-Policy>

Please email us through support@lifespanfitness.com.au for all warranty or support issues.